

THE CLEVELAND-CLIFFS IRON COMPANY
Land Department

MUNISING HOUSE AND LOT SALES RECEIVABLE -- DECEMBER 31, 1941

Conv. No.	Purchaser	Date of Sale	Consideration	Terms	Date of Last Payment	B A L A N C E D U E				Interest Paid to	Remarks
						Principal	Taxes	Insurance Prem.	Total		
5445	Albert J. and Violet J. Cota	May 17, 1934	\$2,300.00	\$20.00 cash. Bal. \$20.00 monthly.	10/10/41	\$1,613.43			\$1,613.43	9/19/41 (Approx.)	Somewhat in arrears but has promised to make larger payments in 1942. Alger County employe.
6469	John D. Lamont and wife	Mar. 1, 1939	4,500.00	\$35.00 cash, \$35.00 monthly for 11 consecutive months beginning 4/1/39. Bal. \$50.00 monthly.	12/ 4/41	3,663.41			3,663.41	12/1/41	Up to date.
						\$5,276.84			\$5,276.84		

Typed by
HW-6
2/19/42

THE CLEVELAND-CLIFFS IRON COMPANY
Land Department

LOT SALES RECEIVABLE -- DECEMBER 31, 1941

Conv. No.	Purchaser	Date of Sale	Consideration	Terms	Date of Last Paym.	B A L A N C E D U E			Interest Paid to	Remarks
						Principal	Taxes	Insurance		
7196	Bernard A. Wayer and wife	Sept. 26, 1941	\$2,750.00	\$500.00 cash. Bal. in 3 years.	9/27/41	\$2,250.00			\$2,250.00	Up to date.
6559	Vernon Richmond	July 1, 1939	2,500.00	\$500.00 cash. Bal. in 4 years.	6/30/41	1,000.00			1,000.00	7/ 1/41 do.
7164	E. B. Anthony	Aug. 22, 1941	700.00	\$200.00 cash. Bal. in 4 years.	8/23/41	500.00			500.00	"
6726	Eli Lampi	May 1, 1940	900.00	\$200.00 cash. Bal. in 4 years.	9/ 6/41	625.00			625.00	8/ 1/41 "
6613	Helgard B. Lundbom	Oct. 23, 1939	100.00	\$5.00 cash. Bal. in monthly install- ments of \$5.00 each.	12/31/41	37.50			37.50	"
6364	Helgard B. Lundbom	Aug. 1, 1938	200.00	\$5.00 cash. Bal. \$5.00 a month.	12/ 9/41	2.50			2.50	"
6365	Lloyd Cook	Aug. 1, 1938	200.00	do.	12/29/41	47.50			47.50	"
6391	Warren J. Wendt	Sept. 20, 1938	200.00	"	12/27/41	1.36			1.36	9/25/41 "
6519	Albert L. Raymond & wife	May 13, 1939	200.00	\$10.00 cash. Bal. \$5.00 a month.	12/ 9/41	55.00			55.00	5/ 1/41 "
6567	Clifford Johns	Aug. 1, 1939	200.00	\$5.00 cash. Bal. \$5.00 a month.	12/11/41	50.00			50.00	"
6366	Clifford Johns	Aug. 1, 1938	200.00	do.	12/11/41	5.00			5.00	"
6820	Anne B. Frasier	June 17, 1940	125.00	\$35.00 cash. Bal. in 2 years.	7/11/41	45.00			45.00	6/ 1/41 "
7127	Anne B. Frasier	June 17, 1941	125.00	do.	6/16/41	90.00			90.00	"
7232	Caywood T. Taylor	Dec. 2, 1941	660.00	\$300.00 cash. Bal. in one year.	12/ 2/41	360.00			360.00	"
7156	Claude B. Pangborn	Aug. 11, 1941	475.00	\$75.00 cash. Bal. in 4 years.	8/12/41	400.00			400.00	"
6824	Peter Milchuck	July 20, 1940	300.00	\$75.00 cash. Bal. in 3 years.	7/11/41	150.00			150.00	7/20/41 "
6823	Donald Montcalm	July 20, 1940	300.00	do.	10/ 4/41	150.00			150.00	7/20/41 "
7204	Wayne Johnston	Oct. 17, 1941	425.00	\$85.00 cash. Bal. in 4 years.	11/ 3/41	234.60			234.60	"
7210	Stanley J. Cousineau	Oct. 28, 1941	400.00	\$80.00 cash. Bal. in 4 years.	10/28/41	320.00			320.00	"
6244	Evan Vercellino	Nov. 27, 1937	200.00	\$40.00 cash. Bal. in 4 years.		-			-	
6245	John Duca	Nov. 27, 1937	540.00	\$90.00 cash. Bal. in 5 years.	1/ 8/41	180.00			180.00	11/27/40 Paid \$100.80 in January, 1942. Up to date.
6291	John Duca	Mar. 29, 1938	300.00	\$50.00 cash. Bal. in 5 years.	6/19/41	100.00			100.00	3/29/41 Up to date.
						\$6,593.46			\$6,593.46	

Typed by
HW - 6
2/19/42

THE CLEVELAND-CLIFFS IRON COMPANY
Land Department

NEGAUNEE HOUSE SALES RECEIVABLE -- DECEMBER 31, 1941

Conv. No.	Purchaser	Date of Sale	Consideration	Terms	Date of Last Payment	B A L A N C E D U E			Interest Paid to	Remarks	
						Principal	Taxes	Insurance			
5189	William H. Treloar and wife	Nov. 1, 1932	\$1,400.00	\$140.00 cash. Bal. \$14.00 monthly.	Dec. 10, 1941	\$ 364.91			\$ 364.91	12/ 1/41	Up to date.
5190	Arthur H. Pascoe and wife	Dec. 1, 1932	1,500.00	\$150.00 " " \$15.00 "	Nov. 27, 1941	185.75			185.75	11/ 1/41	Up to date.
5192	Richard H. Burrows and wife	Dec. 1, 1932	1,500.00	\$150.00 " " \$15.00 "	Nov. 27, 1941	186.15			186.15	11/ 1/41	Up to date.
5168	Leo Dodendorf and wife	Dec. 1, 1932	2,800.00	\$280.00 " " \$28.00 "	Dec. 27, 1941	1,445.20			1,445.20	1/ 1/42	Company employe.
5202	Arthur Olson	Jan. 2, 1933	2,000.00	\$200.00 " " \$20.00 "	Dec. 27, 1941	229.52			229.52	1/ 1/42	Up to date.
5421	Edgar R. Staples and wife	Mar. 19, 1934	1,800.00	\$180.00 " " \$18.00 "	Nov. 27, 1941	666.90			666.90	9/18/41	Company employe. Pay roll collection.
5441	J. William Larson and wife	May 1, 1934	1,650.00	\$165.00 " " \$16.50 "	Nov. 28, 1941	442.01			442.01	12/ 1/41	Up to date.
5446	Andrew Kangas and wife	May 1, 1934	2,200.00	\$220.00 " " \$22.00 "	Dec. 10, 1941	710.54	\$.40		710.24	11/ 1/41	Up to date. Pay roll collection.
5462	Leonard T. and Helmi Parkonen	June 15, 1934	1,500.00	\$150.00 " " \$15.00 "	Dec., 1941	458.40	1.87		460.27	Ins. to 5/4/42	Up to date. Pay roll collection. Ins. collected in Jan., 1942.
5510	Arne O. Mantala	Sept. 10, 1934	1,500.00	\$150.00 " " \$15.00 "	Dec., 1941	537.05			537.05	9/ 1/41	Up to date. Pay roll collection.
5638	Henry Hyvonen and wife	Apr. 1, 1935	1,500.00	\$150.00 " " \$15.00 "	Dec., 1941	603.53			603.53	10/ 1/41	Up to date. Pay roll collection.
5653	Victor S. Luoma Estate	June 1, 1935	1,400.00	\$80.00 cash, \$30.00 monthly for ten months. Bal. \$14.00 monthly.	Dec., 1941	598.82			598.82	1/ 1/42	Up to date. Pay roll collection.
5927	Toivo Savolainen	June 15, 1936	2,100.00	\$210.00 cash. Bal. \$21.00 monthly.	Dec., 1941	1,119.10			1,119.10	12/ 1/41	Up to date. Pay roll collection.
5963	Henry Bean and wife	Aug. 1, 1936	2,000.00	\$200.00 " " \$20.00 "	Dec., 1941	1,250.67			1,250.67	12/ 1/41	Up to date. Pay roll collection.
5988	Joseph P. Skues and wife	Oct. 1, 1936	3,000.00	\$300.00 " " \$30.00 "	Nov. 27, 1941	1,503.95			1,503.95	12/ 1/41	Up to date.
6122	Raymond Langlois	June 1, 1937	2,100.00	\$210.00 " " \$21.00 "	Dec., 1941	1,286.61			1,286.61	12/ 1/41	Up to date. Pay roll collection.
6123	Jalmer Salo	June 1, 1937	3,000.00	\$300.00 " " \$30.00 "	Dec., 1941	1,870.04			1,870.04	12/ 1/41	Up to date. Pay roll collection.
6145	Lawrence Nylander	July 15, 1937	2,000.00	\$200.00 " " \$20.00 "	Dec., 1941	1,252.01			1,252.01	11/ 1/41	Up to date. Pay roll collection.
6218	Omie E. Rantanen	Nov. 1, 1937	1,800.00	\$180.00 " " \$18.00 "	Dec., 1941	1,148.04			1,148.04	12/ 1/41	Up to date. Pay roll collection.
6263	John A. Roberts and wife	Jan. 1, 1938	1,800.00	\$180.00 " " \$18.00 "	Dec., 1941	1,176.74			1,176.74	11/ 1/41	Up to date. Pay roll collection.
6307	Wilfred Lyons and wife	May 2, 1938	1,000.00	\$100.00 " " \$10.00 "	Dec. 1, 1941	636.68			636.68	12/ 1/41	Up to date.
6563	Nick Taseris	July 15, 1939	2,200.00	\$220.00 " " \$22.00 "	Dec., 1941	1,638.13			1,638.13	12/15/41	Up to date. Pay roll collection.
6691	Alex A. Thle and wife	Apr. 1, 1940	2,250.00	\$1000.00 " " \$22.50 "	Dec. 24, 1941	501.93			501.93	1/ 1/42	Up to date.
6692	William J. Waters and wife	Apr. 1, 1940	1,800.00	\$180.00 " " \$18.00 "	Nov. 27, 1941	1,412.22			1,412.22	12/ 1/41	Up to date.
6695	Henry Houseman and wife	Apr. 1, 1940	3,300.00	\$330.00 " " \$33.00 "	Dec., 1941	1,188.12			1,188.12	12/1/ 41	Up to date. Pay roll collection.
6698	Jacob Annala and wife	Apr. 1, 1940	2,700.00	\$270.00 " " \$27.00 "	Dec., 1941	2,101.96			2,101.96	1/ 1/42	Up to date. Pay roll collection.
6699	Harold Leaf and wife	Apr. 1, 1940	2,250.00	\$225.00 " " \$22.50 "	Dec., 1941	1,765.30			1,765.30	12/ 1/41	Up to date. Pay roll collection.
6703	Alex J. Marotte and wife	Apr. 1, 1940	1,700.00	\$170.00 " " \$17.00 "	Dec., 1941	1,323.44			1,323.44	1/ 1/42	Up to date. Pay roll collection.
6707	Edward J. Young and wife	Apr. 1, 1940	3,000.00	\$300.00 " " \$30.00 "	Dec. 27, 1941	2,335.50			2,335.50	11/ 1/42	Up to date.

NEGAUNEE HOUSE SALES RECEIVABLE--DECEMBER 31, 1941

Sheet 2

Conv. No.	Purchaser	Date of Sale	Consideration	Terms	Date of Last Payment	BALANCE		DUE		Interest Paid to	Remarks
						Principal	Taxes	Insurance	Total		
6714	C. Leander Johnson and wife	Apr. 1, 1940	\$2,400.00	\$240.00 cash. Bal. \$24.00 monthly.	Nov. 27, 1941	\$1,883.01			\$1,883.01	12/ 1/41	Up to date.
6717	Jaak Hytinen	May 1, 1940	2,625.00	\$262.50 " " \$26.25 "	Dec., 1941	2,076.85			2,076.85	12/ 1/41	Up to date. Pay roll collection.
6723	Benjamin Jewell	May 1, 1940	3,200.00	\$320.00 " " \$32.00 "	Dec., 1941	2,530.03			2,530.03	12/ 1/41	Up to date. Pay roll collection.
6745	William J. Phillips	June 1, 1940	2,400.00	\$240.00 " " \$24.00 "	Dec., 1941	1,911.90			1,911.90	12/ 1/41	Up to date. Pay roll collection.
6755	William Hooper and wife	June 1, 1940	3,500.00	\$350.00 " " \$35.00 "	Dec., 1941	2,788.29			2,788.29	12/ 1/41	Up to date. Pay roll collection.
6757	Charles M. Roseveare and wife	June 1, 1940	2,500.00	\$250.00 " " \$25.00 "	Dec. 11, 1941	1,991.63			1,991.63	12/ 1/41	Up to date.
6761	Elmer J. Lindstrom	July 1, 1940	2,400.00	\$240.00 " " \$24.00 "	Dec., 1941	1,925.82			1,925.82	1/ 1/42	Up to date. Pay roll collection.
6790	Ragner J. Sundberg	July 1, 1940	1,800.00	\$180.00 " " \$18.00 "	Dec., 1941	1,433.95			1,433.95	1/ 1/42	Up to date. Pay roll collection.
6790 1/2	John L. Peel	July 1, 1940	2,400.00	\$1000.00 " " \$15.00 "	Dec., 1941	1,249.93			1,249.93	1/ 1/42	Up to date. Pay roll collection.
6800	Adolph Anderson	July 1, 1940	2,000.00	\$200.00 " " \$20.00 "	Dec., 1941	1,605.14			1,605.14	12/ 1/41	Up to date. Pay roll collection.
6819	Francis G. Phillips	July 1, 1940	2,600.00	\$260.00 " " \$26.00 "	Dec., 1941	2,086.84			2,086.84	12/ 1/41	Up to date. Pay roll collection.
6824	W. G. Lohholz and wife	Aug. 1, 1940	3,750.00	\$375.00 " " \$37.50 "	Dec. 23, 1941	3,054.53	\$ 25.10	\$18.60	3,098.23	11/ 1/41	Company employe. Two payments in arrears, also insurance and taxes.
6852	John Warmstrom and wife	Aug. 1, 1940	2,850.00	\$285.00 " " \$28.50 "	Dec., 1941	2,321.56			2,321.56	11/ 1/41	Up to date. Pay roll collection.
6858	Henry A. Johnson	Aug. 1, 1940	2,250.00	\$225.00 " " \$22.50 "	Dec., 1941	1,832.64			1,832.64	11/ 1/41	Up to date. Pay roll collection.
6890	Turri R. Lindstrom	Sept. 2, 1940	2,100.00	\$210.00 " " \$21.00 "	Dec. 15, 1941	1,710.45			1,710.45	12/ 1/41	Up to date.
6894	George R. Preston	Oct. 1, 1940	2,000.00	\$200.00 " " \$20.00 "	Dec., 1941	1,652.56			1,652.56	11/ 1/41	Up to date. Pay roll collection.
6892	Reuben E. Carlson	Oct. 1, 1940	2,250.00	\$225.00 " " \$22.50 "	Dec., 1941	1,832.66			1,832.66	1/ 1/42	Up to date. Pay roll collection.
6936	Meynell A. Voegtline	Oct. 1, 1940	3,900.00	\$390.00 " " \$39.00 "	Dec., 1941	3,199.82			3,199.82	12/ 1/41	Up to date. Pay roll collection.
6976	Gordon Chapman	Oct. 1, 1940	2,850.00	\$285.00 " " \$28.50 "	Dec., 1941	2,338.18			2,338.18	12/ 1/41	Up to date. Pay roll collection.
7007	Charles W. Johnson	Nov. 1, 1940	2,625.00	\$262.50 " " \$26.25 "	Dec., 1941	2,169.01			2,169.01	12/ 1/41	Up to date. Pay roll collection.
7063	Angelo C. Rnehatt	May 1, 1941	2,550.00	\$255.00 " " \$25.50 "	Dec. 1, 1941	2,169.03	26.63		2,195.66	12/ 1/41	Up to date. Pay roll collection. 1941 taxes paid in January, 1942.
7086	John V. Maunila	May 1, 1941	3,200.00	\$320.00 " " \$32.00 "	Dec., 1941	2,809.06	40.27		2,849.33	9/ 1/41	Company employe. A few payments in arrears. 1941 taxes pd.in Jan. '42.
7090	George Kokko and wife	May 1, 1941	3,000.00	\$300.00 " " \$30.00 "	Dec., 1941	2,562.72	33.58		2,616.30	12/ 1/41	Up to date. Pay roll collection. 1941 taxes paid in January, 1942.
7102	Herbert E. Nelson	June 2, 1941	2,750.00	\$275.00 " " \$27.50 "	Dec., 1941	2,367.49	33.26		2,400.75	1/ 1/42	Up to date. Pay roll collection. 1941 taxes paid in January, 1942.
7105	John Harman	June 2, 1941	1,950.00	\$195.00 " " \$20.00 "	Dec., 1941	1,675.80	27.40		1,702.60	1/ 1/42	Up to date. Pay roll collection. 1941 taxes paid in January, 1942.
7107	Carl W. Saari	June 2, 1941	3,000.00	\$300.00 " " \$30.00 "	Dec., 1941	2,616.54	17.61		2,634.15	1/ 1/42	Up to date. Pay roll collection. 1941 taxes paid in January, 1942.
7109	Joseph A. Holman	June 2, 1941	2,550.00	\$255.00 " " \$25.50 "	Dec., 1941	2,209.72	27.40		2,237.12	12/ 1/41	Up to date. Pay roll collection. 1941 taxes paid in January, 1942.
7110	Charles Saari	June 2, 1941	2,550.00	\$255.00 " " \$25.50 "	Dec., 1941	2,195.31	33.26		2,228.57	1/ 1/42	Up to date. Pay roll collection. Taxes will be paid in 1942.
7122	Leonard T. Perry and George E. Freeman	June 2, 1941	2,650.00	\$265.00 " " \$26.50 "	Dec., 1941	2,469.84	31.31		2,500.95	12/ 1/41	Up to date. Pay roll collection. Taxes will be paid in 1942.
7123	Jack Aho	June 2, 1941	4,050.00	\$405.00 " " \$40.50 "	Dec., 1941	3,509.64	37.18		3,546.82	12/ 1/41	Up to date. Pay roll collection. 1941 taxes paid in January, 1942.
7145	Clarence T. Verran	July 1, 1941	2,800.00	\$280.00 " " \$28.00 "	Dec., 1941	2,426.41	30.19		2,456.60	1/ 1/42	Up to date. Pay roll collection. 1941 taxes paid in January, 1942.
71 50	Arthur and Martin Kantola	Aug. 1, 1941	3,450.00	\$345.00 " " \$34.50 "	Dec., 1941	3,045.78	22.36		3,068.14	12/ 1/41	Up to date. Pay roll collection. 1/2 1941 taxes paid in Jan., 1942.
7158	Joseph Holman	Sept. 1, 1941	2,850.00	\$285.00 " " \$28.50 "	Dec., 1941	2,233.46	15.66		2,249.12	1/ 1/42	Up to date. Pay roll collection. 1941 taxes paid in January, 1942.
7160	Clarence A. Pope	Sept. 1, 1941	2,800.00	\$280.00 " " \$28.00 "	Dec., 1941	2,465.68	17.89		2,483.57	1/ 1/42	Up to date. Pay roll collection. 1941 taxes paid in January, 1942.
7166	Charles C. Snyder and wife	Sept. 1, 1941	3,900.00	\$390.00 " " \$39.00 "	Dec., 1941	2,508.41	22.36		2,530.77	1/15/42	Up to date. Pay roll collection. 1941 taxes paid in January, 1942.
7172	Ward Lundwall and wife	Sept. 1, 1941	3,000.00	\$300.00 " " \$30.00 "	Dec., 1941	2,650.84	17.89		2,668.13	12/ 1/41	Up to date. Pay roll collection. 1941 taxes paid in January, 1942.
7181	Hilda N. Harvey	Sept. 1, 1941	4,800.00	\$480.00 " " \$48.00 "	Dec., 1941	3,710.34	26.83		3,737.17	12/ 1/41	Taxes will be paid in 1942.
7190	John Lenten	Oct. 1, 1941	3,500.00	\$350.00 " " \$35.00 "	Dec., 1941	2,935.60	13.42		2,947.02	12/ 1/41	Up to date. Pay roll collection. 1941 taxes paid in January, 1942.
7192	Ellsworth R. Chapman	Oct. 1, 1941	3,800.00	\$380.00 " " \$38.00 "	Dec., 1941	2,826.93	15.09		2,842.02	12/ 1/41	Up to date. Pay roll collection. 1941 taxes paid in January, 1942.
7193	Richard Uren	Oct. 1, 1941	2,700.00	\$270.00 " " \$27.00 "	Dec., 1941	2,400.22	7.55		2,407.77	12/ 1/41	Up to date. Pay roll collection. 1941 taxes paid in January, 1942.
						\$123,344.34	\$522.44	\$20.07	\$123,886.85		

Typed by HW
2/18/42

THE CLEVELAND-CLIFFS IRON COMPANY
Land Department

LAND PRODUCTS SALES RECEIVABLE -- DECEMBER 31, 1941

Misc. Doc. No.	Name	Amount Owing 12/31/41	Remarks
414	Advance Industrial Supply Co.	\$872.83	Dec., 1941 Shipments \$ 35.40) Bal. Due on Minimum)) Royalty 272.20) Paid in Jan., 1942. 1941 Taxes 565.23)

LED:HW-6
2/23/42

THE CLEVELAND-CLIFFS IRON COMPANY
Land Department

HOUSE RENTS RECEIVABLE -- DECEMBER 31, 1941.

House No.	Tenant	Monthly Rental	Amount Due to Dec. 31, 1941	Remarks
2a	Swan Lahti	\$ 7.50	\$ 7.50	Paid in January, 1942.
2b	Walter Cox	7.00	14.00	Paid \$7.00 in January, 1942.
101	John Wickstrom	12.40	-	Up to date.
102	Minnie Uren	7.00	-	do.
103	Charles Gyles	15.40	-	"
104A	Thomas Hosking	10.40	-	"
104B	Bert Pemberthy	10.40	20.40	Paid \$25.80 in January, 1942.
105	Ed. Mallett	14.40	19.40	Paid \$15.00 in January, 1942.
106A	Mrs. Helen S. Newman	10.40	10.40	Paid in January, 1942.
106B	Gust Sundberg	10.40	-	Up to date.
109	W. J. Williams	9.00	-	do.
115A	Fred Bath	12.40	-	"
115B	Lester Juchemich	12.40	-	"
115C	Oswald Zardus	15.40	-	"
117	John Marshall	4.75	4.75	Paid in January, 1942.
118	Jethro Collins	10.40	-	Up to date.
119	Richard Pascoe	11.50	-	do.
121	James Kent	8.00	-	"
122	Vego Anderson	8.50	-	"
123A	Dan Mathews	10.00	3.33	Paid in advance.
123B	Nick Reichel, Jr.	8.50	-	Up to date.
124	Wesley Jennings	8.50	-	do.
206	H. J. Theriault	20.00	-	"
207	Land Agent	25.00	-	"
208	Searle Bath	25.00	25.00	Company employe. Payroll deduction.
301A	Mrs. C. J. Light	30.00	-	Up to date.
301B	C. M. Schooley	20.00	-	do.
323	Rupp and Green Company	10.00	36.33	Paid in January, 1942.
325	Fred Carefelle	20.00	180.53	Monthly collections of \$10.00— L. S. & I. R.R. Co.

HOUSE RENTS RECEIVABLE → DECEMBER 31, 1941 (CONT'D)

House No.	Tenant	Monthly Rental	Amount Due to Dec. 31, 1941	Remarks
326E	Roy DeLisle	\$15.00	\$ 7.50	Paid in advance.
326E	L. S. Cady	12.00	208.58	Has promised to make substantial payments in 1942.
326W	H. R. Johnson	15.00	15.00	Paid in January, 1942.
327E	Theron Malone	15.00	39.50	Pay roll collection—Alger County Road Comm. \$22.50 paid in Jan. '42.
327W	Dale Burley	15.00	57.80	Pay roll collection—The Munising Paper Co. \$25.00 paid in Jan. '42.
328	Douglas Richards	18.00	36.00	Paid \$18.00 in January, 1942.
329W	Axel Wittlock	12.00	-	Up to date.
329E	Emil Lundbom	15.00	-	do.
330	Charles Parcels	18.00	-	"
330	Bert Chase	18.00	-	"
700	Vacant			
701	Vacant			
702	Nelson Goodreau	10.00	10.00	Paid in January, 1942.
703	J. Harold Wallis	8.00	8.00	do.
704	Vacant			
705	Vacant			
706	Vacant			
724	Fred C. Hyde	1.00	9.00	Will endeavor to collect in 1942.
725	Toivo Ihomaki	1.00	-	Up to date.
726	Alex Johnson	5.00	120.00	Company employe. Pay roll coll.
727	Charles Niemi	5.00	-	Up to date.
728	Mike Seppi	2.00	12.00	Expect to collect in 1942.
729	Vacant			
730	George Maki	1.00	1.00	Will be paid in 1942.
			\$824.36	

Typed by HW-6
2/19/42

THE CLEVELAND-CLIFFS IRON COMPANY
Land Department

GRAND ISLAND RENTS RECEIVABLE → DECEMBER 31, 1941

Lease No.	Lessee	Yearly Rental	Amount Owing to 1/1/42	Remarks
	John Lezotte	\$ 60.00	-	Up to date.
1213	Frances Q. Reynolds	50.00	-	do.
1332	Helen Porter Farrell and Jean Farrell Eldredge	50.00	-	"
1333	James H. Needham	50.00	-	"
1616	W. H. Klauer	50.00	-	"
1764	Dr. Frederick Menge	100.00	\$100.00	Paid in February, 1942.
3161	John V. Redfield	50.00	-	Up to date.
			\$100.00	

Typed by
HW-6
2/19/42

THE CLEVELAND-CLIFFS IRON COMPANY
Land Department

DEFERRED ACCOUNTS RECEIVABLE--DECEMBER 31, 1941

Conv. No.	Purchaser	Date of Sale	Consideration	Terms	Date of Last Pay'm.	BALANCE DUE				Interest Paid to	Remarks
						Principal	Taxes	Insurance	Total		
6270	Walter H. P. Jensen	Jan.17, 1938	\$ 650.00	\$10.00 cash. Bal. \$10.00 monthly.	Dec.1941	\$ 320.06			\$ 320.06	11/17/41	Pay roll coll. Up to date.
M.D. 1368	Waino Kangas	Sept.1, 1938	348.80	\$7.00 a month.	Dec.1941	120.51			120.51	12/ 1/41	Up to date.
Conv. 6767	Albert Saari	July 1, 1940	600.00	\$100.00 cash. Bal. \$10.00 mo'ly.	Dec.1941	367.18			367.18	12/ 1/41	Pay roll coll. Up to date.
6868	Ernest G. Harris	Sept.9, 1940	1,600.00	\$100.00 cash. Bal. \$20.00 mo'ly.	Dec.1941	1,312.29	\$29.02		1,341.31 Taxes '40	11/15/41	Pay roll coll. Payments up to date. Taxes to be coll. in 1942.
7241	Joseph H. Collick	Dec.16, 1941	825.00	\$275.00 cash. Bal. \$15.00 mo'ly.	Dec.1941	550.00			550.00	None	Up to date.
						\$2,670.04	\$29.02	-	\$2,699.06		

LMD:HW-6
2/23/42

THE CLEVELAND-CLIFFS IRON COMPANY & SUBSIDIARY COMPANIES

ACREAGE STATEMENT - LANDS OWNED AND CONTROLLED SHOWING OWNERSHIP BY COMPANIES

DECEMBER 31, 1941

COMPANIES	UNPLATTED LANDS					LEASED				PLATTED OWNED			PLATTED LEASED			TOTAL	ACRES OF LAND NOT TMDR. "H"	ACRES OF LAND TIMBERED	LANDS ON MINERAL FORMATION "J"	MINERAL RIGHTS RESERVED IN SALES "K"
	FEE	SURFACE	MINERALS	FLOWAGE	TIMBER	FEE	SURFACE	MINERALS	FLOWAGE	FEE	SURFACE	MINERALS	FEE	SURFACE	MINERALS					
	"A"	"B"	"C"		"G"			"D"				"E"								
CONSTITUENT COMPANIES (Entire Stock Owned by The C.C.I.Co.) The Cleveland-Cliffs Iron Co. Land Department Mining Department Superior Realty Company The Cliffs Power & Light Co.	324,699.53 7,249.78 36,888.16 439.00	30,160.92 789.05 4,652.78 12,282.35	1,629.35 275.94	699.29	119.41	789.54	109.04 9,456.11	99.69	708.29	265.13 49.97	23.73 66.56	305.38 200.46	2.46	63.90	357,203.45 9,695.39 41,510.94 23,897.14					
TOTAL CONSTITUENT COMPANIES	369,246.47	47,855.10	1,905.29	699.29	119.41	789.54	9,566.15	99.69	708.29	315.10	90.29	505.84	2.46	63.90	431,966.92					
ALLIED COMPANIES (A Portion of the Stock Only Owned by The C.C.I.Co.) The Mesquite Mine Company Arctic Iron Company The Adams Iron Mining Co. Lucky Star Mining Company Michigan Mineral Land Company Mesaba Cliffs Mining Company Bunker Hill Mining Company	920.48 44.57 49.74 13,849.51 102.00 43.10	3.49 8.09 716.42	37.98 17.39 15,963.89 10.20			214.58 1,279.39	5.42 1,872.37	21.61			2.96 4.26 .36	103.53	17.70	230.45 1,121.99 95.82 49.74 29,812.40 3,988.24 53.30						
TOTAL ALLIED COMPANIES	15,068.40	728.00	16,029.46			1,493.97	1,872.37	31.03			7.58	103.53	17.70	35,352.04						
GRAND TOTALS	384,314.87	48,583.10	17,934.75	699.29	119.41	2,283.51	11,438.52	130.72	708.29	315.10	97.87	609.37	2.46	17.70	467,318.96					

"A"--Lands where entire fee is owned.
 "B"--Lands where surface only is owned.
 "C"--Lands where minerals only are owned in known mineral district.
 "D"--Lands where our interest is confined to a mining lease.
 "E"--Lands where timber only is owned.

"G"--Lands where we own the entire fee, surface only, or minerals only in lands which are a part of recorded plats of towns or villages.
 "H"--Lands which have been examined and which reports show do not contain sufficient timber to be classed as timber land.
 "J"--Approximate acreage of lands inside the mineral formation as indicated by maps furnished to the Land Department by the Mining Department, April, 1914.
 "K"--Acres of minerals reserved in Land Sales, outside of mineral formation.

ACREAGE STATEMENT - LANDS OWNED AND CONTROLLED SHOWING OWNERSHIP BY COMPANIES

DECEMBER 31, 1941

SHEET 2

COMPANIES	FEE "A"	SURFACE "B"	MINERALS "C"	FLOWAGE	TIMBER "D"	FEE	SURFACE	MINERALS "D"	FLOWAGE	FEE	SURFACE	MINERALS "D"	FEE	SURFACE	MINERALS	TOTAL	ACRES OF LAND NOT TRD. "H"	ACRES OF LAND TIMBERED	LANDS ON MINERAL RIGHTS	
																			MINERAL FORMATION "J"	RESERVED IN SALES "K"
Total Acreage, December 31, 1940	369,878.72	46,793.91	17,433.16	699.29	119.41	2,684.74	11,438.52	130.72	706.39	309.34	98.42	609.37	2.46	17.70	63.90	472,968.05	149,969.76	322,028.29	83,193.71	200,134.60
Purchases & Adjustments:																				
The Cleveland-Cliffs Iron Co. (1)	202.28	160.00								6.48						48.75	48.76			
Adjustment in Sale (2)		2.39														2.39				
Superior Realty Company (3)	5,460.88	1,399.91														6,860.79	6,860.79			
Cancelled Contracts (4)	80.00															80.00	80.00			80.00
The Cliffs Power & Light Co. (5)		159.82														159.82	159.82			
The Nagausse Mine Company (6)											.17					.17	.17			
Michigan Mineral Land Co. (7)	1,594.06															1,594.06	1,594.06			
TOTAL	397,215.94	50,196.03	17,433.16	699.29	119.41	2,684.74	11,438.52	130.72	706.39	315.82	98.59	609.37	2.46	17.70	63.90	481,734.04	158,703.36	322,030.68	83,193.71	200,054.60
Sales and Surrenders:																				
The Cleveland-Cliffs Iron Co. (8)	11,247.50	1,549.18								.72	.72					12,796.12	12,053.45	744.67		1,480.69
Surrendered (9)						401.23										401.23	401.23			
Superior Realty Co. (10)	550.00	8.12														558.12	558.12			515.97
Reverted to State (11)	240.00	40.00														280.00	280.00			
The Cliffs Power & Light Co. (12)		15.63														15.63	15.63			
Michigan Mineral Land Co. (13)	541.59		501.59													40.00	40.00			
Abandoned (14)	311.98															311.98	311.98			
Classification Changed (The C.C.I.Co.) (15)																7,364.99	7,364.99			
TOTAL	12,901.07	1,612.93	501.59			401.23				.72	.72					14,415.09	6,305.42	8,109.66		1,996.66
TOTAL ACREAGE - DEC. 31, 1941	384,314.87	48,583.10	17,934.75	699.29	119.41	2,283.51	11,438.52	130.72	706.39	315.10	97.87	609.37	2.46	17.70	63.90	467,318.96	152,397.94	314,921.02	83,193.71	202,051.46

- (1) - Purchase Nos. 3690, 3691 and 3926.
- (2) - Adjustment in acreage involved in Conv. Nos. 4698 and 5940.
- (3) - Purchase Nos. 3922 and 3923.
- (4) - Conveyance Nos. 4143 and 5626.
- (5) - Purchase Nos. 3912, 3913, 3914, 3915, 3916, 3917 and 3920.
- (6) - Purchase No. 3863.
- (7) - Purchase No. 3895.
- (8) - As per Sales Statement and Conv. Nos. 7023, 7125, 7180, 7127, 7154, 7195, 7204, 7210 and 7232.
- (9) - Conveyance Nos. 7198, 7235 and 7237.
- (10) - As per Sales Statement Dec. 31, 1941.
- (11) - Timber Sold - Abandoned.
- (12) - Conveyance Nos. 7230, 7246, 7247 and 7250.
- (13) - Conveyance Nos. 7027, 7028, 7038, 7114 and 7179.
- (14) - Abandoned Lands Re-instated - Timber Sold and Now Re-abandoned.
- (15) - Sales of Timber Only and Lands Operated.
- (16) - In addition The Cleveland-Cliffs Iron Co. owns Hardwood Saw Timber Rights on 1,083.05 Acres and Hardwood Saw Timber and certain Softwood Rights on 1,321.75 Acres (La La Belle Lands.)
- (17) - Timber Rights on 11,805.54 acres reserved by The Cleveland-Cliffs Iron Company (The Cliffs Power & Light Co. lands.)

THE CLEVELAND-CLIFFS IRON COMPANY
Land Department

LAND ACREAGE - DECEMBER 31, 1941

County	Town	Range					PLATTED LANDS			Total	Minerals Re-served in Sales
			Fee	Surface	Minerals	Timber	Fee	Surface	Minerals		
<u>Chippewa</u>	46	2	1,998.05						1,998.05	158.11	
	47	2								40.00	
	46	3	159.00						159.00		
	44	6	131.10						131.10	157.20	
	46	7	171.26						171.26		
	47	7	297.81						297.81	41.00	
	48	7								658.67	
	49	7								758.25	
Totals			2,757.22						2,757.22	1,813.23	
<u>Luce</u>	46	8	2,241.52						2,241.52		
	47	8	5,849.06						5,849.06	126.00	
	48	8	2,365.14						2,365.14	1,275.35	
	49	8	3,012.70						3,012.70	160.00	
	50	8	160.00						160.00		
	47	9	4,964.89						4,964.89	1,733.00	
	48	9	2,686.68						2,686.68	160.00	
	49	9	360.00						360.00		
	45	10	120.00						120.00		
	47	10	1,957.58						1,957.58	2,287.15	
	48	10	5,100.93						5,100.93	52.92	
	49	10	2,739.07						2,739.07	126.40	
	46	11	785.62						785.62	80.00	
	47	11	9,007.91			119.41			9,127.32	40.00	
	48	11	6,519.18						6,519.18	40.00	
	49	11	272.35						272.35		
	46	12	3,790.39						3,790.39	339.74	
	47	12	14,232.62	198.41					14,431.03		
48	12	16,971.97	160.00					17,131.97			
49	12	6,383.90						6,383.90	120.00		
50	12	330.25						330.25			
Totals			89,851.76	358.41		119.41			90,329.58	6,540.56	
<u>Alger</u>	48	13	18,439.77	40.00					18,479.77		
	49	13	7,333.82						7,333.82	113.71	
	50	13	164.35						164.35		
	48	14	18,094.68	313.73					18,408.41		
	49	14	9,165.79	280.00					9,445.79	4.28	
	48	15	5,972.90	360.00					6,332.90	40.00	
	49	15	3,010.91	195.20					3,206.11		
	48	16	8,557.43	455.37					9,012.80	2.26	
	49	16	1,004.60	280.00					1,284.60		
	46	17	633.08						633.08	532.00	
	47	17	3,030.53	200.00					3,230.53	101.18	
	48	17	4,275.92	201.00					4,476.92	.23	
	46	18	7,576.29						7,576.29	193.54	
	47	18	10,472.58	120.00					10,592.58	491.71	
	48	18	520.00						520.00		
	44	19	4,345.71	40.00					4,385.71	80.00	
	45	19	118.41	40.00					158.41		
	46	19	8,011.68	152.37					8,224.46	20.75	
	47	19	8,986.60	108.18				46.59	13.82	9,094.78	85.02
48	19	6,365.06	638.35					7,003.41			
44	20	6,194.09						6,194.09			

LAND ACREAGE - DECEMBER 31, 1941 (CONT'D.)

Sheet 2

County	Town	Range					PLATTED LANDS			Total	Minerals Re- served in Sale
			Fee	Surface	Minerals	Timber	Fee	Surface	Minerals		
<u>Alger</u>	45	20	1,021.22	595.00					1,616.22	39.10	
	46	20	4,119.71	80.00				4,199.71	23.04		
	47	20	4,577.95					4,577.95	84.06		
	48	20	113.96					113.96			
	44	21	1,278.91	355.15				2,254.06	121.00		
	45	21	989.15					989.15	282.19		
	46	21	836.16					836.16	379.08		
	47	21	2,778.33					2,778.33	117.95		
	48	21	963.48					963.48			
	44	22		423.10				423.10			
	45	22								40.00	
	46	22	1,732.26				.88		1,733.14	707.00	
	47	22	5,057.70	1,267.50					6,325.20	44.03	
	48	22	1,620.09	200.00					1,820.09		
Totals			157,963.12	6,344.95			47.47	13.82	164,369.36	3,502.13	
<u>Schoolcraft</u>	46	13	280.00						280.00		
	47	13	4,058.88						4,058.88		
	46	14	400.00						400.00	80.00	
	47	14	4,850.62	437.25					5,267.87		
	46	15	3,915.58						3,915.58		
	47	15	2,025.06	654.20					2,679.26		
	46	16	416.03						416.03	40.00	
	47	16	3,357.70	40.00					3,397.70	51.40	
	45	17	521.01						521.01	40.00	
	44	18	55.78						55.78		
	45	18	320.00						320.00		
Totals			20,180.66	1,131.45					21,312.11	211.40	
<u>Delta</u>	39	18	2.51						2.51		
	37	19	135.60						135.60		
	38	19	668.19						668.19	168.90	
	39	19	491.65						491.65	45.74	
	43	21	56.60						56.60	160.00	
	40	22					.52		.52		
	41	22								4.25	
	39	23	79.00						79.00	1.00	
	43	23	40.00						40.00		
Totals			1,473.55				.52		1,474.07	379.89	
<u>Baraga</u>	48	31		120.00					120.00		
	50	34	40.00						40.00		
Totals			40.00	120.00					160.00		
<u>Marquette</u>	45	23	400.00	2,849.15					3,249.15		
	46	23	793.63	5,346.26					6,139.89	33.00	
	47	23	875.00	1,872.52					2,747.52	5.00	
	44	24		1,682.07					1,682.07		
	45	24	309.96	1,428.09					1,738.05	10.04	
	46	24	1,946.37	160.00					2,106.37		
	44	25	614.35						614.35		
	45	25	86.78	242.93					329.71		
	47	25	3,451.87	539.51					3,991.38	41.77	
	48	25	2,217.74	160.00			6.59		2,384.33	20.55	
	49	25								40.14	
	45	26	76.27						76.27		
	47	26	7,427.18	123.32	351.70		56.12	9.91	130.41	8,101.64	148.53

LAND ACREAGE - DECEMBER 31, 1941 (CONT'D.)
Sheet 3

County	Town	Range					PLATTED LANDS			Total	Minerals Reserved in Sales
			Fee	Surface	Minerals	Timber	Fee	Surface	Minerals		
<u>Marquette</u>	48	26	2,091.72	451.20	17.47				2,560.39	448.14	
	49	26	600.00	3,654.40					4,254.40		
	46	27	81.68						81.68		
	47	27	8,220.07		1,051.55		154.43	174.97	9,601.02	2.91	
	48	27	2,684.31	1,560.85	120.00				4,365.16	13.21	
	49	27	799.76						799.76		
	51	27	1,092.02						1,092.02		
	47	28	1,106.16		86.63				1,194.79		
	48	28	2,862.87						2,862.87	2.77	
	50	28	1,921.62	789.33					2,710.95		
	51	28	9,437.70	837.88					10,275.58	4.55	
	46	29								63.40	
	47	29	40.00						40.00		
	50	29	539.14						539.14		
	51	29	2,102.92						2,102.92	17.08	
	45	30	46.20	80.00					126.20		
	46	30	200.00	160.00					360.00	26.80	
	47	30	327.90	265.60					593.50		
Totals			52,353.22	22,206.11	1,629.35		217.14	9.91	305.38	76,721.11	877.89
<u>Iron</u>	43	31									36.23
	44	33	80.00						80.00		
Totals			80.00						80.00		36.23
GRAND TOTALS			324,699.53	30,160.92	1,629.35	119.41	265.13	23.73	305.38	357,203.45	13,361.33

CAJ:MJ-3
2/21/42

THE CLEVELAND-CLIFFS IRON COMPANY
Land Department

STATEMENT OF LANDS PURCHASED FOR THE YEAR 1941

Purchase	Grantor	Purch. No.	Acreage	Purchase Price	Description
Piqua	Leward C. Wykoff, Trustee of the Est. of the Piqua Munising Wood Products Co., Bankrupt	3890	41.00	\$515,000.00	Part of NW $\frac{1}{4}$ of SE $\frac{1}{4}$, Sec. 15-48-25, part of NE $\frac{1}{4}$ of SW $\frac{1}{4}$, Sec. 15-48-25, Lots 170 and 177, Asire Add'n, and Lot 1, Blk 17, West End Add'n, City of Marquette
do.	do.	3891	7.76	Included in above	A portion of Lot 3, Sec. 2-46-19; SE $\frac{1}{4}$ of SW $\frac{1}{4}$ and SW $\frac{1}{4}$ of SE $\frac{1}{4}$, Sec. 2-46-19; Lot 11 and E $\frac{1}{2}$ of Lot 10, Re-plat of Blk 1, LaPorte Add'n, City of Munising
"	"	3892	623.25	d8.	Sub-lots numbered 1 to 26 incl. and 41 to 52 incl., as shown by Plat of Crystal Lake Sub-division, Lake Town- ship, Benzie County, Michigan; S $\frac{1}{2}$ of NW $\frac{1}{4}$ and SW $\frac{1}{4}$, Sec. 35-27-16, N $\frac{1}{2}$ of NW $\frac{1}{4}$ and SE $\frac{1}{4}$ of NW $\frac{1}{4}$, Sec. 22-26-23, Frac. Sec. 2-26-16, SE $\frac{1}{4}$, Section 35-27-16, SW $\frac{1}{4}$, Sec. 26-48-31, and NE $\frac{1}{4}$ of SW $\frac{1}{4}$, Section 17-48-43.
"	"	3893	-	"	Lots 1167 to 1182 incl., Caldwell's Add'n of 1869 to the Village of Piqua; parts of Lots 1338 to 1362 incl. in the City of Piqua; also strip of land 33' wide and 517' long lying north of Lots 1175 to 1182 incl. in the City of Piqua, Ohio.
"	"	3894	-	"	Indian Lake Lots, Seminole Island, Stokes Township, Logan County, Ohio: Lots 1, 5, 6, 19 to 102 incl., 111 to 120 incl., 123, 124, 130, 131, 134, 135, 136, 142, 152, 153, 154, and 158.

CAJ:HW-3
2/6/42

EAST PART
ALGER COUNTY
AND
NORTH PART
SCHOOLCRAFT COUNTY

SCALE IN MILES

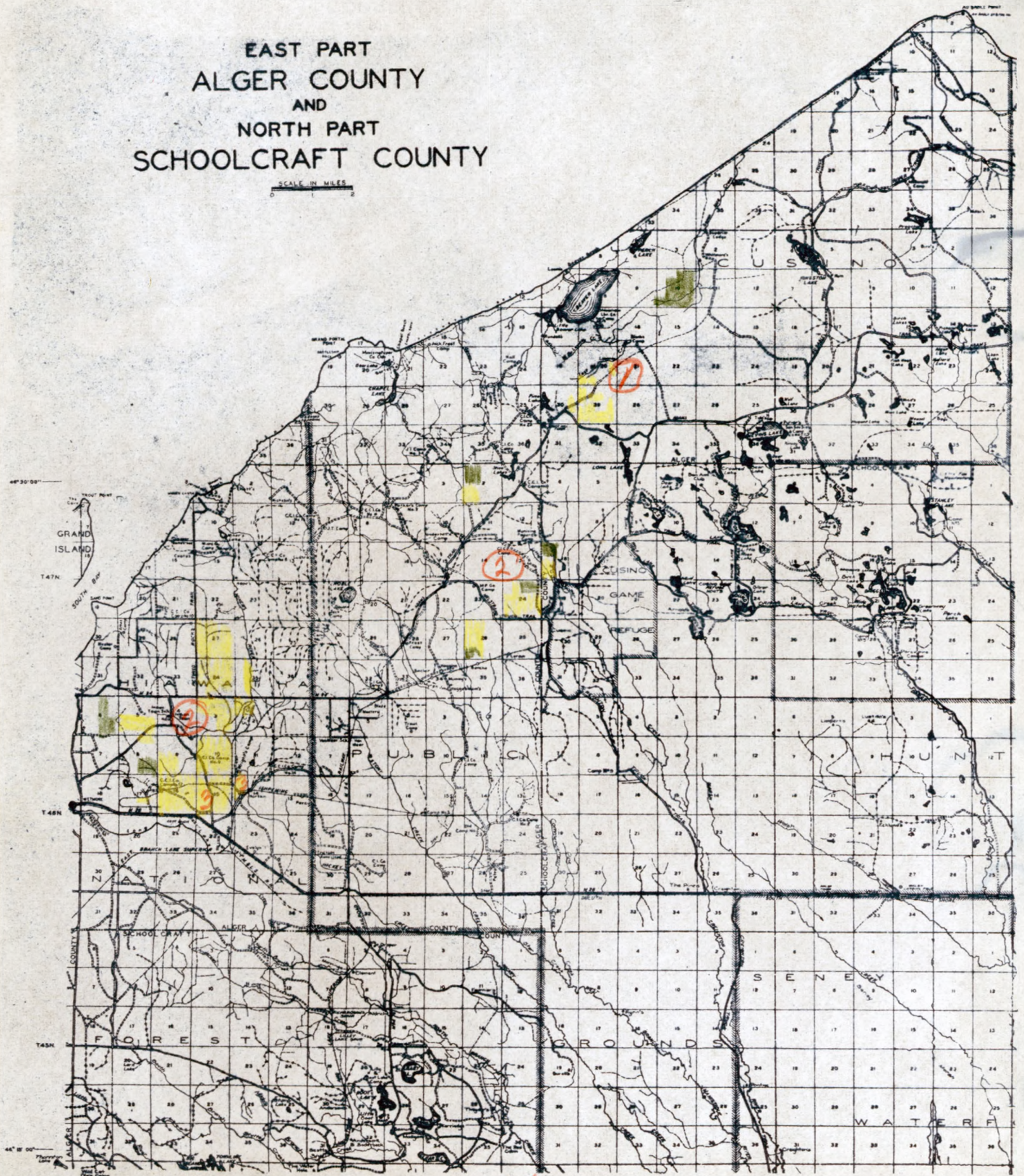

- ① Burrell Job
- ② Moots "
- ③ Kraus " 79

Timber Standing
" Cut.

WEST PART ALGER COUNTY

SCALE IN MILES
0 1 2

L A K E S U P E R I O R

① Peura Job
Timber standing
Timber Cut

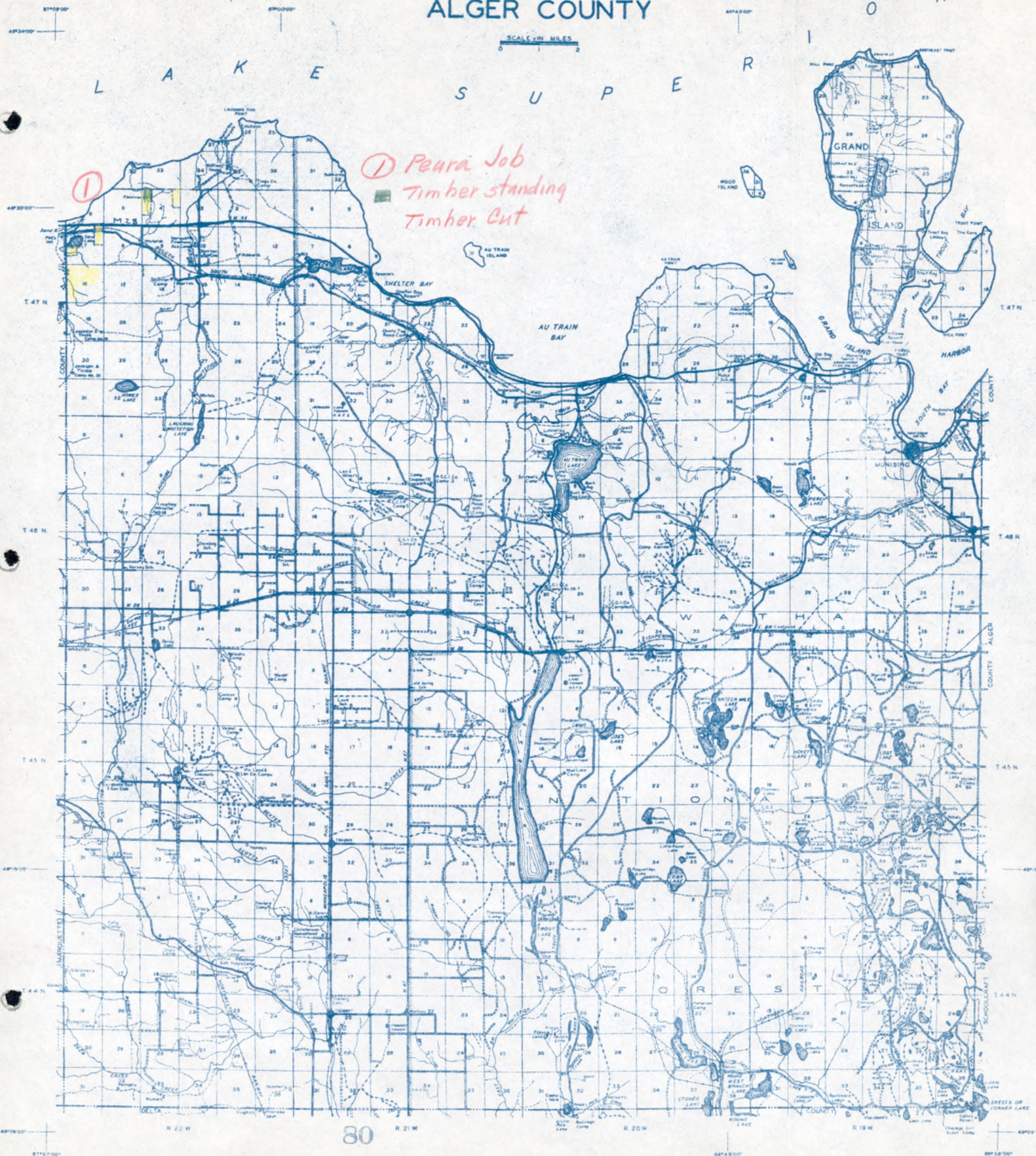

SOUTHEAST PART MARQUETTE COUNTY

SCALE IN MILES
0 1 2

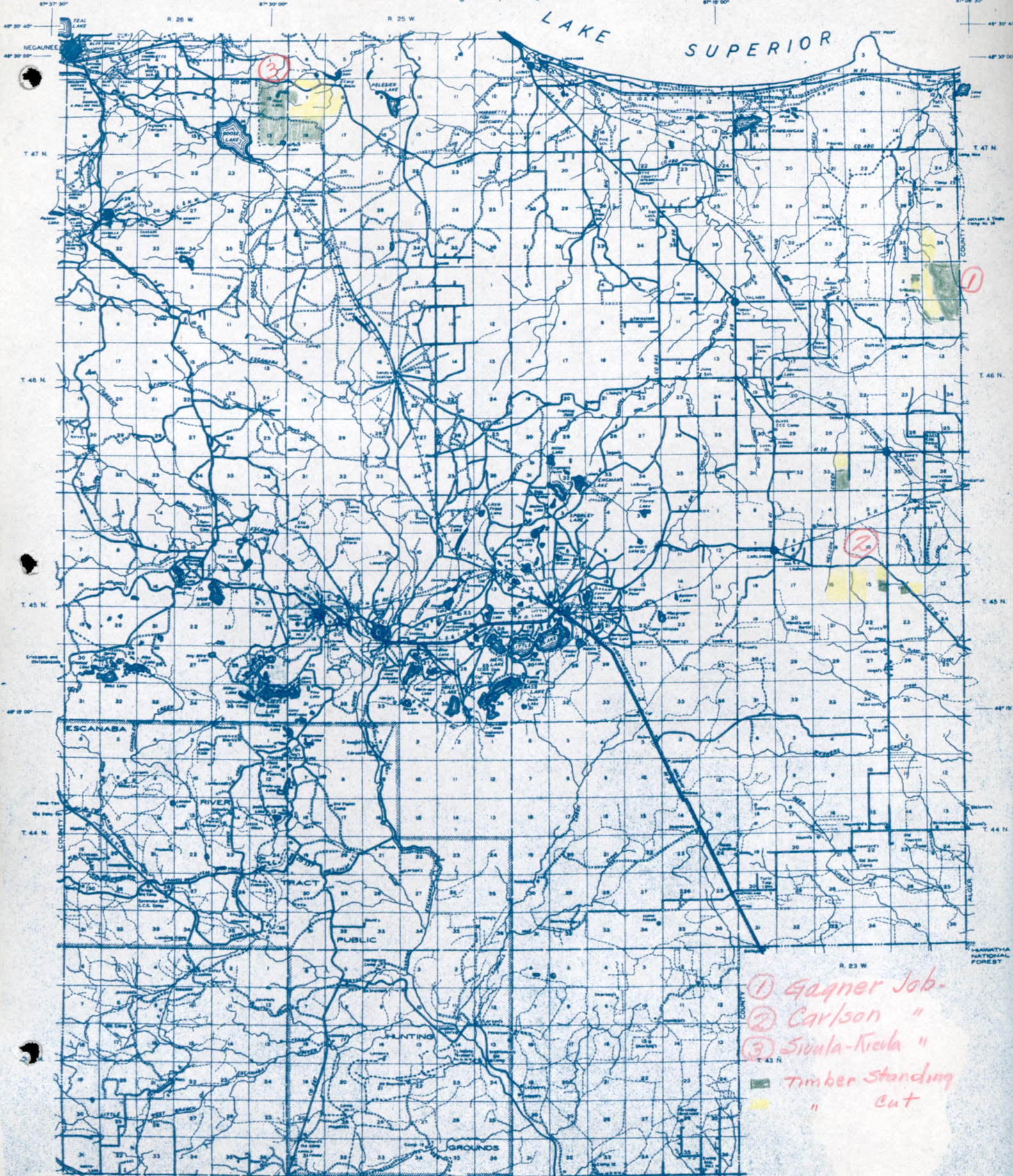

- ① Gagner Job.
- ② Carlson "
- ③ Sivala-Kieula "
- Timber standing
- " cut

DIAGRAM

TOWNSHIP NO. ^{OF} 45 RANGE NO. 20
COUNTY, STATE OF

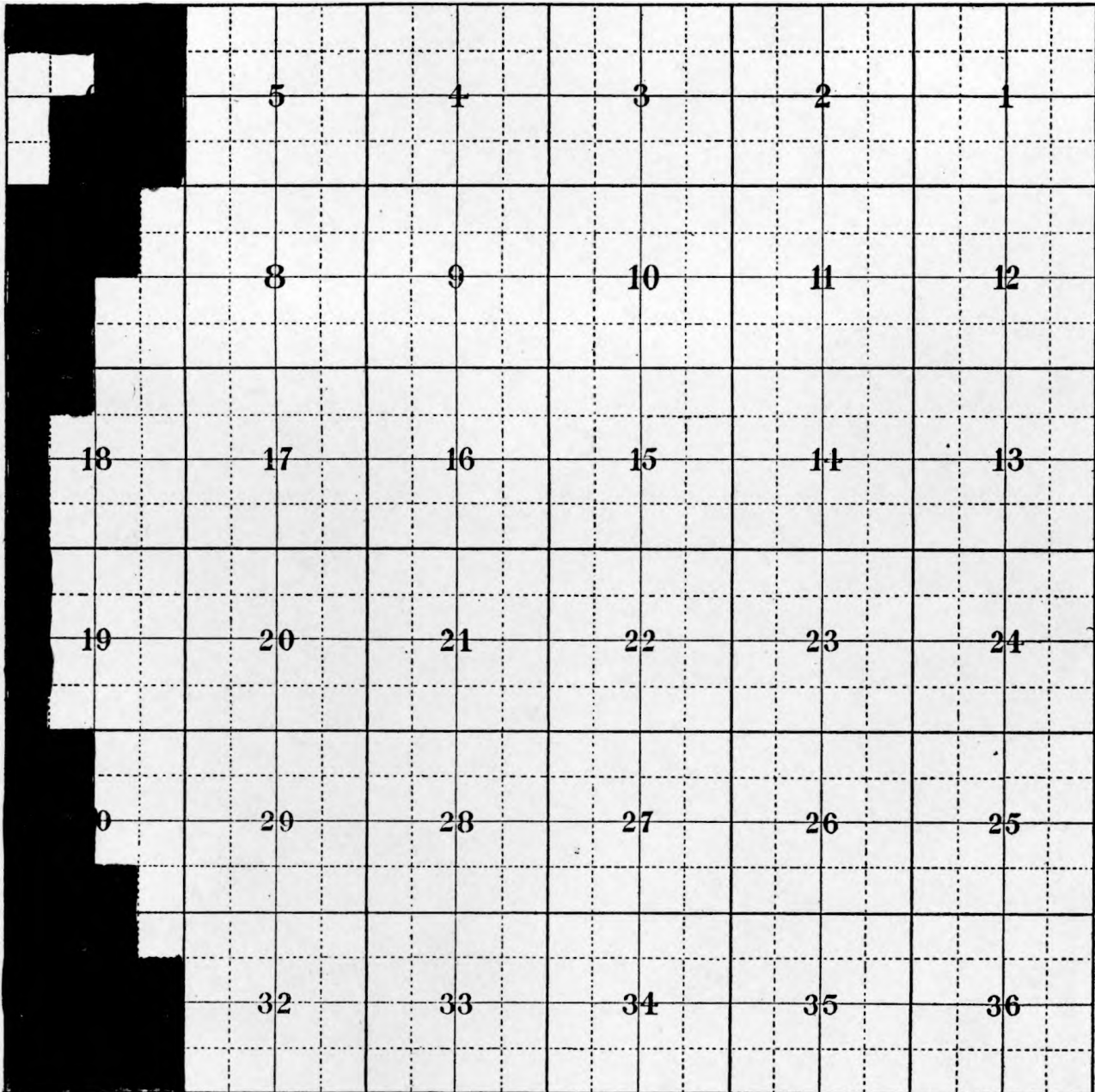

LEGEND

Stenglein Bindery, Marquette, Mich.

 - C.C.I. Co. owns all timber and second growth reserved in sale to The Cliffs Power & Light Co. Reserved for 50 years to July 28th, 1976.

DIAGRAM

TOWNSHIP NO. *45* OF RANGE NO. *31*
COUNTY, STATE OF

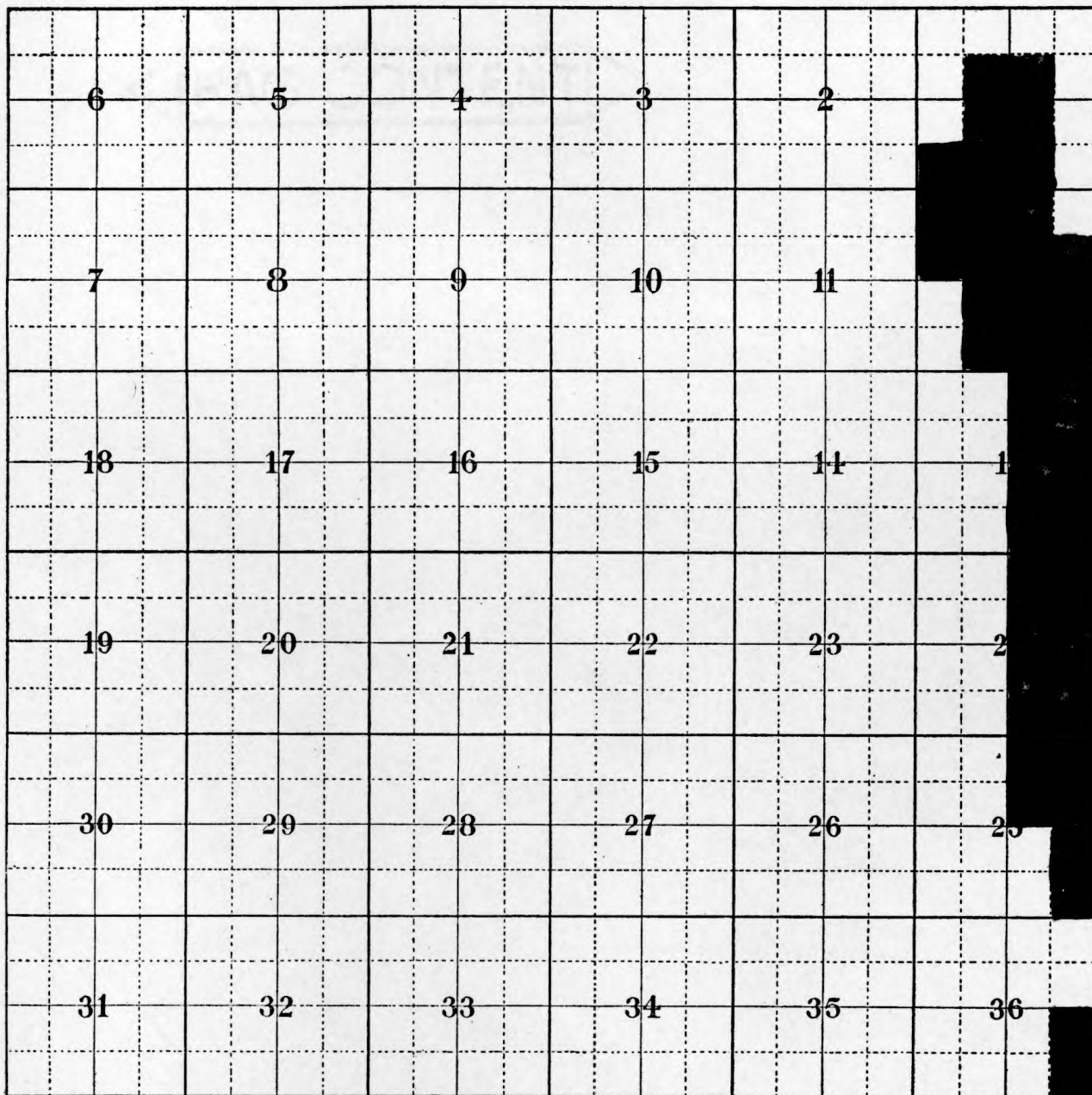

LEGEND

Stenglein Bindery, Marquette, Mich.

 - C.C.I. Co. owns all timber and second growth reserved in sale to The Cliffs Power & Light Co. Reserved for 50 years to July 28th, 1976.

DIAGRAM

TOWNSHIP NO. *46* OF RANGE NO. *20*
COUNTY, STATE OF

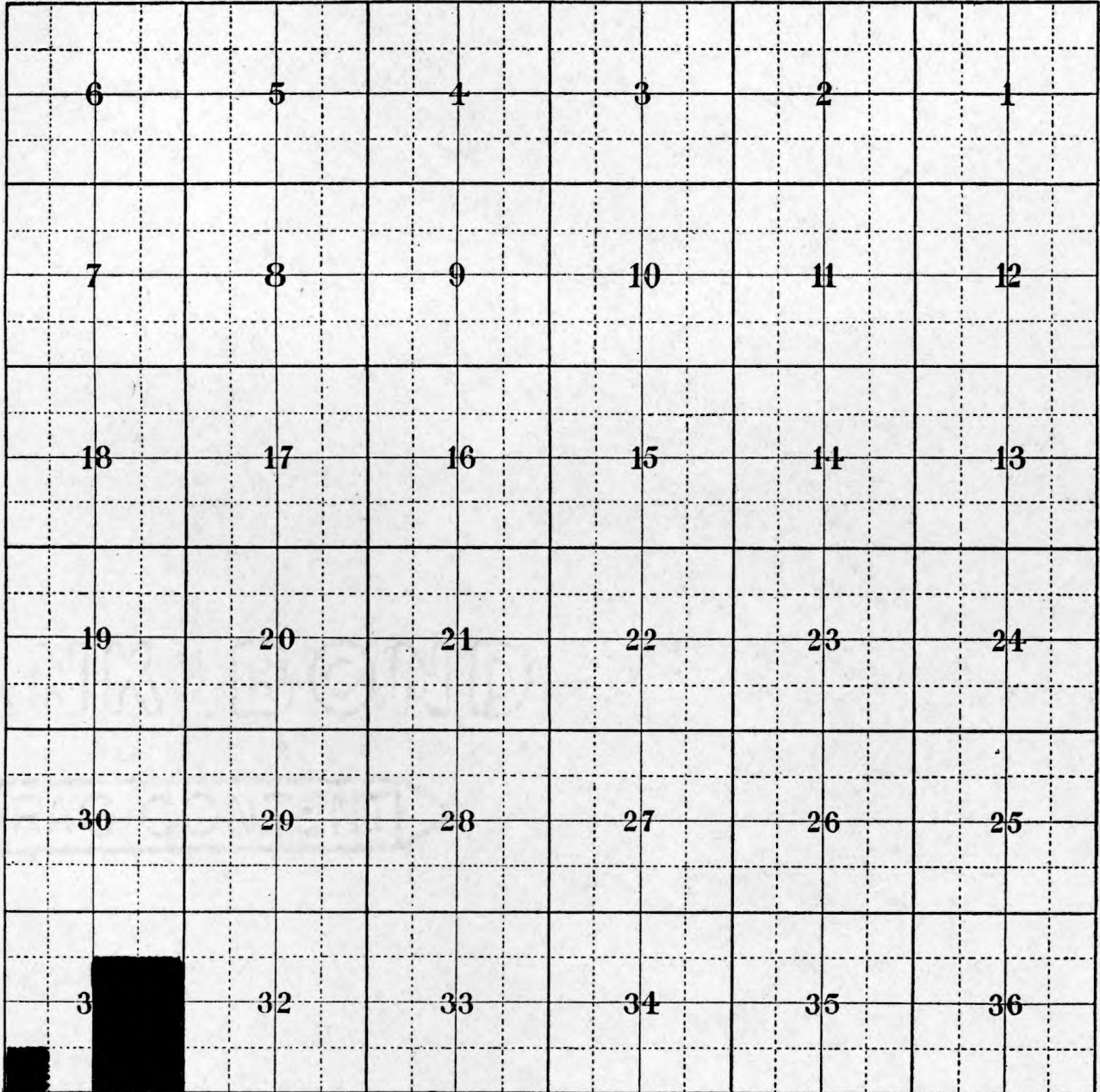

LEGEND

Stenglein Bindery, Marquette, Mich.

 - C.C.I. Co. owns all timber and second growth reserved in sale to The Cliffs Power & Light Co. Reserved for 50 years to July 28th, 1976.

DIAGRAM

TOWNSHIP NO. 47^{OF}

RANGE NO. 25

COUNTY, STATE OF

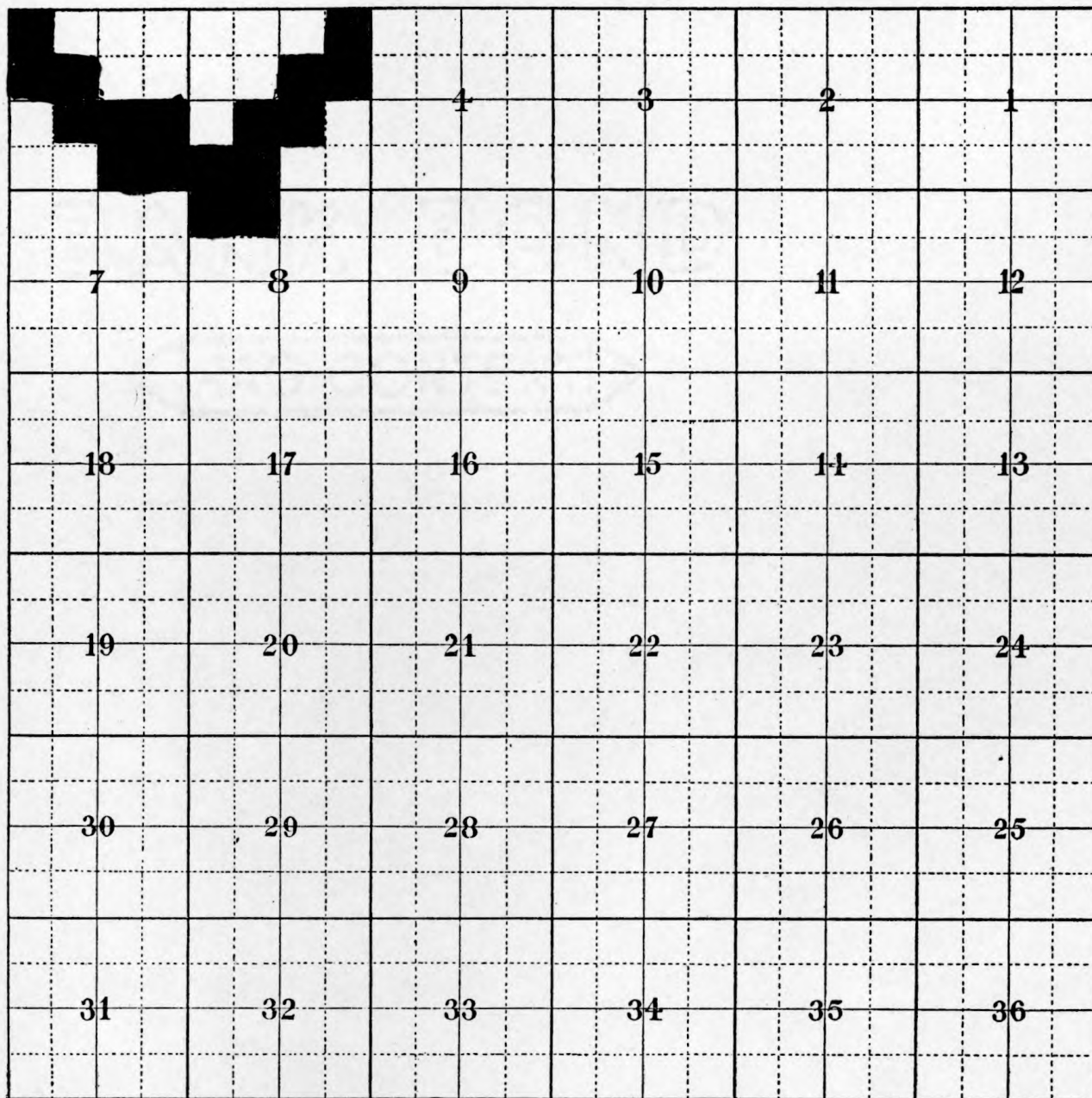

LEGEND

Stenglein Bindery, Marquette, Mich.

■ - C.C.I. Co. owns all timber and second growth reserved in sale to The Cliffs Power & Light Co. Reserved for 50 years to July 28th, 1976.

DIAGRAM

TOWNSHIP NO. *48* OF

RANGE NO. *25*

COUNTY, STATE OF

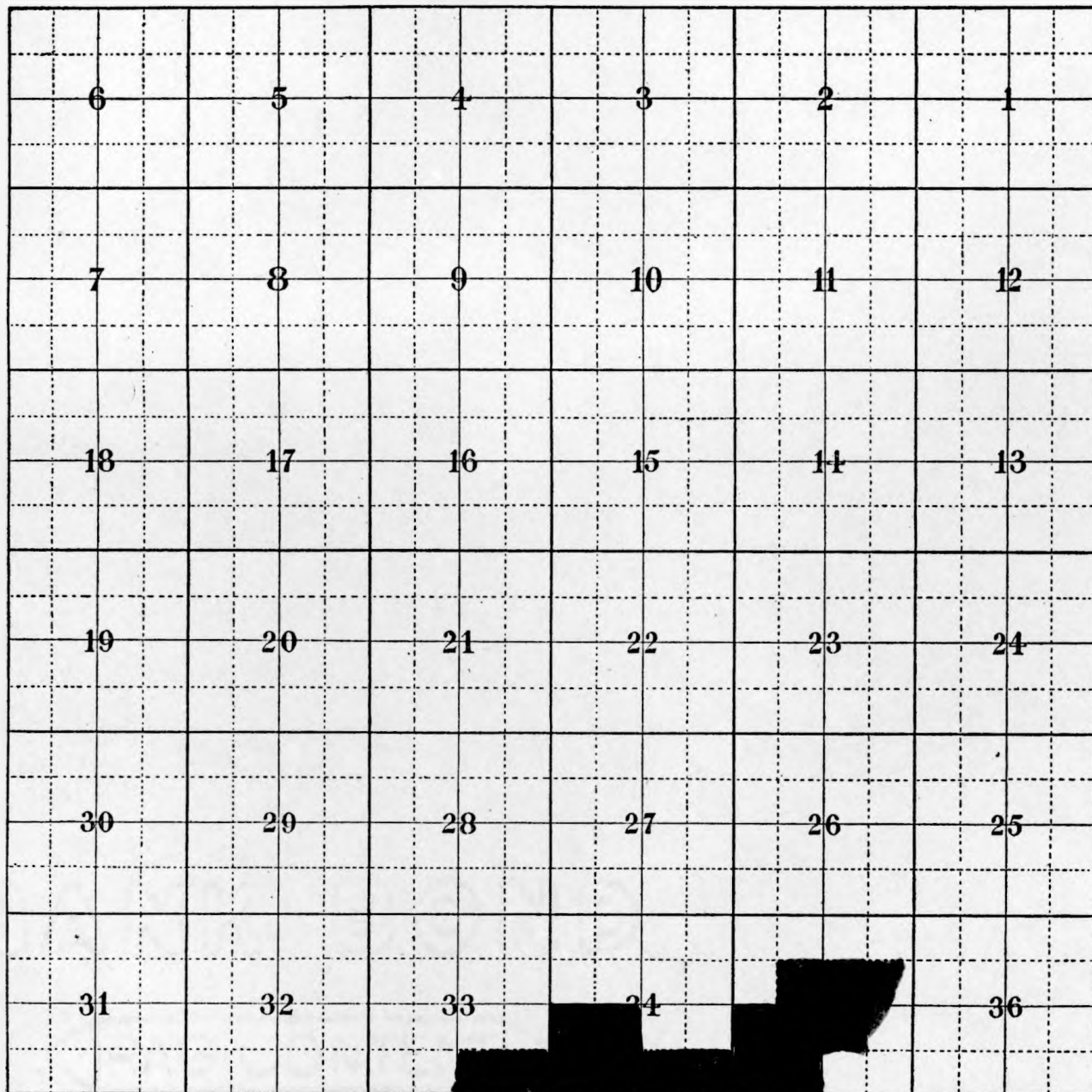

LEGEND

Stenglein Bindery, Marquette, Mich.

 - C.C.I. Co. owns all timber and second growth reserved in sale to The Cliffs Power & Light Co. Reserved for 50 years to July 28th, 1976.

DIAGRAM

TOWNSHIP NO. 45^{OF}

RANGE NO. 26

COUNTY, STATE OF

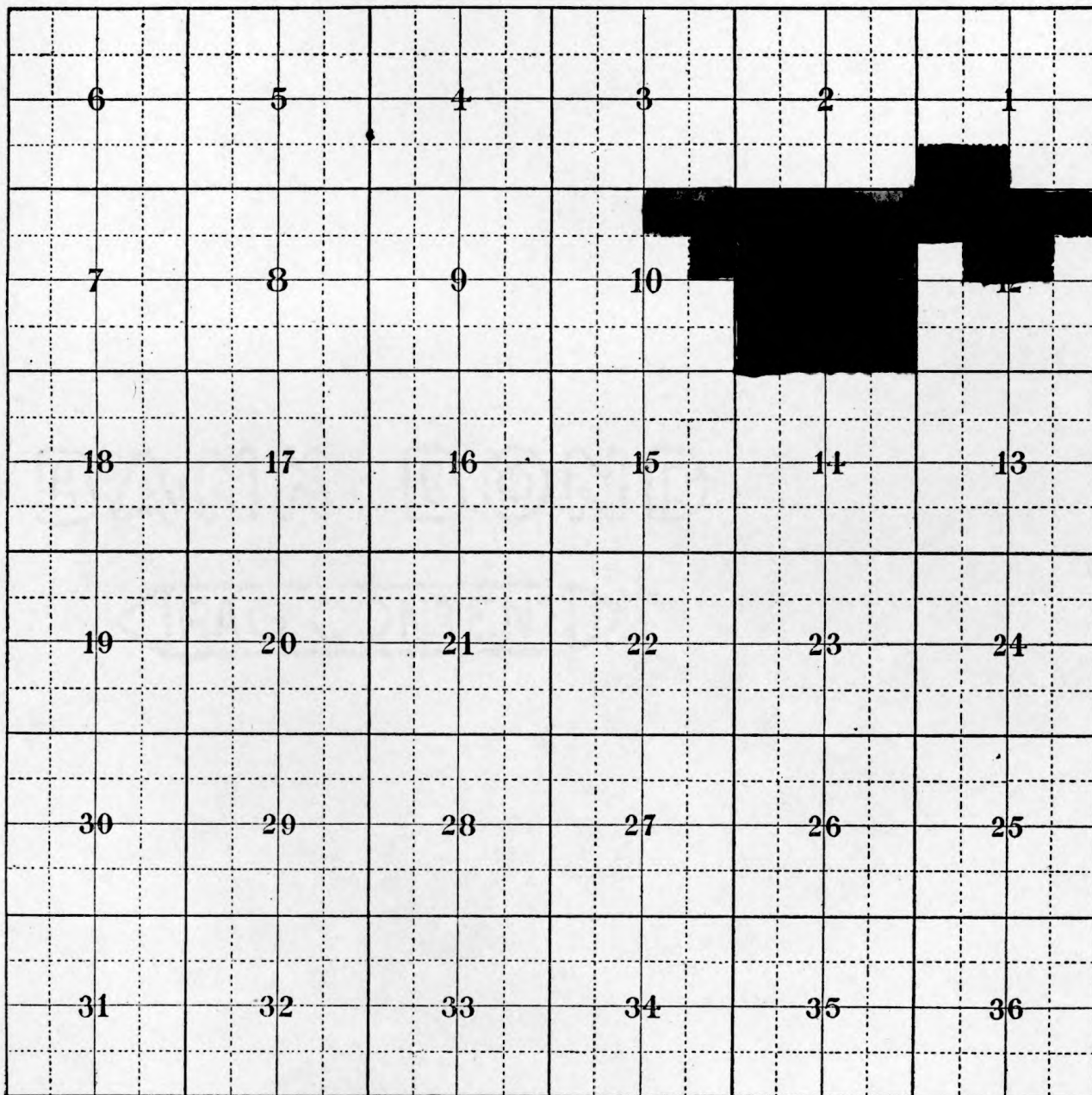

LEGEND

Stenglein Bindery, Marquette, Mich.

 - C.C.I. Co. owns all timber and second growth reserved in sale to the Cliffs Power & Light Co. Reserved for 50 years to July 28th, 1976.

DIAGRAM

TOWNSHIP NO. 47^{OF}

RANGE NO. 26

COUNTY, STATE OF

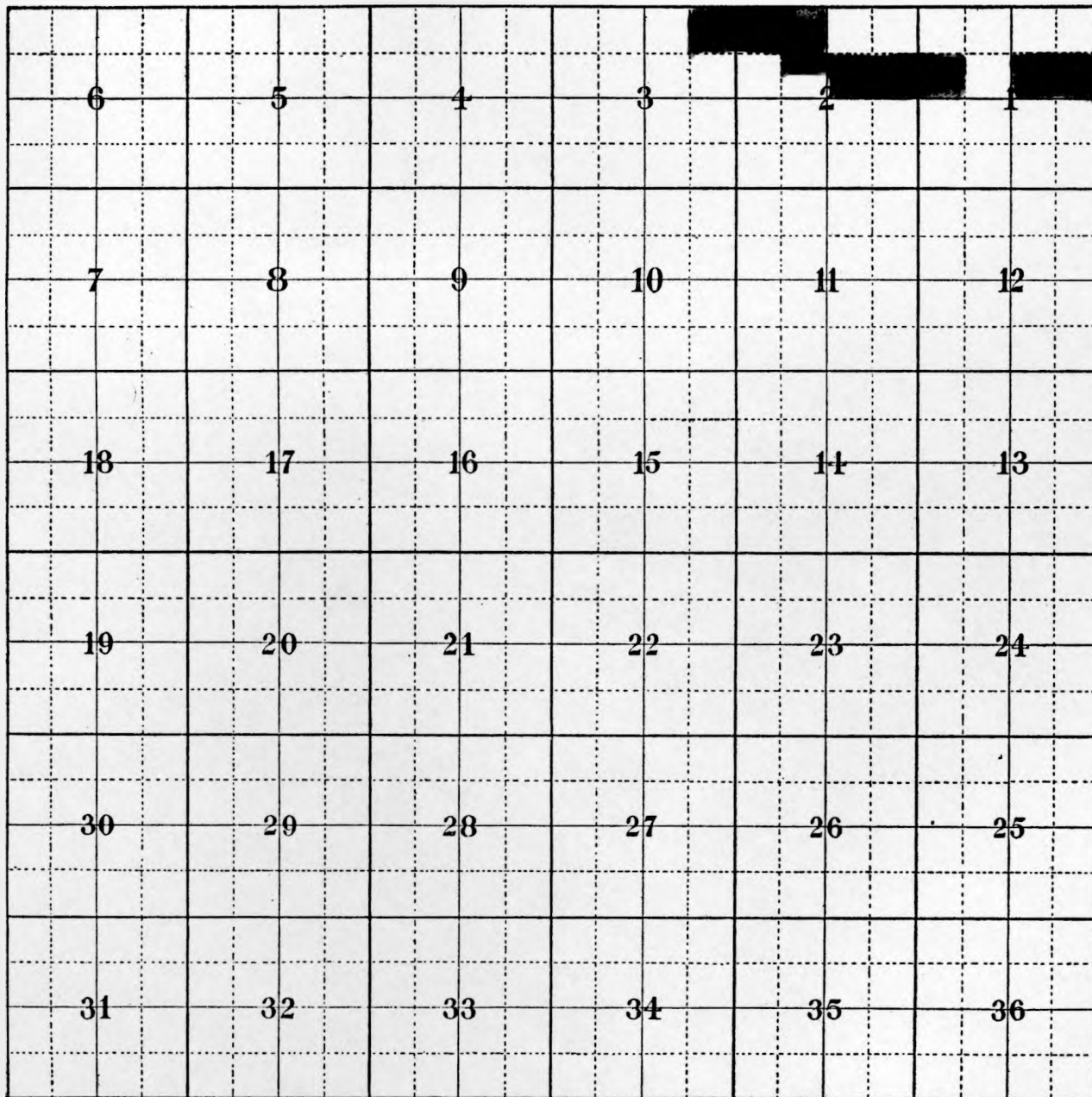

LEGEND

Stenglein Bindery, Marquette, Mich.

 - C.C.I. Co. owns all timber and second growth reserved in sale to the Cliffs Power & Light Co. Reserved for 50 years to July 28th, 1976.

DIAGRAM

TOWNSHIP NO. 48^{OF}

RANGE NO. 26

COUNTY, STATE OF

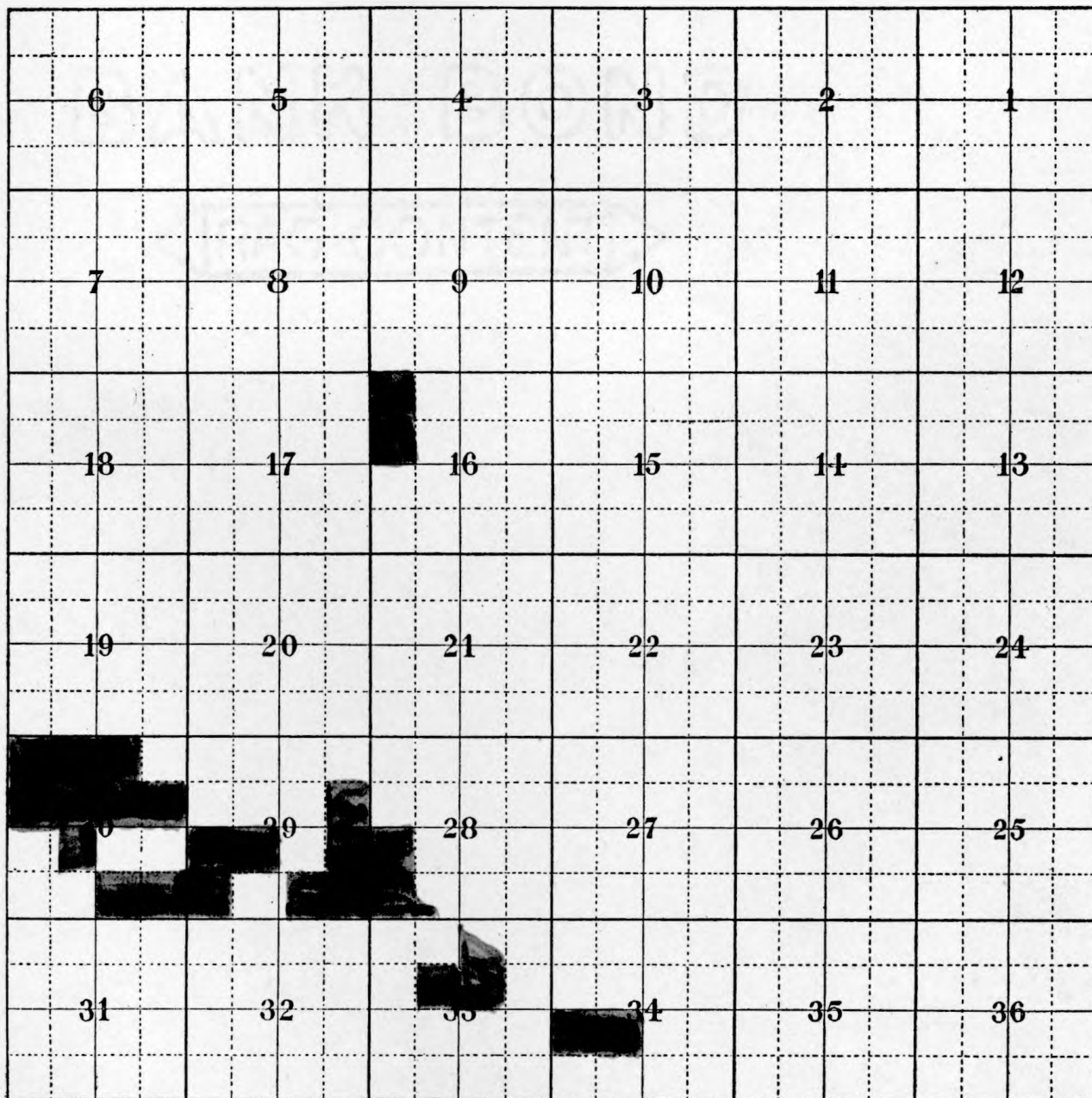

LEGEND

Stenglein Bindery, Marquette, Mich.

-  - C.C.I.Co. owns all timber and second growth reserved in sale to The Cliffs Power & Light Co. Reserved for 50 years to July 28th, 1976.

DIAGRAM

TOWNSHIP NO. 48^{OF} RANGE NO. 27
COUNTY, STATE OF

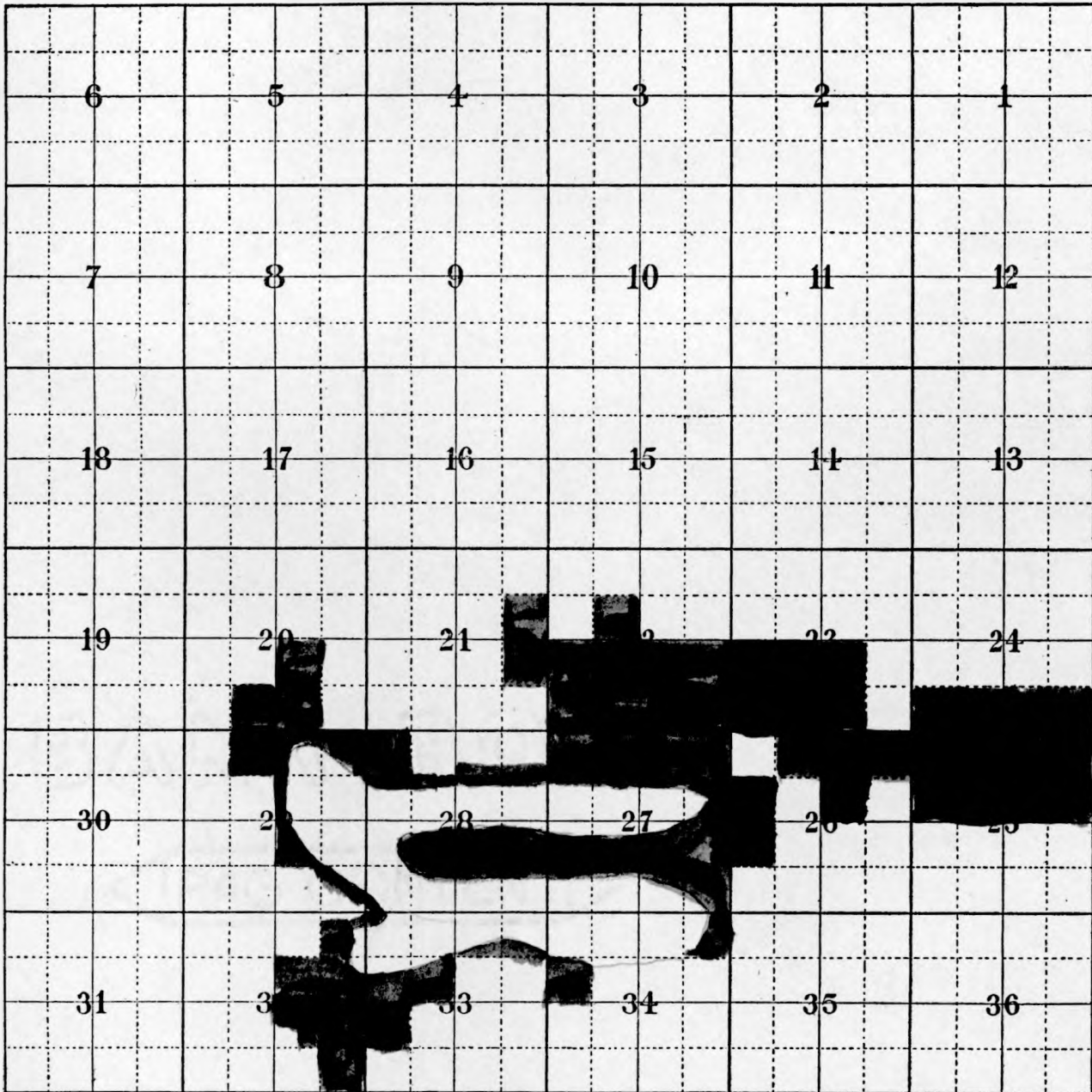

LEGEND

Stenglein Bindery, Marquette, Mich.

-  - C.C.I. Co. owns all timber and second growth reserved in sale to The Cliffs Power & Light Co. Reserved for 50 years to July 28th, 1976.

DIAGRAM

TOWNSHIP NO. 46 ^{OF} RANGE NO. 29
COUNTY, STATE OF

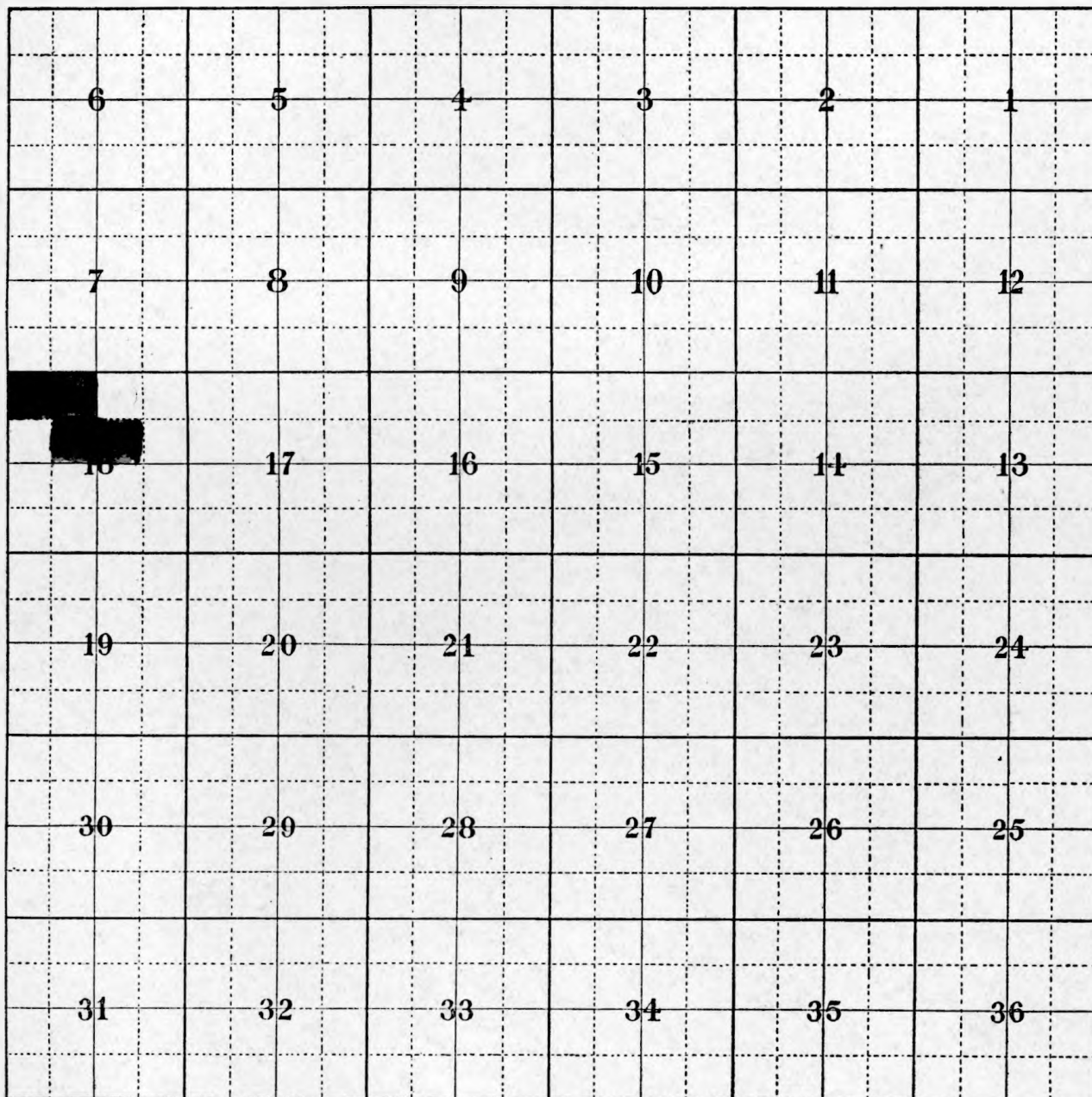

LEGEND

Stenglein Bindery, Marquette, Mich.

-  - C.C.I. Co. owns all timber and second growth reserved in sale to The Cliffs Power & Light Co. Reserved for 50 years to July 28th, 1976.

DIAGRAM

TOWNSHIP NO. 47^{OF}

RANGE NO. 29

COUNTY, STATE OF

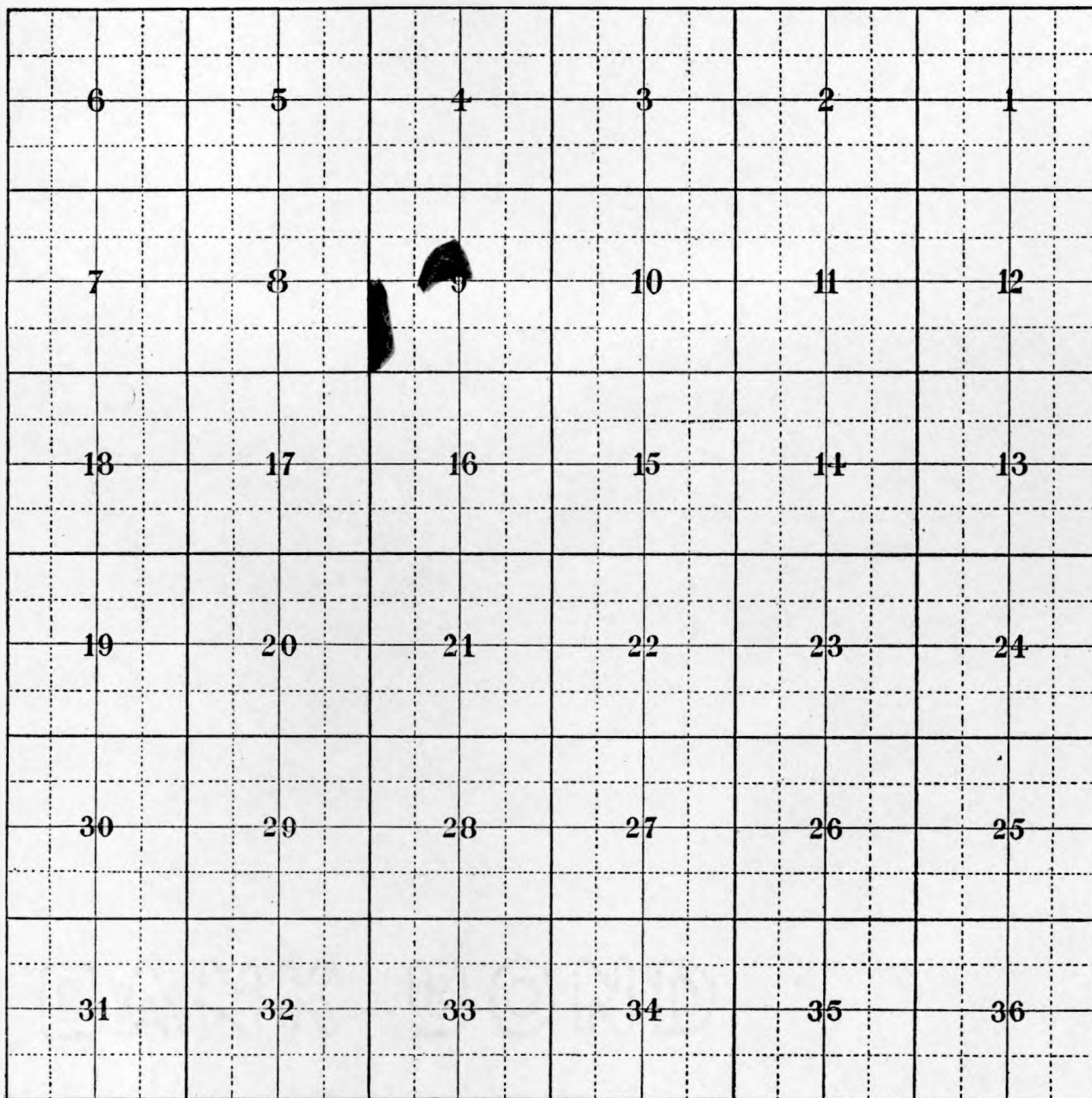

LEGEND

Stenglein Bindery, Marquette, Mich.

- C.C.I. Co. owns all timber and second growth reserved in sale to The Cliffs Power & Light Co. Reserved for 50 years to July 28th, 1976.

THE CLEVELAND-CLIFFS IRON COMPANY
Land Department

STATEMENT OF TAXES PAID YEARS 1941 AND 1940 SHOWING DIVISION BETWEEN
TOWN LOTS AND ACREAGE

DESCRIPTION	ACREAGE		VALUATION				TAXES PAID			
	1941	1940	PER ACRE		AMOUNT		PER ACRE		AMOUNT	
			1941	1940	1941	1940	1941	1940	1941	1940
AuTrain Township	21,817.84	21,817.84	\$ 5.62	\$ 5.67	\$120,556.00	\$123,740.00	.085	.089	\$1,826.60	\$1,905.03
AuTrain Township, Personal	-	-	-	-	2,020.00	2,670.00	-	-	30.61	40.46
Burt Township	73,830.80	73,830.80	11.61	11.35	857,487.50	838,550.00	.268	.262	19,751.34	19,315.04
Grand Island Township	13,084.41	13,084.41	16.26	16.26	212,770.00	212,770.00	.131	.213	1,719.73	2,793.67
Grand Island Township, Personal	-	-	-	-	7,000.00	7,000.00	-	-	56.00	91.91
Limestone Township	1,155.87	1,315.87	3.36	3.52	3,880.00	4,630.00	.051	.053	59.06	70.14
Mathias Township	8,709.13	8,709.13	5.03	6.35	43,800.00	55,300.00	.080	.101	692.69	875.62
Munising Township	34,631.58	34,711.58	8.68	8.97	300,600.00	311,517.50	.140	.148	4,860.03	5,122.90
Munising Township, Personal	-	-	-	-	12,510.00	11,400.00	-	-	202.22	172.76
Munising City Lots	-	-	-	-	28,385.00	27,795.00	-	-	974.47	1,132.28
Munising City, Acreage Property	1,961.94	1,962.44	20.43	24.87	40,080.00	48,780.00	.701	.830	1,375.35	1,638.91
Munising City, Personal	-	-	-	-	16,300.00	17,800.00	-	-	559.24	579.41
Onota Township	13,639.32	13,639.32	14.49	14.71	197,565.00	200,685.00	.219	.223	2,993.72	3,037.73
Onota Township, Personal	-	-	-	-	1,500.00	-	-	-	22.72	-
Rock River Township, Lots	-	-	-	-	250.00	250.00	-	-	3.80	3.79
Rock River Township, Acreage Property	2,306.12	2,306.12	6.42	7.03	14,800.00	16,200.00	.097	.106	224.31	245.51
Arvon Township	-	4,450.88	-	30.10	-	133,955.00	-	.469	-	2,088.93
Baraga Township	40.00	40.00	10.00	-	400.00	-	.179	-	7.16	-
L'Anse Township	-	3,913.21	-	12.33	-	48,250.00	-	-	-	1,157.45
Spurr Township	120.00	120.00	3.75	5.00	450.00	600.00	.095	.089	11.45	10.67
Bay Mills Township	40.00	40.00	6.25	6.25	250.00	250.00	.095	.095	3.79	3.79
Hulbert Township	171.26	171.26	20.43	20.43	3,500.00	3,500.00	.309	.309	53.07	53.04
Superior Township	2,277.22	2,277.22	7.47	7.73	17,000.00	17,600.00	.113	.118	257.55	266.81
Trout Lake Township	132.40	132.40	16.10	16.10	2,125.00	2,125.00	.243	.243	32.21	32.09
Whitefish Township	298.81	298.81	21.74	21.74	6,500.00	6,400.00	.253	.269	75.50	80.41
Fairbanks Township	1,335.44	1,335.44	4.57	4.19	6,100.00	5,600.00	.069	.063	92.44	84.83
Garden Township	3.92	3.92	102.04	102.04	400.00	400.00	1.536	1.536	6.02	6.02
Gladstone City, Lots	-	-	-	-	1,500.00	800.00	-	-	29.75	24.05
Maple Ridge Township	40.00	40.00	15.00	12.50	600.00	500.00	.326	.272	13.03	10.86
Masonville Township	56.60	56.60	4.00	4.00	225.00	225.00	.060	.060	3.41	3.41
Wells Township	80.00	80.00	3.75	3.75	300.00	300.00	.049	.049	3.94	3.94
Crystal Falls Township	80.00	80.00	2.50	3.13	200.00	250.00	.063	.063	5.00	5.06
Mansfield Township	-	36.23	-	96.88	-	3,510.00	-	4.894	-	177.26
Columbus Township	28,324.47	32,525.50	16.44	11.41	465,727.50	470,975.00	.249	.219	7,056.27	7,135.73
McMillan Township	63,160.69	63,560.69	15.47	15.42	977,075.00	980,326.00	.234	.237	14,804.63	14,855.44
Pentland Township	120.00	120.00	2.50	2.50	300.00	300.00	.038	.038	4.55	4.55
Champion Township	2,710.95	2,710.95	6.18	6.18	16,750.00	16,750.00	.152	.150	412.79	406.16
Chocolate Township	2,814.30	2,814.30	3.23	3.23	8,920.00	9,080.00	.048	.049	135.14	137.56
Ely Township	3,780.43	3,780.43	6.99	6.99	26,300.00	26,350.00	.096	.093	363.91	351.30
Forsyth Township	2,772.62	2,772.62	3.13	3.37	8,670.00	9,370.00	.067	.072	184.73	198.53
Ishpeming Township	6,543.55	6,543.55	4.70	4.70	30,695.00	30,775.00	.097	.100	632.86	653.76
Ishpeming City, Lots	-	-	-	-	6,450.00	8,600.00	-	-	222.92	299.54
Ishpeming City, Acreage Property	1,905.27	1,905.27	27.51	28.27	52,400.00	53,850.00	.985	.984	1,876.43	1,875.05
Marquette Township	6,115.62	6,115.62	7.78	7.78	47,575.00	47,575.00	.067	.067	720.79	720.79
Marquette City, Lots	-	-	-	-	165.00	165.00	-	-	4.62	4.11
Marquette City, Acreage Property	471.28	471.28	10.44	10.44	4,885.00	4,875.00	.289	.258	136.02	121.64
Michigamme Township	899.14	1,672.89	9.78	10.13	8,790.00	16,940.00	.342	.358	308.09	598.83
Negaunee Township	3,532.02	3,532.02	11.52	11.52	40,360.00	40,685.00	.255	.286	901.89	1,010.76
Negaunee City, Lots	-	-	-	-	76,105.00	76,500.00	-	-	2,552.93	2,703.77
Negaunee City, Acreage Property	2,118.25	2,118.25	23.97	23.97	50,775.00	50,775.00	.804	.849	1,703.17	1,799.15

STATEMENT OF TAXES PAID YEARS 1941 AND 1940 SHOWING DIVISION BETWEEN
TOWN LOTS AND ACREAGE (CONTINUED)

DESCRIPTION	ACREAGE		V A L U A T I O N				T A X E S P A I D			
	1941	1940	PER ACRE		AMOUNT		PER ACRE		AMOUNT	
			1941	1940	1941	1940	1941	1940	1941	1940
Negaunee City, Personal	-	-	-	-	\$ 500.00	\$ 500.00	-	-	\$ 16.78	\$ 17.73
Powell Township	13,095.27	17,883.46	\$14.80	\$13.56	193,560.00	242,440.00	\$.329	\$.301	4,300.91	5,387.01
Humboldt Township	103.40	103.40	7.73	7.73	800.00	800.00	.117	.117	12.12	12.12
Republic Township	1,119.70	1,146.50	5.13	5.19	5,750.00	5,950.00	.140	.119	156.24	136.37
Richmond Township	5,827.46	5,867.46	5.45	5.43	31,752.38	31,843.12	.149	.114	870.93	664.89
Sands Township	4,041.69	4,041.69	8.98	8.98	36,315.00	36,315.00	.204	.203	825.29	819.94
Skandia Township	9,587.05	9,587.05	11.83	13.11	113,400.00	125,700.00	.180	.199	1,726.15	1,906.08
Tilden Township	4,436.21	4,436.21	9.64	9.65	42,410.00	42,810.00	.189	.160	835.38	709.43
Turin Township	2,000.00	5,243.13	5.61	3.95	11,225.00	20,725.00	.085	.096	170.12	504.94
West Branch Township	2,106.37	2,106.37	9.33	16.22	19,650.00	34,150.00	.180	.450	375.96	947.32
Hiawatha Township	5,305.82	5,305.82	8.97	9.44	47,600.00	50,100.00	.136	.143	722.31	759.15
Inwood Township	55.78	55.78	9.68	9.68	540.00	540.00	.259	.435	14.45	24.27
Seney Township	16,641.59	16,641.59	5.15	5.14	85,680.00	85,480.00	.078	.078	1,298.04	1,295.04
Lac La Belle (Hardwood Saw Timber)					2,375.00				36.92	471.18
TOTALS	365,401.59	387,515.31			\$4,312,553.38	\$4,624,396.62			\$79,329.55	\$87,565.92
R E C A P I T U L A T I O N										
Acreage Property (Lands)					\$4,161,373.38	\$4,471,116.62			\$74,653.49	\$82,496.11
City Lots					111,350.00	113,910.00			3,788.49	4,167.54
Personal					39,830.00	39,370.00			887.57	902.27
TOTALS					\$4,312,553.38	\$4,624,396.62			\$79,329.55	\$87,565.92

CAJ:HW-3
2/4/42

THE CLEVELAND-CLIFFS IRON COMPANY
Land Department

ANNUAL DETAILED STATEMENT OF TAXES PAID -- YEARS 1941 AND 1940

	Valuations		Taxes Paid	
	1941	1940	1941	1940
<u>CHARGED TO OPERATING ACCOUNTS</u>				
Central Office Expense	\$11,000.00	\$11,000.00	\$ 368.95	\$ 389.75
Rented Buildings	40,740.00	41,120.00	1,375.52	1,444.57
Grand Island	19,950.00	19,950.00	161.20	261.95
Hotel Williams and Cottages	28,000.00	28,000.00	226.24	367.64
Retail Yard	33,250.00	33,250.00	1,140.77	1,082.28
Idle Expense - Logging Operations	19,670.00	19,670.00	317.67	298.06
Land Department - General	3,882,852.03	4,187,089.47	70,097.67	77,506.14
<u>Total Charged to Operations</u>	<u>\$4,035,462.03</u>	<u>\$4,340,079.47</u>	<u>\$73,688.02</u>	<u>\$81,350.39</u>
<u>ACCOUNTS RECEIVABLE</u>				
Land Rents Receivable	\$ 118,751.35	\$ 114,596.65	\$ 2,837.99	\$ 2,694.21
Real Estate Sales Receivable	16,467.50	24,388.00	255.13	750.37
Timber Sales Receivable	114,062.50	114,282.50	1,919.09	1,915.96
Land Products Sales Receivable	25,210.00	25,210.00	565.23	625.15
Deferred Accounts Receivable	-	830.00	-	29.02
S. L. Mather et al	1,100.00	1,100.00	21.66	18.23
H. A. Raymond	400.00	400.00	5.53	5.33
The Negaunee Mine Company	1,100.00	-	36.90	-
Wisconsin Michigan Power Co. (Option)	-	3,510.00	-	177.26
<u>Total Accounts Receivable</u>	<u>\$ 277,091.35</u>	<u>\$ 284,317.15</u>	<u>\$5,641.53</u>	<u>\$ 6,215.53</u>
<u>GRAND TOTAL</u>	<u>\$4,312,553.38</u>	<u>\$4,624,396.62</u>	<u>\$79,329.55</u>	<u>\$87,565.92</u>
1941 Taxes to be Paid in January, 1942, by Cleveland Office Checks			\$79,151.83	\$86,998.32
1941 Taxes paid in July, 1941--Marquette City Treasurer			103.33	84.42
1941 Taxes Paid in July, 1941--Gladstone City Treasurer			14.75	12.00
1941 Taxes Paid The Munising Paper Company on certain Lac La Belle Lands			36.92	35.99
1941 Taxes Paid Onota Township Treasurer in December, 1941			22.72	-
1940 Taxes Paid Seney Township Treasurer on Lac La Belle Lands			-	3.03
1940 Taxes Paid Burt Township Treasurer on Lac La Belle Lands			-	432.16
			<u>\$79,329.55</u>	<u>\$87,565.92</u>

LED: MJ-5
2/23/42

THE CLEVELAND-CLIFFS IRON COMPANY
Land Department

ALGER COUNTY
COMPARATIVE ASSESSED VALUATIONS

Township or City	1 9 4 1			1 9 4 0		
	Acres	Valuation	%	Acres	Valuation	%
AuTrain Township	91,824.95	\$ 465,898.00	7.12	91,945.98	\$ 469,145.00	7.00
Burt Township	113,600.00	1,247,175.00	19.05	115,059.88	1,285,220.00	19.19
Grand Island Township	13,789.44	249,445.00	3.81	13,789.44	249,445.00	3.72
Limestone Township	32,715.36	188,135.00	2.87	47,361.66	235,822.00	3.53
Mathias Township	45,404.43	271,475.00	4.15	45,409.08	277,800.00	4.14
Munising Township	54,796.63	544,390.00	8.32	54,796.63	571,155.00	8.52
Onota Township	56,212.40	549,155.00	8.39	56,182.59	627,875.00	9.37
Rock River Township	51,527.32	408,615.00	6.24	51,527.29	406,530.00	6.08
City of Munising		2,621,530.00	40.05		2,575,900.00	38.45
	459,870.53	\$6,545,818.00	100.00	476,072.55	\$6,698,892.00	100.00

MLJ:HW-3
2/6/42

THE CLEVELAND-CLIFFS IRON COMPANY
Land Department

ALGER COUNTY COMPARATIVE TAX STATEMENT

Township or City	County Tax		Township and City Taxes		Total Taxes	
	1941	1940	1941	1940	1941	1940
AuTrain Township	\$ 3,727.18	\$ 3,753.16	\$ 3,274.59	\$ 3,316.76	\$ 7,001.77	\$ 7,069.92
Burt Township	9,929.40	10,281.76	18,405.28	19,109.40	28,334.68	29,391.16
Grand Island Township	1,995.56	1,995.56	-	1,247.22	1,995.56	3,242.78
Limestone Township	1,505.08	1,886.58	1,324.90	1,655.56	2,829.98	3,542.14
Mathias Township	2,171.80	2,222.40	2,053.20	2,089.13	4,225.00	4,311.53
Munising Township	4,355.12	4,569.24	4,362.43	4,019.27	8,717.55	8,588.51
Onota Township	4,393.24	5,023.00	3,857.25	4,402.74	8,250.49	9,425.74
Rock River Township	3,268.92	3,252.24	2,863.15	2,877.27	6,132.07	6,129.51
City of Munising	20,972.24	20,607.20	68,963.03	63,230.50	89,935.27	83,837.70
Totals	\$52,318.54	\$53,591.14	\$105,103.83	\$101,947.85	\$157,422.37	\$155,538.99

MLJ:HW-3
2/9/42

THE CLEVELAND-CLIFFS IRON COMPANY
Land Department

CITY OF MUNISING TAXES

	1941	1940
Assessed Valuation	\$2,621,530.00	\$2,575,900.00
County Taxes	20,972.24	20,607.20
City Taxes	68,963.03	63,230.50
Total	89,935.27	83,837.70
	Increase 6,097.57	Decrease 2,845.72
Tax Rate per \$100.00 Valuation	\$3.4306405	\$3.2546954

ALGER COUNTY TAXES

Assessed Valuation	\$6,545,818.00	\$6,698,892.00
County Tax	52,318.54	53,591.14
Township and City Taxes	105,103.83	101,947.85
Total Taxes	157,422.37	155,538.99
Rate of County Tax per \$100.00 Valuation	\$.7992666	\$.8000000
County Tax	Decrease 1,272.60	Decrease 6,563.86
All Taxes--Entire County	157,422.37 Increase 1,883.38	155,538.99 Decrease 7,497.31

MLJ:HW-3
2/9/42

THE CLEVELAND-CLIFFS IRON COMPANY
Land Department

GRAND ISLAND

		1941	1940
The C. C. I. Co.--Grand Island			
Acres	12,857.90		
Valuation		\$210,220.00	\$210,220.00
Total Taxes Paid		1,698.57	2,760.19
The C. C. I. Co.--Wood Island			
Acres	188.09		
Valuation		1,900.00	1,900.00
Total Taxes Paid		15.35	24.91
The C. C. I. Co.--Williams Island			
Acres	32.80		
Valuation		400.00	400.00
Total Taxes Paid		3.23	5.25
The C. C. I. Co.--Main Land			
Acres	5.62		
Valuation		250.00	250.00
Total Taxes Paid		2.02	3.28
The C. C. I. Co.			
Personal Property Valuation		7,000.00	7,000.00
Personal Property Taxes Paid		56.56	91.91
Grand Total Taxes, Grand Island Township, Paid by The C. C. I. Co.		1,775.73	2,885.58
Others--Grand Island			
Acres	213.20		
Valuation		2,100.00	2,100.00
Taxes		16.97	27.57
Others--Grand Island			
Personal Property Valuation		17,150.00	17,150.00
Taxes		138.57	225.18
Others--Main Land			
Acres	737.27		
Valuation, Real Estate		10,075.00	10,075.00
Taxes		81.41	132.28
Others--Main Land			
Personal Property Valuation		350.00	350.00
Taxes		2.83	4.60

SHEET NO. 2

	1941	1940
Total Valuation--Grand Island		
Real Estate	\$212,320.00	\$212,320.00
Personal Property	24,150.00	24,150.00
<u>Total</u>	236,470.00	236,470.00
Total Taxes--Grand Island		
Real Estate	1,715.54	2,787.76
Personal Property	195.13	317.09
<u>Total</u>	1,910.67	3,104.85
Total Valuation--Wood Island	1,900.00	1,900.00
Total Taxes	15.35	24.91
Total Valuation--Williams Island	400.00	400.00
Total Taxes	3.23	5.25
Total Valuation--Main Land		
Real Estate	10,325.00	10,325.00
Personal Property	350.00	350.00
<u>Total</u>	10,675.00	10,675.00
Total Taxes--Main Land		
Real Estate	83.43	135.56
Personal Property	2.83	4.61
<u>Total</u>	86.26	140.17
Total Acres--Grand Island	14,034.88	
Total Valuation--Grand Island Township		
Township	224,945.00	224,945.00
Personal Property	24,500.00	24,500.00
<u>Total</u>	249,445.00	249,445.00
Total Taxes--Grand Island Township		
Real Estate	1,817.55	2,953.52
Personal Property	197.96	321.69
<u>Total</u>	2,015.51	3,275.21

MLJ:HW-3
2/7/42

THE CLEVELAND-CLIFFS IRON COMPANY
Land Department

VALUATIONS OF MANUFACTURING SITES—CITY OF MUNISING

	1941	1940
The Munising Paper Company		
Site	\$ 795,960.00	\$ 795,550.00
Personal	335,000.00	340,000.00
The Cleveland-Cliffs Iron Company		
Sawmill		
Site	17,250.00	17,250.00
Personal	16,000.00	16,000.00
Other Property		
Real	51,215.00	58,165.00
Personal	300.00	300.00
Total—The Cleveland-Cliffs Iron Co.	84,765.00	91,715.00
Munising Wood Products Co. (The C.C.I.Co.)		
Site	39,500.00	39,620.00
Personal	24,000.00	24,000.00
Atlas Plywood Corporation		
Site	20,770.00	18,200.00
Personal	6,000.00	3,000.00
First National Bank		
Site	36,050.00	23,000.00
Personal	-	-
Peoples State Bank		
Site	6,450.00	6,450.00
Personal	-	-
Michigan Gas & Electric Company		
Site	15,000.00	16,000.00
Personal	56,800.00	56,800.00
Jackson and Tindle		
Site	25,000.00	25,000.00
Personal	-	5,000.00
TOTAL VALUATIONS—SITES		
Real Estate	1,007,195.00	999,235.00
Personal	438,100.00	445,100.00
Total	1,445,295.00	1,444,335.00
TOTAL VALUATION—CITY OF MUNISING		
Real Estate	2,002,980.00	1,956,350.00
Personal	618,550.00	619,550.00
Total	2,621,530.00	2,575,900.00

VALUATIONS OF MANUFACTURING SITES--CITY OF MUNISING

SHEET NO. 2

	1941	1940
Munising City Taxes		
County	\$20,972.24	\$20,607.20
County Debt	-	-
City	45,975.00	40,205.00
City Debt	9,225.00	9,495.00
School	13,763.03	13,523.47
Rejected	-	7.03
Total	89,935.27	83,837.70
Tax Rate per \$100.00 Valuation	3.43064	3.25469
Amount Paid by Above Industries	49,582.88	47,008.63
Amount Paid by Others	40,352.39	36,829.07
Per Cent Paid by Above Industries	55.13	56.07
Per Cent Paid by Others	44.87	43.93
The Munising Paper Company	43.14	44.09
The Cleveland-Cliffs Iron Company		
Sawmill	1.27	1.29
Other Property	<u>1.97</u>	<u>2.27</u>
Total--The Cleveland-Cliffs Iron Co.	3.24	3.56
Munising Wood Products Co. (The C.C.I.Co.)	2.42	2.47
Atlas Plywood Corporation	1.02	.82
Jackson & Tindle	.95	1.16
First National Bank	1.37	.89
Peoples State Bank	.25	.25
Michigan Gas & Electric Company	2.74	2.83

MLJ:HW-3
2/10/42

THE CLEVELAND-CLIFFS IRON COMPANY
Land Department

ALGER COUNTY COMPARATIVE VALUATIONS AND TAXES

Township or City	1	9	4	1	1	9	4	0
	Valuation		Tax	Rate	Valuation	Tax		Rate
AuTrain Township	\$ 465,898.00	\$	7,001.77	.0150285	\$ 469,145.00	\$	7,069.92	.0150698
Burt Township	1,241,175.00		28,334.68	.0228289	1,285,220.00		29,391.16	.0228686
Grand Island Twp.	249,445.00		1,995.56	.0080000	249,445.00		3,242.78	.0130000
Limestone Township	188,135.00		2,829.98	.0150423	235,822.00		3,542.14	.0150216
Mathias Township	271,475.00		4,225.00	.0155631	277,800.00		4,311.53	.0155202
Munising Township	544,390.00		8,717.55	.0160134	571,155.00		8,588.51	.0150371
Onota Township	549,155.00		8,250.49	.0150240	627,875.00		9,425.74	.0150121
Rock River Township	408,615.00		6,132.07	.0150070	406,530.00		6,129.51	.0150776
City of Munising	2,621,530.00		89,935.27	.0343064	2,575,900.00		83,837.70	.0325469
Totals	6,539,818.00		157,422.37	.0240714	6,698,892.00		155,538.99	.0232186
Marquette County	50,792,437.00		1,433,780.64	.0282282	50,884,042.00		1,416,562.31	.0278390
Luce County	5,442,440.00		74,559.53	.0136997	4,883,830.00		73,257.45	.0149846

MLJ:HW-3
2/9/42

THE CLEVELAND-CLIFFS IRON COMPANY
Land Department

ANNUAL COMPARATIVE STATEMENT OF PERSONAL INJURY EXPENSE
YEARS 1941 - 1940

Acc. No.	Name of Injured	Date of Injury	Department	Occupation	Location	C or N/C	Hospital, Medical & Misc.	Compensation	Total Expense for the Year	Status, as of December 31, 1941
1511	Ben Gasper	1/20/33	Logging	Teamster	Camp 154-1	C		\$ 21.00	\$ 21.00	Closed
1789	Eino Karasti	5/21/36	"	Sawyer	Camp 196-8	C		936.00	936.00	Open
1794	Albert R. Bovan	3/28/36	"	Loader Engr.	Camp 196-9	C		2,236.56	2,236.56	Closed
1816	Dan Hell	9/16/36	"	Teamster	Camp 196-8	C		482.56	482.56	Open
1841	John M. Maki	11/21/36	"	B.S.Helper	Camp 196-8	C		321.88	321.88	Open
2033	Salomon Mekela	11/10/38	Grand Island	Laborer	Grand Island	C		224.12	224.12	Open
2036	Arne J. Vartti	10/18/39	Logging	Sawyer	Jansen & Wikstrom	C		936.00	936.00	Open
TOTAL EXPENSE IN 1941 ON PREVIOUS YEARS' CASES								\$5,158.12	\$5,158.12	
2048	Frank L. Beshaw	6/11/41	Land Oprtg.	Carpenter	Negaunee	C		522.00	522.00	Open
2049	Fred Bonner	6/12/41	Retail Yard	Handling Lbr	Munising	N/C	\$ 2.00		2.00	Closed
2050	Arnold Steinhoff	10/24/41	" "	Machine Feeder	"	N/C	14.50		14.50	Closed
2051	James E. LaCombe	12/ 3/41	" "	Truck Driver	"	N/C				Open for Medical Charge
2052	Fred Bonner	12/ 4/41	" "	Handling Lbr.	"	N/C				Open for Medical Charge
TOTAL EXPENSE IN 1941 ON 1941 CASES								\$16.50	\$522.00	\$538.50
GRAND TOTAL EXPENSE - YEAR 1941								\$16.50	\$5,691.2	\$5,696.62

DETAIL OF HOSPITAL, MEDICAL & MISC. EXPENSE		1941	1940	ANALYSIS OF ACTUAL COST		1941	1940
Hospitals				Hospital, Medical & Misc. Expense		\$16.50	\$1,185.29
Munising Hospital, Munising, Mich.		\$ 5.00	\$ 10.00	Compensation Payments		5,680.12	3,759.29
St. Luke's Hospital, Marquette, Mich.			511.75	Total Actual Expense		\$5,696.62	\$4,944.58
Ishpeming Hospital, Ishpeming, Mich.			112.29	STATISTICAL INFORMATION			
Total Hospital		\$ 5.00	\$634.04	Payroll, All Operations		\$103,014.19	\$91,327.56
Doctors				Rate per \$100.00 of Payroll		5.53	5.42
G. B. Wickstrom, M.D., Munising, Mich.		\$11.50	\$ 20.00	Compensable Accidents		1	1
Harry B. McCrary, M.D., " "			3.00	Non-Compensable Accidents		4	10
B. C. Barron, M. D., " "			2.00	Total Number of Accidents		5	11
O. I. Niemi, M.D., Marquette, Mich.			315.00	Average number of employees		55	54
E. R. Elzinka, M.D., " "			158.00	Total Cost per Person Employed		\$103.57	\$91.56
W. A. Corcoran, M.D., Ishpeming, Mich.			15.00	No. of Accidents per person employed		.09	.20
Percy P. Hartt, M.D., " "			18.50				
A. W. Erickson, M.D., " "			5.00				
Total Doctors		\$11.50	\$536.50				
Expense of Injured to Doctors for Examination			14.00				
Drugs			.75				
GRAND TOTAL HOSPITAL, MEDICAL & MISC. EXPENSE		\$16.50	\$1,185.29				

THE CLEVELAND-CLIFFS IRON COMPANY
Land Department

OUTGOING LETTERS -- NEGAUNEE OFFICE

Month	1937	1938	1939	1940	1941
January	815	879	815	898	799
February	762	679	606	743	601
March	760	1,055	559	739	790
April	859	870	745	710	829
May	700	826	1,026	1,107	727
June	947	920	793	951	926
July	1,014	962	752	1,007	1,064
August	920	1,054	731	991	881
September	671	908	647	838	882
October	1,181	939	953	821	836
November	1,039	895	725	803	599
December	1,125	889	887	834	879
Totals	10,793	10,876	9,239	10,442	9,813

HW
1/8/42

ARCTIC IRON COMPANY

ANNUAL DETAILED STATEMENT OF TAXES PAID -- YEARS 1941 AND 1940

DESCRIPTION	V A L U A T I O N				T A X E S P A I D						
	ACREAGE		PER ACRE		AMOUNT		PER ACRE		AMOUNT		
	1941	1940	1941	1940	1941	1940	1941	1940	1941	1940	
Negaunee City											
Arctic Iron Company--Fee	-	9.00	-	\$6,111	-	\$55,000.00	-	\$216.511	-	\$1,948.70	
The Cleveland-Cliffs Iron Co. and Arctic Iron Co.	439.07	439.07	\$21.87	217	\$9,600.00	9,600.00	\$.734	.776	\$322.04	340.70	
Negaunee Township											
The Cleveland-Cliffs Iron Co. and Arctic Iron Co.	371.14	371.14	4.72	42	1,750.00	1,750.00	.105	.118	38.88	43.67	
Sands Township											
The Cleveland-Cliffs Iron Co. and Arctic Iron Co.	32.12	32.12	3.11	3.1	100.00	100.00	.071	.071	2.27	2.27	
TOTALS	842.33	851.33	\$13.60	\$785	\$11,450.00	\$66,450.00	\$.431	\$ 2.743	\$563.19	\$2,335.34	

GAJ:HW-5
2/4/42

ARCTIC IRON COMPANY
Land Department

LAND ACREAGE

DECEMBER 31, 1941

Town	Range	Unplatted Lands		Platted Lands	Total	Minerals Reserved in Sales
		Fee	Minerals	Minerals		
47	25	32.12			32.12	
47	26	800.36	4.43	88.03	892.82	103.06
48	26	148.00	33.55	15.50	197.05	
		980.48	37.98	103.53	1,121.99	103.06

CAJ:HW-3
2/4/42

THE ATHENS IRON MINING COMPANY
Land Department

LAND RENTS RECEIVABLE--DEC. 31, 1941

Lease No.	Parcel No.	Lessee	Rental Due	Rental Paid to	Remarks
3828	119	Mike Airaudi	\$ 6.00	1/1/36	Expect to collect in 1942.
3829	120	Ernest Lajoie	2.00	1/1/40	do.
4963		Victor Maki	2.92	8/1/42	Paid in advance.
3832	202	Mrs. Tilda Lahti	3.00	1/1/39	Expect to collect in 1942.
3884	231-232	Paul Smith	4.00	1/1/40	do.
3741	234	August Goyette	1.67	5/1/42	Paid in advance.
3977	S $\frac{1}{2}$ 235	John Chiri	2.00	1/1/41	Expect to collect in 1942.
3978	N $\frac{1}{2}$ 235	John Chiri	2.00	1/1/41	do.
3980	237	Mrs. Tilda Lahti	8.00	1/1/32	"
4431	241	Mrs. Tilda Lahti	13.00	10/1/35	"
			\$35.41		

Typed by
HW -6
2/19/42

SUPERIOR REALTY COMPANY
Land Department

STATEMENT OF LAND AND TIMBER SALES FOR YEAR 1941

Conv. No.	Purchaser	Description	Acreage	Amount of Sales			Remarks
				Land	Timber	Total	
7065	Charles E. Ruesing	SE $\frac{1}{4}$ of NW $\frac{1}{4}$ and N $\frac{1}{2}$ of SW $\frac{1}{4}$, Section 17-47-25	160.00	-	\$325.00	\$325.00	Timber Only.
7073	Harry Schmidt	S $\frac{1}{2}$ of NW $\frac{1}{4}$, Do. 12-49-10	80.00	-	350.00	350.00	Do.
7104	George Hyde	Certain lands in Sections 21, 23 & 28, 47-9	360.00	-	2,450.00	2,450.00	
7113	Hjalmer Erickson	W $\frac{1}{2}$ of NW $\frac{1}{4}$, SE $\frac{1}{4}$ of NW $\frac{1}{4}$ & NW $\frac{1}{4}$ of SW $\frac{1}{4}$, 32-47-30	160.00	-	1,050.00	1,050.00	Timber Only.
7118	State of Michigan	R.O.W. W $\frac{1}{2}$ of SE $\frac{1}{4}$, Section 4-45-23	8.12	\$40.60	159.40	200.00	Public Highway.
7129	Thomas P. Webb	NW $\frac{1}{4}$ of SE $\frac{1}{4}$, Do. 8-49-13	40.00	360.00	60.00	420.00	
7151	John Fransen	SW $\frac{1}{4}$ of NE $\frac{1}{4}$, " 34-45-25	40.00	-	100.00	100.00	Timber Only.
7173	Bryan J. Smith et al	NW $\frac{1}{4}$ of SW $\frac{1}{4}$, " 3-47-12	40.00	100.00	150.00	250.00	
7184	Tauno Kivimaki	SW $\frac{1}{4}$ of SE $\frac{1}{4}$, " 9-43-21	40.00	-	100.00	100.00	Timber Only.
7219	Michigan Pole & Tie Company	S $\frac{1}{2}$ of NE $\frac{1}{4}$, " 15-49-10	80.00	-	925.00	925.00	
7226	Leslie T. Birk	NE $\frac{1}{4}$ of NW $\frac{1}{4}$, " 20-38-19	40.00	-	100.00	100.00	Timber Only.
6632	United States of America	NW $\frac{1}{4}$ of SE $\frac{1}{4}$, " 34-46-15	40.00	40.00	24.80	64.80	
7234	Wilbert W. Gasser	Part of Lot 3, " 33-49-25		1.00	-	1.00	Q.C.D. Mineral Reservation.
7239	Joe Iajeunesse	SE $\frac{1}{4}$ of NE $\frac{1}{4}$, " 17-47-25	40.00	-	150.00	150.00	Timber Only.
7207	Wm. L. McMahon & Wife	NE $\frac{1}{4}$ of NE $\frac{1}{4}$, S $\frac{1}{2}$ of SW $\frac{1}{4}$, Sec. 14, and NE $\frac{1}{4}$ of NW $\frac{1}{4}$, Section 23, 46-12	-	10.00	-	10.00	Q.C.D. of Abandoned Lands.
TOTAL			1,128.12	\$551.60	\$5,944.20	\$6,495.80	

AJE: MJ-3
2/24/42

SUPERIOR REALTY COMPANY
Land Department

REAL ESTATE SALES RECEIVABLE--DECEMBER 31, 1941

Conv. No.	Purchaser	Date of Sale	Consideration	Terms	Date of Last Paym.	B A L A N C E D U E				Interest Paid to	Remarks
						Principal	Taxes	Interest	Total		
5990	Paul Knutson	Oct. 7, 1936	\$140.00	\$40.00 cash. Bal. \$50.00 on Dec. 7, 1937 and \$50.00 Dec. 7, 1938	6/30/38	\$100.00	\$48.65		\$148.65		Land located in Minnesota. Does not reply to our letters.
6591	Frank G. Russell Jr.	Sept. 28, 1939	320.00	\$80.00 cash. Bal. in three years.	12/11/41	80.00	8.64		88.64	9/28/41	Up to date.
7234	Wilbert W. Gasser & wife	Dec. 1, 1941	1.00	Cash	1/ 2/42	1.00			1.00		Paid in January, 1942.
						\$181.00	\$57.29		\$238.29		

Typed by
HW - 6
2/19/42

MINNEN
MINNEN
MINNEN
MINNEN

SUPERIOR REALTY COMPANY
Land Department

TIMBER SALES RECEIVABLE--DECEMBER 31, 1941

Conv. No.	Purchaser	Date of Sale	Consideration	Terms	Date of Last Payment	BALANCE DUE			Remarks	
						Principal	Taxes	Total		
5994	Joel Anderson	Oct. 10, 1936	\$ 75.00	Cash	1/ 8/41		\$ 4.26	\$ 4.26	1941 taxes	Paid in January, 1942.
6236	Hjalmer Erickson	Nov. 19, 1937	250.00	"	1/ 9/41		3.26	3.26	do.	do.
6288	Courtney Carlson	Mar. 18, 1938	125.00	"	1 /12/41		1.52	1.52	"	"
6290	Arvid Puro	Mar. 25, 1938	125.00	"	1/22/41		2.28	2.28	"	Expect taxes to be paid early in 1942.
6299	Daniel Johnston and Samuel Bernard	Apr. 27, 1938	350.00	"	12/16/40		2.27	2.27	"	Paid direct to Treasurer. Refund applied in February, 1942.
6573	Arvid Puro	Aug. 10, 1939	125.00	"	1/22/41		3.03	3.03	"	Expect taxes to be paid early in 1942.
6601	Arnold Druckenmiller Sr.	Oct. 20, 1939	250.00	"	1/ 7/41		1.82	1.82	"	Paid in January, 1942.
6636	Arvid Puro	Nov. 18, 1939	135.00	"	1/22/41		1.82	1.82	"	Expect taxes to be paid early in 1942.
6716	John T. Koski	Apr. 22, 1940	125.00	"	12/18/40		1.82	1.82	"	Paid in January, 1942.
6739	Arthur E. Antilla	May 1, 1940	275.00	"	1/26/41		3.26	3.26	"	do.
6747	Edward Maki	May 24, 1940	125.00	"	1/ 2/41		7.27	7.27	"	"
6869	Charles June	Sept. 10, 1940	50.00	"	1/24/41		2.05	2.05	"	"
7065	Charles E. Ruesing	Apr. 7, 1941	325.00	"	4/ 7/41		7.27	7.27	"	"
7113	Hjalmer Erickson	June 9, 1941	1,050.00	"	7/ 1/41		13.05	13.05	"	"
7184	Tauno Kivimaki	Sept. 12, 1941	100.00	"	9/12/41		1.52	1.52	"	"
7239	August Raatikainen	Dec. 16, 1941	150.00	"	12/16/41		1.82	1.82	"	Expect taxes to be paid early in 1942.
							\$58.32	\$58.32		

Typed by
HW - 6
2/19/42

SUPERIOR REALTY COMPANY

LAND ACREAGE			DECEMBER 31, 1941		
County	Town	Range	Fee	Surface	Minerals Reserved in Sales
Chippewa	45	1E			120.00
	45	1W			160.00
	46	1			80.00
	45	2			123.13
	46	2			3,059.00
	47	2			250.35
	46	3			2,694.31
	47	3			1,160.00
	46	4			120.00
	47	4			222.50
	45	5			800.00
	46	5			882.71
	47	5			160.00
	44	6			540.05
	45	6			2,109.99
	46	6			280.00
	45	7			671.27
46	7			640.00	
					14,073.31
Mackinac	43	5			400.00
	44	7			4,273.59
	44	8			76.88
	44	9			40.00
	43	11			320.00
					5,110.47
Luce	46	8	30.40		
	47	8	468.77		80.00
	48	8	86.36		543.63
	49	8	280.00		
	46	9			277.52
	47	9	1,136.75		2,433.79
	48	9	544.35		
	49	9	240.00		
	50	9			23.00
	45	10	80.00		640.00
	46	10			46.18
	47	10	549.16		1,530.84
	48	10	1,708.84		168.05
	49	10	240.00		110.52
	46	11	1,475.12		520.00
	47	11	393.39		319.41
	48	11	3,619.37		160.00
	49	11	40.00		
	46	12	4,924.36		247.68
	47	12	1,440.00		80.00
48	12	1,441.93			
49	12	280.00		200.00	
			18,978.80		7,380.62

LAND ACREAGE
SHEET 2

County	Town	Range	Fee	Surface	Minerals Reserved in Sales	
Schoolcraft	45	13			1,269.71	
	46	13	513.25		480.00	
	47	13	600.00			
	42	14			35.00	
	43	14			236.85	
	46	14	280.00			
	47	14	719.18		80.00	
	42	15			1,766.77	
	43	15			194.10	
	46	15	243.00			
	47	15	865.96			
	41	16			903.65	
	42	16			14.20	
	43	16	40.00		485.50	
	44	16			80.00	
	45	16			63.85	
	46	16			560.00	
	47	16			471.06	
	41	17			5,797.51	
	42	17			2,080.00	
	44	17			238.69	
	45	17			591.36	
	44	18			160.00	
	45	18			40.00	
				3,261.39		15,548.25
	Alger	48	13	424.56	40.00	
		49	13	2,461.32		412.00
		48	14	633.86	159.95	
49		14		40.00	40.00	
48		15	433.02		7,733.30	
49		15			1,840.00	
48		16			839.74	
46		17			1,663.16	
47		17			1,878.85	
46		18			5,151.31	
47		18			1,305.32	
44		19			2,641.46	
45		19			2,440.62	
46		19			11,532.04	
47		19			747.74	
44		20			797.19	
45		20			5,245.62	
46		20			10,977.12	
47		20			720.00	
44		21	480.82	119.33	3,518.80	
45		21	800.00		3,896.13	
46		21			10,990.53	
47		21			2,238.51	
44		22			6,553.63	
45		22	200.00		2,703.44	
46		22	160.00		10,696.51	
47		22	313.32	37.11	905.09	
48		22	200.00	40.00		
			6,106.90	436.39	97,468.11	

LAND ACREAGE
SHEET 3

County	Town	Range	Fee	Surface	Minerals Reserved in Sales
Delta	39	18			29.92
	41	18			960.00
	43	18			40.00
	37	19			371.50
	38	19	560.00		4,041.80
	39	19			2,078.36
	41	19			360.00
	42	19			560.00
	43	19			520.00
	38	20			358.00
	43	21	427.00		4,421.11
	41	22			214.75
	42	22			878.09
	43	22			80.00
	39	23			80.00
	40	23			160.00
	42	23	40.00		3,189.01
	43	23			1,080.00
	39	24			200.00
	41	24			400.00
			1,027.00		20,022.54
Marquette	44	23			326.53
	45	23		121.52	908.50
	46	23	161.26	439.32	1,001.95
	47	23	239.17	1,154.68	166.15
	44	24	1,600.00	2,000.87	
	45	24	80.00		120.00
	47	24	240.00		40.00
	45	25	40.00		
	47	25	1,436.59	140.00	778.67
	48	25			2,121.22
	49	25			827.87
	44	26			162.91
	45	26			1,960.82
	47	26			2,219.35
	48	26			2,110.70
	49	26			153.04
	50	26			240.00
	51	26	129.65		160.00
	46	27			40.00
	47	27			2,774.31
	48	27	1.00		3,271.85
	49	27			119.52
	50	27			180.00
	51	27	40.00		520.00
	52	27			40.00
	48	28			4.00
	50	28			160.00
	51	28	160.00		109.05
	52	28			240.00
	45	29			168.49
46	29	160.00		230.35	
47	29			80.00	

LAND ACREAGE
SHEET 4

County	Town	Range	Fee	Surface	Minerals Reserved in Sales
Marquette (Con'd)	50	29	80.00		531.40
	51	29			704.25
	52	29			
	45	30		80.00	
	46	30	40.00		345.70
	47	30		280.00	80.00
	48	30			56.00
				4,407.67	4,216.39
Iron	43	31	38.99		40.00
Baraga	47	31	515.98		38.42
	48	31	1,832.34		429.76
	52	31			40.00
	49	33			36.55
	47	34			1,926.33
	50	33			40.00
				2,348.32	
Ontonagon	48	39			711.57
	49	39			480.00
					1,191.57
Aitkin (Minn.)	50	22	200.00		934.56
	49	23			192.46
	50	23	489.09		401.69
	46	25			280.05
	47	25			39.75
	46	26			440.00
				689.09	
GRAND TOTAL			36,858.16	4,652.78	188,587.07

CAJ:HW-2
2/3/42

36,858.16
4,652.78

41,510.94

THE CLIFFS POWER AND LIGHT COMPANY
Land Department

REAL ESTATE SALES RECEIVABLE--DECEMBER 31, 1941

Conv. No.	Purchaser	Date of Sale	Consideration	Terms	Date of Last Payment	BALANCE DUE			Interest Paid to	Remarks
						Principal	Taxes	Total		
7246	Board of County Road Comm'rs of Marquette County	Dec.15, 1941	\$1.00	Cash	-	\$1.00		\$1.00	-	Expect payment in February, 1942.
7247	do.	do.	1.00	Cash	-	1.00		1.00	-	do.
7250	"	"	1.00	Cash	-	1.00		1.00	-	"
						\$3.00		\$3.00		

LED:HW-6
2/24/42

THE CLIFFS POWER & LIGHT COMPANY
Land Department

LAND RENTS RECEIVABLE—DECEMBER 31, 1941

Lease No.	Lessee	A M O U N T O W I N G			Rental Paid to	Remarks
		Rent	Taxes	Total		
1196	Conrad Steve	\$ 6.00		\$ 6.00	1/1/41	Will be paid in 1942.
1284	Conrad Steve	6.00		6.00	1/1/41	do.
1288	Ole Steve	6.00		6.00	1/1/41	"
1306	Mrs. Louis Legacy Estate	45.00		45.00	7/1/34	Will endeavor to collect in '42.
1307	James T. Neely and wife	6.00		6.00	1/1/41	Will be paid in 1942.
1311	William Maddock	6.00		6.00	1/1/41	do.
1608	Robert Sunti Estate	40.00		40.00	1/1/38	Will try to collect in 1942.
1733	Ole Steve Estate	1.00		1.00	1/1/41	Will be paid in 1942.
1734	Ole Steve Estate	3.00		3.00	1/1/41	do.
1819	John Dietrich	2.00		2.00	1/1/40	"
1820	Fred H. Berg	1.00		1.00	1/1/41	"
1835	Thomas Larmour	3.00		3.00	1/1/39	"
2515	August Luokkala	12.50		12.50	6/1/41	Paid in January, 1942.
3072	Philip Corneliuson	11.50		11.50	1/1/40	Paid in January, 1942.
3149	Negaunee Township	4.00		4.00	9/1/42	Paid in advance.
3636	Napoleon Hicks	10.00		10.00	-	Up to date.
3969	The Cleveland-Cliffs Iron Company		\$12.12	12.12		1941 taxes. Paid in Jan., 1942.
4143	Alex Orn	-	-	-	1/1/42	
4144	Philip Corneliuson	2.00		2.00	1/1/40	Paid in January, 1942.
4252	Nestor Laine	30.00	4.44	34.44	5/1/40	1941 taxes paid in Jan., 1942.
4336	Ward A. Johnson and Paul T. Moffatt	6.00		6.00	1/1/41	Will be paid in 1942.
4392	Benjamin H. Hassenger	1.00		1.00	12/1/41	do.
4439	John F. Davis	-		-	1/1/42	Up to date.
4471	Clifton Huddy	5.00		5.00	11/1/42	Paid in advance.
4639	Roland J. Devine	12.00		12.00	1/1/43	Paid in advance.
4947	Folke W. Johnson	2.50	4.44	1.94	6/1/42	1941 taxes. Rental paid in advance. 1941 taxes paid in Jan. 1942.
5097	John H. Kangas	12.00		12.00	1/1/40	Will be paid in 1942.

LAND RENTS RECEIVABLE--DECEMBER 31, 1941 (CONT'D)

Lease No.	Lessee	AMOUNT OWING			Rental Paid to	Remarks
		Rent	Taxes	Total		
5136	Gunnard J. Anderson	\$ 1.00		\$ 1.00	3/1/42	Paid in advance.
5183	Jacob A. Sailey	7.50		7.50	10/1/40	Will be paid in 1942.
5205	School District No. 1 of Forsyth Township		\$ 2.13	2.13	4/1/42	1941 taxes. Paid in Feb., 1942
5230	Arne Greyus	5.00	2.22	7.22	1/1/41	1941 taxes paid in Feb., 1942.
5239	Sam Nurmi	1.00		1.00	1/1/41	Expect to collect in 1942.
5322	Leonard C. Clapp	1.50		1.50	10/1/41	do.
5337	John F. Davis	1.00		1.00		Up to date.
2089	Felix Maki	1.00		1.00	1/1/40	Expect to collect in 1942.
2089	Felix Maki	2.00		2.00	1/1/40	do.
2094	Manus Maki	5.00		5.00	1/1/37	"
2224	Mrs. Paul Johnson	10.00		10.00	1/1/32	"
2115	Mrs. Paul Johnson	10.00		10.00		"
2117	Erick Maki	10.00		10.00	1/1/32	"
2881	Henry Wirtanen	2.00		2.00	1/1/38	"
2882	Mary Mattson	7.00		7.00	1/1/35	"
2883	Henry Wirtanen	4.00		4.00	1/1/38	"
		\$252.50	\$25.35	\$277.85		

Typed by
HW - 6
2/19/42

THE NEGAUNEE MINE COMPANY
Land Department

NEGAUNEE HOUSE SALES RECEIVABLE--DEC. 31, 1941

Conv. No.	Purchaser	Date of Sale	Consideration	Terms	Date of Last Payment	B A L A N C E D U E			Interest Paid to	Remarks		
						Principal	Taxes	Insurance				
5789	Christ Anderson	Jan. 1, 1936	\$1,800.00	\$1,080.00 cash. Bal. \$8.00 monthly.	12/16/41	\$ 344.27			\$ 344.27	12/1/41	Up to date.	
5962	Mrs. Emma Juchemich	Aug. 1, 1936	2,000.00	\$200.00 cash. Bal. \$20.00 monthly.	12/10/41	881.83			881.83	11/1/41	do.	
6154	Jalmer Erickson and wife	July 15, 1937	1,800.00	\$180.00 " " \$18.00 "	Dec., 1941	1,089.67			1,089.67	1/1/42	" Pay roll collection.	
6187	Leonard Koski and wife	July 1, 1937	2,400.00	\$240.00 " " \$24.00 "	Dec., 1941	1,581.72			1,581.72	10/1/41	Company employe. Pay roll collection.	
6380	Matt Lammi	June 16, 1938	2,400.00	\$240.00 " " \$24.00 "	Dec., 1941	1,056.68			1,056.68	1/1/42	do.	
6720	John H. Lahti and wife	May 1, 1940	2,400.00	\$240.00 " " \$24.00 "	Dec., 1941	1,897.50			1,897.50	12/1/41	"	
6728	Elmer Kangas and wife	May 1, 1940	1,600.00	\$160.00 " " \$18.00 "	Dec., 1941	1,216.32			1,216.32	12/1/41	"	
6729	Walter H. Hill and wife	May 1, 1940	2,000.00	\$200.00 " " \$20.00 "	Dec., 1941	1,569.12			1,569.12	1/1/42	"	
6730	Arthur Andrews and wife	May 1, 1940	2,100.00	\$210.00 " " \$21.00 "	Dec., 1941	1,660.27			1,660.27	12/1/41	"	
6748	Matt Aho and wife	June 1, 1940	2,400.00	\$240.00 " " \$24.00 "	Dec., 1941	1,911.95			1,911.95	12/1/41	"	
6749	Arne Jylha	June 1, 1940	1,900.00	\$140.00 " " \$14.00 "	Dec., 1941	1,115.27			1,115.27	12/1/41	"	
7087	Arthur T. Ikola and wife	May 1, 1941	2,500.00	\$250.00 " " \$25.00 "	Dec., 1941	2,153.28	\$10.78		2,164.06	1941 taxes	12/1/41	" Taxes paid in January, 1942.
7089	Wilfred J. Parkonen and wife	May 1, 1941	2,600.00	\$260.00 " " \$26.00 "	Dec., 1941	2,238.35	40.25		2,278.60	do.	12/1/41	" do.
7112	Albert H. Johnson	June 2, 1941	2,000.00	\$200.00 " " \$20.00 "	Dec., 1941	1,733.14	31.31		1,764.45	"	12/1/41	" Paid \$15.00 on account on taxes in Jan. 1942.
						\$20,449.57	\$82.34		\$20,531.91			

REAL ESTATE SALES RECEIVABLE--DECEMBER 31, 1941

7243	City of Negaunee	Dec. 10, 1941	\$ 1.00	Cash	-	\$ 1.00			\$ 1.00		Expect payment in February, 1942.
------	------------------	---------------	---------	------	---	---------	--	--	---------	--	-----------------------------------

HOUSE RENTS RECEIVABLE--DEC. 31, 1941

House No.	Name	Monthly Rental	Amount Due to 12/31/41
112	Fred Garceau	\$12.40	-
113	Albert LaForest	8.50	-
---	James L. Dompierre	20.00	-

Typed by
EM - 6
2/20/42

CALUMET AND HECLA CONSOLIDATED COPPER COMPANY

Calumet, Michigan

July 2, 1941

Mr. A. E. Petermann, President
Calumet and Hecla Cons. Copper Company
Calumet, Michigan

Dear Sir:

Herewith is report of work done during the period from January 1, 1941, to June 30, 1941 (both dates inclusive), by Calumet and Hecla on Cleveland-Cliffs lands in Sections 29 and 30, T48N-R27W, Marquette County, Michigan, under option to Lundin and Bjork and Calumet and Hecla.

Surface trenching and pitting continued throughout the period. Two men under the supervision of Frank Lundin have been continuously engaged in the work.

Efforts to discover additional mineralization in this area have been unsuccessful.

Two maps accompany this report. There is a general map showing trenching in the western forties by years, but because of the congestion on this map the operations for 1940 and 1941 are also shown on a separate print.

Yours truly,

T. M. Broderick
T. M. Broderick
Chief Geologist

TMB/P
Encs. 2

COPY HW-2

24 19
 25 N.W. COR. SEC. 30
 IRON PIN (FOUND)

R. 28 W.
 R. 27 W.

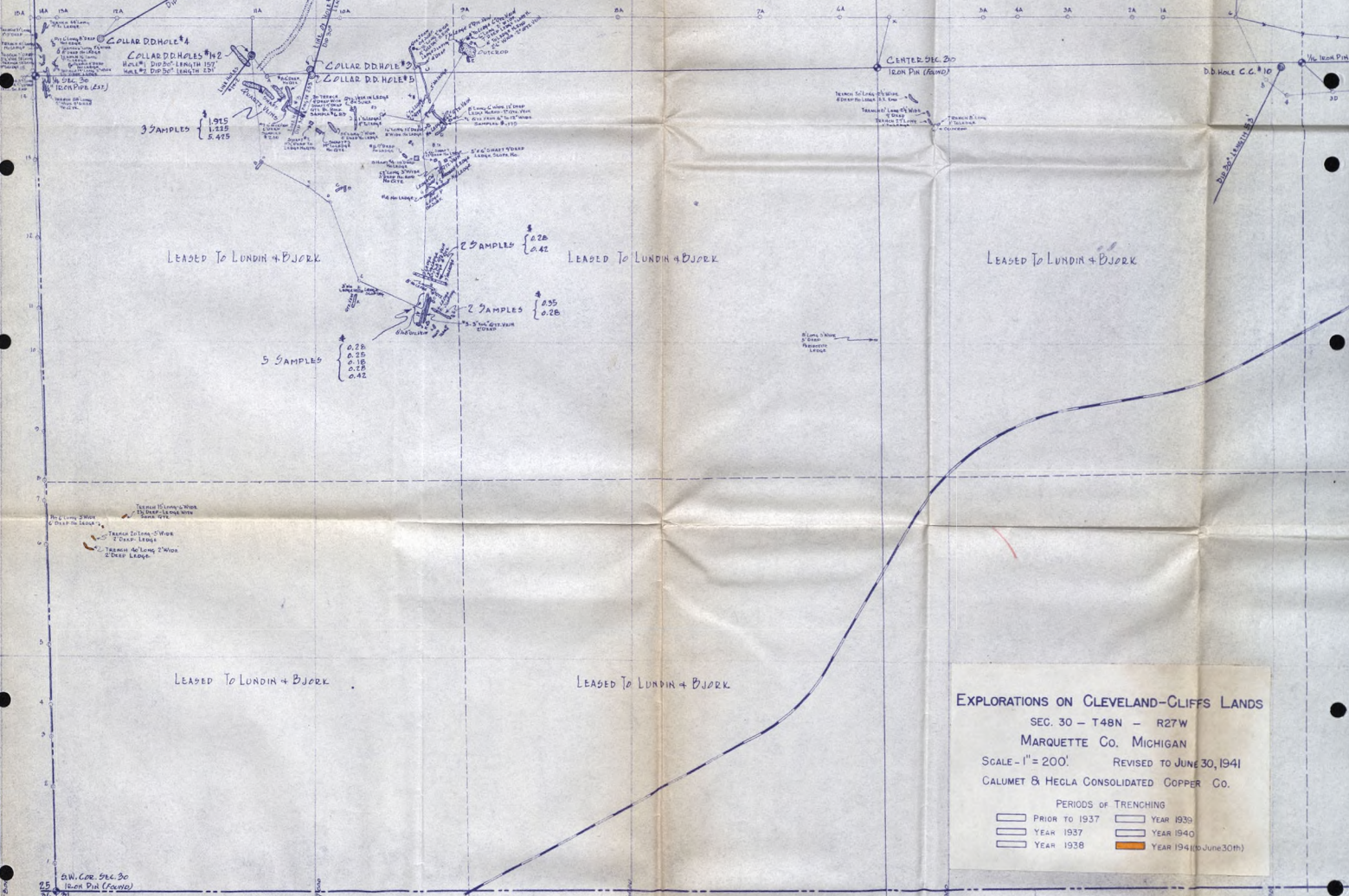

EXPLORATIONS ON CLEVELAND-CLIFFS LANDS
 SEC. 30 - T48N - R27W
 MARQUETTE CO. MICHIGAN
 SCALE - 1" = 200'
 REVISED TO JUNE 30, 1941
 CALUMET & HECLA CONSOLIDATED COPPER CO.

PERIODS OF TRENCHING
 [] PRIOR TO 1937 [] YEAR 1939
 [] YEAR 1937 [] YEAR 1940
 [] YEAR 1938 [] YEAR 1941 (to June 30th)

25 N.W. COR. SEC. 30
 IRON PIN (FOUND)
 56 91

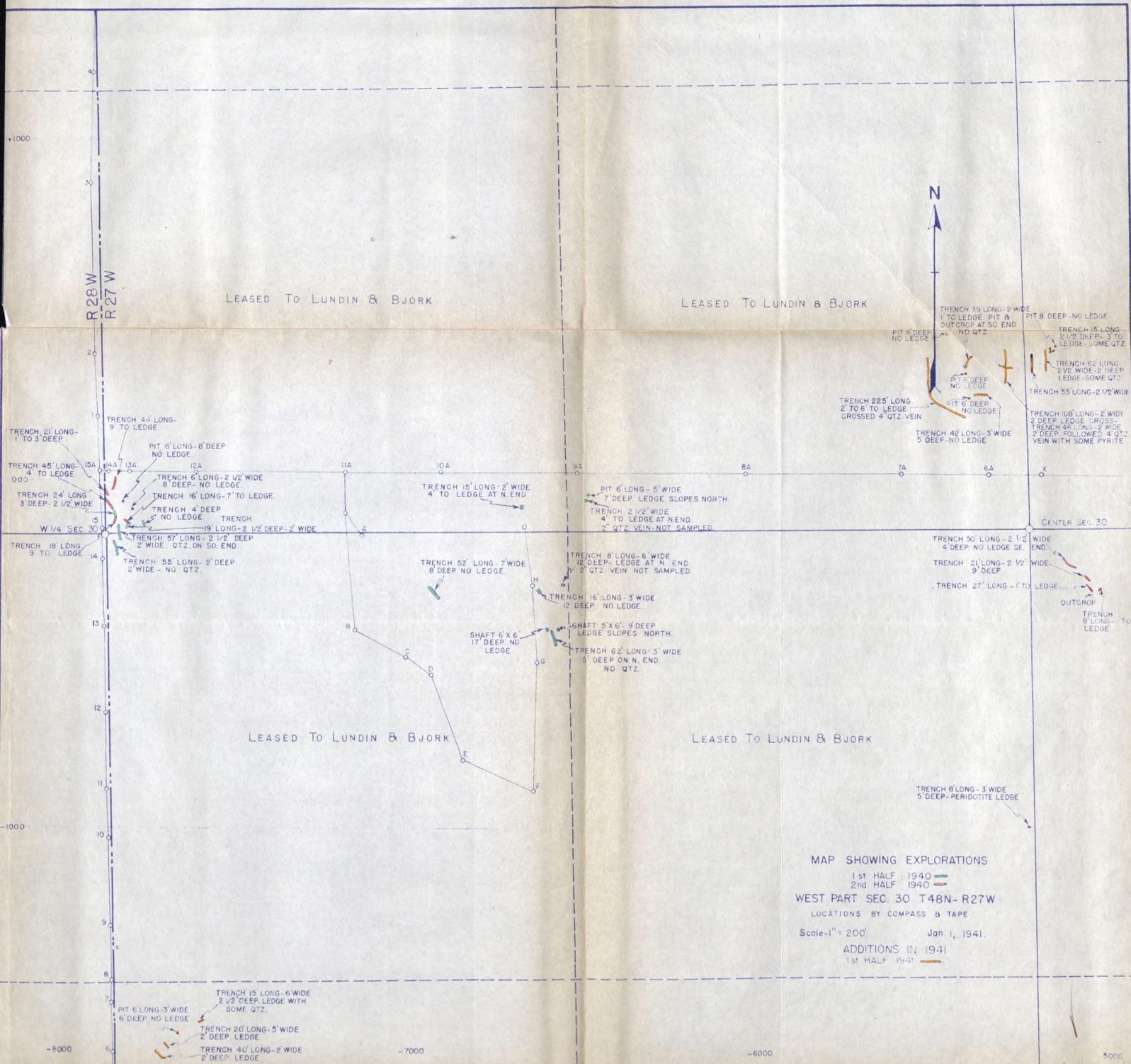

THE CLEVELAND-CLIFFS IRON COMPANY

INTER-OFFICE LETTER

MINING DEPARTMENT

Ishpeming, Michigan
August 7, 1941

Subject: LUNDIN-BJORK GOLD LEASE.

Mr. John M. Bush, Land Agent,
Negaunee, Michigan.

Dear Sir:

This will acknowledge your letter of July 10th, enclosing a copy of a report by Mr. T. M. Broderick, Chief Geologist for the Calumet and Hecla Consolidated Copper Company, dated July 2nd, together with two whiteprint maps. The report very briefly describes the exploration work done from January 1st, 1941 to June 30th, 1941, both inclusive. One whiteprint map shows all of the trenching done throughout the years this work has been carried on and the other map shows only the operation for 1940 and 1941.

I spent yesterday morning at the property with Mr. Frank Lundin, the foreman in charge. We visited much of the trenching done during 1940 and all of that done during the current year, including the work going on at present. I found two men being employed and am convinced that the terms of the option are being lived up to and that the activities, while going forward on a minimum basis, are being conducted in a workmanlike and intelligent manner.

As Mr. Broderick stated in his report, efforts to discover additional mineralization in the area being tested were unsuccessful during the first six months of the year. At the trench I visited yesterday in which the men are now working, and located in the general area near the Northwest corner of the SW $\frac{1}{4}$ of the SW $\frac{1}{4}$ of Section 30, 48-27, and where the work was done during the first half of this year, stringers of mineralized quartz were being uncovered. Not enough work has been done to estimate either the width or length of these stringers but their discovery is encouraging at least. No assays have been made as yet.

The work of trenching often is met with discouragement because the ledge surface at many points drops away very suddenly and is too steep to be reached economically by such methods. If enough encouragement can be exposed, however, undoubtedly diamond drilling will be resumed. Already there are one or two localities on the West side of Section 30 where some diamond drilling has been done and additional drilling should be done. I believe the men directing this work are mindful of this and it is not my thought to make any suggestions for the time being or until additional trenching has been done.

Yours very truly,

E. L. Derby, Jr.

Geologist

ELD:DWC
c.c.—S.R.E.

COPY HW-2

CALUMET AND HECLA CONSOLIDATED COPPER COMPANY

Calumet, Michigan

January 2, 1942

Mr. A. E. Petermann, President
Calumet and Hecla Cons. Copper Company
Calumet, Michigan

Dear Sir:

Herewith is report of work done during the period from July 1, 1941 to December 31, 1941 (both dates inclusive), by Calumet and Hecla on Cleveland-Cliffs lands in Sections 29 and 30, T48N-R27W, Marquette County, Michigan, under option to Lundin and Bjork and Calumet and Hecla.

Surface trenching and pitting continued throughout the period. Two men under the supervision of Frank Lundin have been continuously engaged in the work.

Efforts to discover additional mineralization in this area have been unsuccessful.

Two maps accompany this report. There is a general map showing trenching in the western forties by years, but because of the congestion on this map the operations for 1940 and 1941 are also shown on a separate print.

Yours truly,

(SIGNED) T. M. Broderick
T. M. Broderick
Chief Geologist

TMB/P
Encs. 2

COPY HW-2

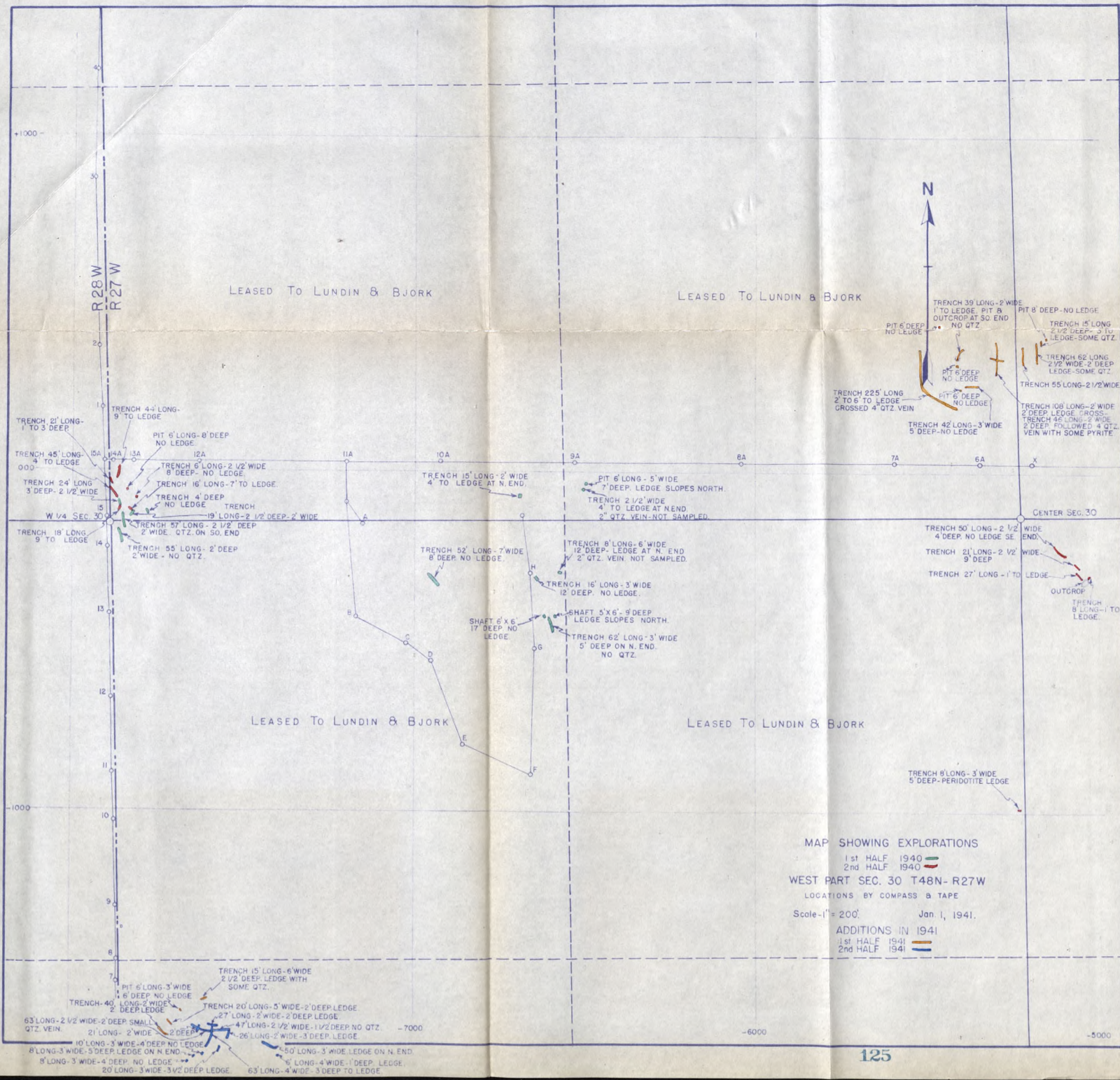

MAP SHOWING EXPLORATIONS
 1st HALF 1940
 2nd HALF 1940
 WEST PART SEC. 30 T48N-R27W
 LOCATIONS BY COMPASS & TAPE
 Scale - 1" = 200' Jan. 1, 1941.
 ADDITIONS IN 1941
 1st HALF 1941
 2nd HALF 1941

241.19
N.W. COR. SEC. 30
IRON PILE (FOUND)

R. 28 W.
R. 27 W.

LEASED TO LUNDIN & BJORK

LEASED TO LUNDIN & BJORK

LEASED TO LUNDIN & BJORK

D.D. HOLE C.C. # 8

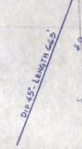

CENTER SEC. 30
IRON PILE (FOUND)

D.D. HOLE C.C. # 10

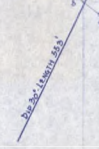

LEASED TO LUNDIN & BJORK

LEASED TO LUNDIN & BJORK

LEASED TO LUNDIN & BJORK

5 SAMPLES

2 SAMPLES
0.26
0.42

2 SAMPLES
0.35
0.28

LEASED TO LUNDIN & BJORK

LEASED TO LUNDIN & BJORK

EXPLORATIONS ON CLEVELAND-CLIFFS LANDS

SEC. 30 - T48N - R27W

MARQUETTE CO. MICHIGAN

SCALE - 1" = 200' REVISED TO DEC. 31, 1941

CALUMET & HECLA CONSOLIDATED COPPER CO.

PERIODS OF TRENCHING

- PRIOR TO 1937
- YEAR 1937
- YEAR 1938
- YEAR 1939
- YEAR 1940
- YEAR 1941

THE CLEVELAND-CLIFFS IRON COMPANY

Mining Department

Ishpeming, Michigan
January 6, 1942

Subject: Lundin-Bjork Gold Lease.

Mr. John M. Bush, Land Agent,
Negaunee, Michigan.

Dear Sir:

This will acknowledge your letter of January 5th, enclosing copy of a report from Mr. T. M. Broderick, Chief Geologist for the Calumet & Hecla Consolidated Copper Company, dated January 2nd, and two whiteprint maps which comprises his report of the exploration work done on the Company lands leased to Lundin & Bjork in the vicinity of the Ropes Gold Mine.

I visited the property on August 6th and went over the ground with Mr. Frank Lundin, the foreman in charge. The exploration work during the past year has consisted entirely of trenching to expose the ledge surface in search for gold-bearing quartz veins and to expose any possible zones of shearing favorable for gold-bearing mineralization. We examined most of the trenches dug during the year 1940 and all of those which had been opened during the current year up to that time. I found two men being employed, which meets the requirements of the lease and am convinced that the activities, while going forward on a minimum basis, have been conducted in a workmanlike and intelligent manner and in accordance with the terms of the lease.

Mr. Broderick's report stated that this work has been continued during the balance of the year and I have no reason to doubt it. The work, however, has failed to discover any additional mineralization within the area being explored. So far no workable gold veins have been found on the Company lands covered by this lease but there is still considerable acreage to be tested.

Yours very truly,

E. L. Derby, Jr.

Geologist

ELD:DWC
c.c.—S.R.E.

-5-

COPY HW-2

ALGER COUNTY TAXPAYERS' ASSOCIATION
FOURTEENTH ANNUAL REPORT
FOR THE YEAR ENDING SEPTEMBER 30, 1941

OFFICERS

E. F. Bartels	President
E. O. Erickson	Secretary-Treas.
J. I. Keeton	Manager

DIRECTORS

E. F. Bartels	Munising
E. O. Erickson	Munising
J. H. Wallace	Munising
J. M. Bush	Negaunee
P. S. Hamilton	Newberry
C. E. Good	Nahma

ORGANIZED OCTOBER 1927

ALGER COUNTY TAXPAYERS' ASSOCIATION

FOURTEENTH ANNUAL REPORT

I N D E X

	<u>Page</u>
General Remarks-----	
Association Receipts & Disbursements-----	1
Assessed Valuation, Association Members & Others-----	2- 5
Alger County Tax Rates, 1941-----	6
Graph Showing Total Tax Rates, 1927-1941-----	7
Graph Showing Total Valuation as Assessed & Equalized-	8
Comparative Statement of County, School & Local Taxes-	9
Graph Showing Assessed Valuation, 1903-1941-----	10
Graph Showing County Tax Levies, 1901-1941-----	11
Graph Showing Township & City Tax Levies, 1901-1941---	12
Graph Showing School Tax Levies, 1901-1941-----	13
Graph Showing Total Tax Levies, 1901-1941-----	14
Delinquent Taxes-----	15
Assessed Valuation, Taxes & Expenditures Per Capita---	16-19
Graph Showing Expenditures Per Capita-----	20
Alger County General Fund Expenditures-----	21
State Institutional Charges-----	22
Alger County Social Welfare Board-----	23
Alger County Road Commission-----	24-25
Au Train Township-----	26
Burt Township-----	27
Burt Township Light & Water-----	28
Grand Island Township-----	29
Limestone Township-----	30
Mathias Township-----	31
Munising Township-----	32
Onota Township-----	33
Rock River Township-----	34
Graph Showing Township Expenditures-----	35
Comparative Statement of Twp. Contingent Fund Exp.----	36
City of Munising-----	37-38
Au Train Township Schools-----	39
Burt Township Schools-----	40
Grand Island Township Schools-----	41
Limestone Township Schools-----	42
Mathias Township Schools-----	43
Munising Township Schools-----	44
Onota Township Schools-----	45
Rock River Township Schools-----	46
School Income & Per Cent From Each Source-----	47
School Funds Allotted By State & County-----	48
Comparative School Statements-----	49
Bonded & Other Indebtedness-----	50

ALGER COUNTY TAXPAYERS' ASSOCIATION

FOURTEENTH ANNUAL REPORT

The Association submits herewith its fourteenth annual report covering its activities and also statistical information of the political units of Alger County.

The Association receipts for the year 1940-41 amounted to \$3,936.02 of which \$3,723.97 was membership dues, \$200.00 contribution by the Ford Motor Company and a refund of \$12.05. Expenditures for the year amounted to \$3,852.09. Receipts in detail and classification of expenditures are shown in the statement accompanying this report.

The assessed valuation of Association members on returns of valuation for 1940 amounted to \$3,685,147.00 compared with the prior year, this is a decrease of \$249,463.00. The Association represents 56.35% of all the property in Alger County. The assessed valuation of Alger County for the year 1941 is \$6,539,818.00, a decrease of \$159,074.00 as compared to the preceding year. Rock River Township and the City of Munising showed a total increase of \$47,715.00. Grand Island Township had no change and in the other six townships there was a decrease. The largest decrease was \$76,720.00 in Omota Township. The reason for this decrease is that forest products are being removed quite rapidly and the same is true to a lesser extent in the other township units.

The State Tax Commissioners, in getting up the tentative equalized valuation for this county, gave us an increase of \$300,000.00 over the equalized valuation for the prior year. This office filed a protest with the State Board of Equalization and the \$300,000.00 increase was reduced by \$200,000.00. In fixing the tentative valuation it appears that the State Tax Commission paid little attention to changes in local valuation, as all counties except four were given increases. The Equalization Board reduced Wayne County more than \$15,000,000.00.

During the year three elections were held to vote taxes in excess of the 15-mill limitation. Two of these were successful. Munising Township voted two mills for lighting purposes but the officers levied only one mill as two mills would have given them nearly double the amount that they are allowed to spend for that purpose. Burt Township voted one mill for the same purpose. These two levies amounted to a total of \$1,785.39. Mathias Township School District held an election to vote one extra mill for school purposes and this was defeated.

Taxes levied for all purposes in the year 1941 amounted to \$157,422.37. This is an increase of \$1,883.42 over the prior year. Taxes levied in detail for each unit are set up in the statements included with this report. The average tax rate for the year 1941 is 34.31 compared with 32.55 for the prior year.

Alger County General Fund income showed an increase of \$4,564.33 covering 12 months ending July 31, 1941. This is largely accounted for by increase in current and delinquent tax collections. Actual expenditures covering county operations paid through the General Fund decreased \$762.51.

State Institutional Charges covering the care of Alger County Patients in state hospitals and sanatoriums showed an increase of \$2,169.55 covering the 12 month period ending September 30, 1941. No payments were made to the State and the amount unpaid at the above date amounts to \$46,286.56. This is nearly equivalent to one year's tax levy.

The Relief load, covering the calendar year 1941, showed a considerable decrease compared with the previous years, the average case load was lower by 31 cases. Funds provided for the year amounted to \$36,208.90 of which \$19,315.65 came from the State Welfare Board. The State funds are used entirely for direct relief. The County must provide for administrative, infirmary and hospitalization expense. County funds and sundry collections amounted to \$16,893.25.

The Alger County Road Commission, for 12 months ending September 30, 1941, had a total income of \$191,667.19. The principal sources of income for the Road Commission are from the Weight and Gas tax and the State Maintenance contract. During the year in review state maintenance income amounted to \$96,154.17. Expenditures for the period amounted to \$190,066.05. This is an increase of \$11,503.91 compared with the prior year and is accounted for largely in the following classification: State trunk line maintenance, equipment repairs, new equipment and county road maintenance. New equipment amounted to \$15,099.06 of which a large portion was contracted during the years 1938-39. At December 31, 1941 the Road Commission had outstanding only two equipment notes amounting to \$7,000.00. In view of the fact that 6% interest on these contracts is included in the cost of the equipment it follows that purchases made on the deferred payment plan are very expensive.

During the year county road construction was carried on in cooperation with the W. P. A. A summary of these expenditures is as follows:

W. P. A. Appropriation, Labor	79,144.00
Materials, equipment rental, etc.	<u>10,293.70</u>
Total W. P. A.	89,437.70
Road Commission Expenditures, covering labor, materials, and equipment rental required from sponsor	<u>39,692.56</u>
Total	129,130.26

There is no financial distress in any of our townships. Total township contingent expenditures for 12 months ending March 31, 1941 amounted to \$17,261.25. A decrease of \$369.07 as compared with the prior year. There is a wide variation in the total compensation of township officers. In the past year this varied from \$1,957.35 in Munising Township down to \$274.00 in Grand Island. This office endeavors to keep these costs as low as possible, but what is really needed is better control through new legislation and some constitutional amendments. All tax collections should be made by the County Treasurer. Highway Commissioners should be entirely done away with and the other township officers either entirely done away with or their duties reduced.

In the City of Munising the Commissioners' tentative budget for 1941 was materially increased over the previous year. At the budget hearing this Association protected this increase and the City Commissioner made a reduction of \$2,000.00. In recent years too many of our local Governmental units have followed the spending example set in Washington. The sponsoring of W. P. A. projects is a heavy burden on local units. In Alger County during the past year, the major projects were sponsored by the City of Munising and the Alger County Road Commission.

The Pumping Plant was operated more economically during the current year. Operating costs showed a decrease of \$1,324.51 and net profit and increase of \$586.18. The gallons pumped was approximately the same as the prior year but there was a small decrease in accrued revenue.

The school districts in general are in about the same condition as at the beginning of their school year. Both income and expenditures increased leaving a balance on hand in all school districts at July 1, 1941 of \$27,785.19. The prior year balance was \$28,246.38. Two districts had a deficit at the end of both years, namely Au Train and Onota. Due to increased legislative appropriations it is indicated

that school income will show increase during the 1941-42 year. There have been some salary increases and whether or not this will off-set the increased income cannot be definitely stated at this time. Average membership showed a decrease of 162 pupils, spread quite uniformly throughout the eight districts.

Your Association is keeping careful check on all tax levies and expenditures of public funds and promoting economy and efficiency at all times. We keep the local units informed as to their financial status and can thus, in many cases, prevent extravagant expenditures in pointing out that the finances are not sufficient.

We wish to repeat that we are glad at all times to furnish any special reports or information on request of our members. We thank you for your cooperation.

Respectfully submitted,

J. I. Keeton
J. I. Keeton, Manager

jik:bmh

ALGER COUNTY TAXPAYERS' ASSOCIATION

RECEIPTS AND DISBURSEMENTS FOR THE YEAR ENDING SEPTEMBER 30, 1941

RECEIPTS

San Marks	29.54	
I. Stephenson Company	15.09	
Manising Wood Products Company	83.63	
Cleveland-Cliffs Iron Company	1,777.37	
Michigan Gas & Electric Company	82.57	
Manising Paper Company	1,272.59	
First National Bank	49.76	
Bay de Nocet Company	180.73	
Peoples State Bank	12.59	
Atlas Plywood Corp.	19.82	
Nick Sigan	66.34	
Wisconsin Land & Lumber Company	43.31	
Jackson & Tindle, Inc.	88.13	
Ford Motor Company	200.00	
Refund	12.05	
Total Receipts		3,936.02

EXPENDITURES

Salaries	2,830.00	
Office Rent	168.00	
Office Light	20.57	
Telephone & Telegraph	55.57	
Automobile Mileage	428.34	
Travel	49.31	
Office Supplies & Expense	145.95	
Postage & BoA Rent	88.00	
Papers & Periodicals	17.90	
Special Expense	48.42	
Total Expenditures		3,852.09

Balance September 30, 1940	217.56	
Receipts	3,936.02	
Total	4,153.58	
Expenditures	3,852.09	
Balance September 30, 1941	301.49	

2

ALGER IR COUNTY TAXPAYERS ASSOCIATION

STATEMENT SHOWING 1940 ASSESSED VALUATION OF PROPERTY OWNED BY THE
MEMBERS OF THE TAXPAYERS' ASSOCIATION, PROPERTY OWNED BY OTHERS,
AND PERCENTAGE

	<u>ASSESSED VALUATION</u>	<u>PERCENT</u>	<u>PER CENT PREVIOUS YEAR</u>
<u>AU TRAIN TOWNSHIP</u>			
Bay de Noquet Company	105,920.00	22.58	22.60
Cleveland-Cliffs Iron Company	91,360.00	19.47	19.68
Munising Paper Company			.04
Newberry Lumber & Chemical Co.	16,040.00	3.42	3.63
TOTAL TAXPAYERS' ASS'N.	213,320.00	45.47	45.35
All Other Property	255,825.00	54.53	54.65
TOTAL AU TRAIN TOWNSHIP	469,145.00	100.00	100.00
<u>BURT TOWNSHIP</u>			
Cleveland-Cliffs Iron Company	840,542.50	65.40	62.64
Jackson & Tindle, Inc.	31,800.00	2.48	2.62
Munising Paper Company	54,900.00	4.27	4.20
Newberry Lumber & Chemical Co.	116,812.50	9.09	10.37
TOTAL TAXPAYERS' ASS'N.	1,044,055.00	81.24	79.83
All Other Property	241,165.00	18.76	20.17
TOTAL BURT TOWNSHIP	1,285,220.00	100.00	100.00
<u>GRAND ISLAND TOWNSHIP</u>			
Cleveland-Cliffs Iron Company	219,770.00	88.10	88.10
All Other Property	29,675.00	11.90	11.90
TOTAL GRAND ISLAND TOWNSHIP	249,445.00	100.00	100.00
<u>LIMESTONE TOWNSHIP</u>			
I. Stephenson Company	3,500.00	1.49	5.32
Wisconsin Land & Lumber Company	43,350.00	18.38	15.28
TOTAL TAXPAYERS' ASS'N.	46,850.00	19.87	20.60
All Other Property	188,972.00	80.13	79.40
TOTAL LIMESTONE TOWNSHIP	235,822.00	100.00	100.00
<u>MATHIAS TOWNSHIP</u>			
Bay de Noquet Company	76,125.00	27.40	26.80
Cleveland-Cliffs Iron Company	2,550.00	.92	1.11
TOTAL TAXPAYERS' ASS'N.	78,675.00	28.32	27.91
All Other Property	199,125.00	71.68	72.09
TOTAL MATHIAS TOWNSHIP	277,800.00	100.00	100.00
<u>MUNISING TOWNSHIP</u>			
Bay de Noquet Company	3,525.00	.62	.58
Cleveland-Cliffs Iron Company	330,650.00	57.89	61.41
Munising Paper Company	18,050.00	3.16	2.97
Newberry Lumber & Chemical Co.	24,700.00	4.32	4.11
Michigan Gas & Electric Company	9,000.00	1.58	1.48
TOTAL TAXPAYERS' ASS'N.	385,925.00	67.57	70.55
All Other Property	185,230.00	32.43	29.45
TOTAL MUNISING TOWNSHIP	571,155.00	100.00	100.00

	ASSESSED VALUATION	PERCENT	PER CENT PREVIOUS YEAR
<u>ONOTA TOWNSHIP</u>			
Cleveland-Cliffs Iron Company	198,080.00	31.55	29.86
Nick Sigan	69,450.00	11.06	10.40
TOTAL TAXPAYERS' ASS'N.	267,530.00	42.61	40.26
All Other Property	360,345.00	57.39	59.74
TOTAL ONOTA TOWNSHIP	627,875.00	100.00	100.00
<u>ROCK RIVER TOWNSHIP</u>			
Cleveland-Cliffs Iron Company	970.00	.24	.25
All Other Property	405,560.00	99.76	99.75
TOTAL ROCK RIVER TOWNSHIP	406,530.00	100.00	100.00
<u>MUNISING CITY</u>			
Atlas Plywood Corporation	19,200.00	.75	.74
Cleveland-Cliffs Iron Company	87,042.00	3.38	3.27
First Nat'l Bank of Alger County	23,000.00	.89	1.87
Jackson & Tindle Inc.	30,000.00	1.16	2.03
Michigan Gas & Electric Co.	72,800.00	2.83	2.76
Munising Paper Company	1,135,760.00	44.09	44.99
Peoples State Bank	6,450.00	.25	.47
Munising Wood Products Company	24,000.00	.93	3.13
Sam Marks Estate	29,800.00	1.16	1.11
TOTAL TAXPAYERS' ASS'N.	1,428,052.00	55.44	60.37
All Other Property	1,147,848.00	44.56	39.63
TOTAL MUNISING CITY	2,575,900.00	100.00	100.00
<u>GRAND TOTAL TAXPAYERS ASS'N.</u>			
All Other Property	3,685,147.00	55.01	56.15
	3,013,745.00	44.99	43.85
TOTAL ALGER COUNTY	6,698,892.00	100.00	100.00

4

ALGER COUNTY TAXPAYERS' ASSOCIATION

COMPARATIVE STATEMENT OF THE ASSESSED VALUATION OF MEMBERS FOR
1940 AND 1939 SHOWING INCREASES AND DECREASES

	<u>Assessed Valuation</u>		<u>Increase</u>	<u>Decrease</u>
	<u>1940</u>	<u>1939</u>		
<u>ATLAS PLYWOOD CORPORATION</u>				
Munising City	19,200.00	20,000.00		800.00
% of Grand Total	.52	.51		
<u>BAY DE NOQUET COMPANY</u>				
Au Train Township	105,920.00	106,230.00		310.00
Mathias Township	76,125.00	72,575.00	3,550.00	
Munising Township	3,525.00	3,525.00		
Total	185,570.00	182,330.00	3,240.00	
% of Grand Total	5.04	4.63		
<u>CLEVELAND-CLIFFS IRON COMPANY</u>				
Au Train Township	91,360.00	89,645.00	1,715.00	
Burt Township	840,542.50	819,305.00	21,237.50	
Grand Island Township	219,770.00	219,770.00		
Mathias Township	2,550.00	3,000.00		450.00
Munising Township	330,650.00	372,920.00		42,270.00
Onota Township	198,080.00	199,440.00		1,360.00
Rock River Township	970.00	1,120.00		150.00
Munising City	87,042.00	87,950.00		908.00
Total	1,770,964.50	1,793,150.00		22,185.50
% of Grand Total	48.06	45.57		
<u>FIRST NAT'L BANK OF ALGER COUNTY</u>				
Munising City	23,000.00	50,200.00		27,200.00
% of Grand Total	.62	1.28		
<u>I. STEPHENSON COMPANY</u>				
Limestone Township	3,500.00	15,225.00		11,725.00
% of Grand Total	.09	.39		
<u>JACKSON & TINDLE INC.</u>				
Burt Township	31,800.00	34,300.00		2,500.00
Munising City	30,000.00	54,610.00		24,610.00
Total	61,800.00	88,910.00		27,110.00
% of Grand Total	1.68	2.26		
<u>MICHIGAN GAS & ELECTRIC COMPANY</u>				
Munising Township	9,000.00	9,000.00		
Munising City	72,800.00	74,300.00		1,500.00
Total	81,800.00	83,300.00		1,500.00
% of Grand Total	2.22	2.12		
<u>MUNISING PAPER COMPANY</u>				
Au Train Township		200.00		200.00
Burt Township	54,900.00	54,900.00		
Munising Township	18,050.00	18,025.00	25.00	
Munising City	1,135,760.00	1,210,760.00		75,000.00
Total	1,208,710.00	1,283,885.00		75,175.00
% of Grand Total	32.80	32.63		