

AMERICAN IRON MINING COMPANY

REAL ESTATE AND TIMBER LAND SALES

During the year, we disposed of seven more of the summer cottage sites platted on the shore of Lake George in Section 20-48-31 for a consideration of \$645.00. This Company also owns frontage on Lake Beaufort and Petticoat Lake in Section 28-48-31. We have been endeavoring to interest someone in the purchase of this entire section for club purposes but so far have been unsuccessful. The demand for lake frontage lands is increasing each year and we believe it will only be a short time when we will be able to dispose of all the lands in Section 28.

SALES OF STUMPAGE

Two cords of down trees and tops were sold from lands in Section 34-48-31 for fuel purposes at fifty cents per cord.

PIQUA COMPANY TIMBER PERMIT

The Piqua Company have cut over and released all of the lands covered by their timber permit, except the NE $\frac{1}{2}$ of NE $\frac{1}{4}$, the S $\frac{1}{2}$ of NE $\frac{1}{4}$, SE $\frac{1}{2}$ of Section 34-48-31, the W $\frac{1}{2}$ of NE $\frac{1}{4}$, NW $\frac{1}{4}$, N $\frac{1}{2}$ of SW $\frac{1}{4}$ and the SE $\frac{1}{2}$ of Section 2-47-31. The permit as to the lands in Section 34-48-31 will expire July 1st, 1926 and as to the lands in Section 2, on July 1st, 1927. The Piqua Company pays the taxes each year on all the lands not released.

Respectfully submitted,

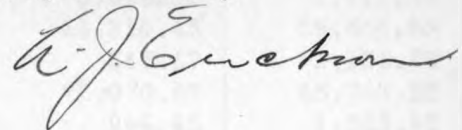

AJE:MD:3.

THE CLEVELAND - CLIFFS IRON COMPANY

LAND DEPARTMENT

COMPARATIVE STATEMENT OF RECEIPTS FOR YEARS 1924 AND 1925

R E C E I P T S	1925	1924
Deliveries of Forest Products	472,901.00	419,048.17
Sawmill Deliveries - Munising	572,384.67	566,039.88
" " - New Dalton	1,701.62	782.53
Retail Yard Deliveries	58,276.85	63,421.18
Shingle & Tie Mill Deliveries	8,494.07	14,851.34
Cliffland Farm Product Sales	2,587.83	3,294.31
Williams Hotel & Cottages	16,311.63	16,912.35
Grand Island Products Sales	11,608.63	12,922.99
Earnings from Rented Buildings	10,405.96	10,516.55
Lot Rents - Pendill Location	270.49	183.00
C. I. M. Co.'s First Addition	1,841.02	1,841.02
Do Second "	607.00	598.00
" Third "	2,947.00	2,946.00
" Fourth "	117.00	118.00
" Fifth "	1,111.00	1,111.00
" Bancroft Location	222.00	222.00
" Nebraska "	135.00	135.00
" Hard Ore Addition	1,772.00	1,783.24
" Hematite Location	28.00	28.00
Ex. I. Co.'s First Addition	12.00	12.00
I. C. Co.'s Junction Location	360.00	360.00
Do Salisbury "	145.50	123.50
" Winthrop "	127.00	127.00
" Barnum "	628.68	606.35
Jackson Addition	1,211.00	1,206.84
Munising	58.00	62.50
Pioneer Iron Co.'s Second Addition	97.00	96.00
East New York Location	215.00	221.00
Lake Angeline "	146.00	146.00
Hard Ore Location	75.00	64.76
Chatham	2.00	
Land Rents	8,300.78	8,131.99
Sundry Rentals	230.78	322.00
Real Estate Sales	28,292.00	71,692.50
Farm Land Sales	631.20	1,085.00
Town Lot Sales	5,386.00	7,111.50
Cordwood Sales - Other Operations	26,814.43	29,644.55
Forest Products Sales - Outside Parties	548.67	1,151.29
" " " - Other Operations	72,070.59	65,743.35
Trespass Cases	944.45	1,553.97
Bark Sales - Outside Parties		11.50
" " - Other Operations	529.80	1,156.86
Timber Sales	3,200.00	10,116.00
Land Products Sales	200.62	394.31
Royalties Received	2,820.66	2,910.01
Rental of Equipment	4.25	52.30
Miscellaneous Sales of Machinery & Equipment	4,078.86	670.25
Miscellaneous Earnings	951.36	3,247.13
T o t a l	1,321,804.40	1,322,605.12

LED:D:2
1/26/26.

THE CLEVELAND - CLIFFS IRON COMPANY

LAND DEPARTMENT

STATEMENT OF LAND AND TIMBER SALES FOR YEAR 1925

PURCHASER	DESCRIPTION	ACREAGE	LAND	TIMBER	TOTAL	REMARKS	
Township of AuTrain	Township Road Right of Way Deed		\$ 1.00		\$ 1.00	Conveyance No. 4196	
Alex Saari	N $\frac{1}{2}$ of SW $\frac{1}{4}$	Section 36-47-27	287.50	\$152.50	440.00		
County of Marquette	County Road Right of Way Deed		1.00		1.00	Conveyance No. 4205	
M. M. Stierle	Lot 4	18-47-23	34.50	106.50	320.00		
Charles Valeen	SW $\frac{1}{4}$ of NE $\frac{1}{2}$	15-42-23	40.00	230.00	360.00		
Lewis Jensen & Asel A. Crego	Lot 2	25-44- 6	49.30	493.00	600.00		
Urho S. Tyynismaa	SW $\frac{1}{4}$ of SE $\frac{1}{4}$	17-46-22	40.00	360.00	360.00		
John Bellamer	NW $\frac{1}{4}$ of SW $\frac{1}{4}$	26-47-20	40.00	312.00	48.00	360.00	
Jarvela & Aho	W $\frac{1}{2}$ of	34-47-30	320.00	480.00	520.00	1,000.00 ✓	
Emma Murray	E $\frac{1}{2}$ of SE $\frac{1}{4}$, Sec. 1, & N $\frac{1}{2}$ of NE $\frac{1}{4}$	12-44-22	160.00	960.00	8,040.00	9,000.00 ✓	
Frank Leroux	NW $\frac{1}{4}$ of SW $\frac{1}{4}$	2-50-34	40.00	310.00	50.00	360.00	
Emil Erickson	SE $\frac{1}{4}$ of NW $\frac{1}{4}$	31-46-21	40.00	195.00	345.00	540.00	
Leslie French	E $\frac{1}{2}$, NE $\frac{1}{4}$ of SW $\frac{1}{4}$, & S $\frac{1}{2}$ of SW $\frac{1}{4}$	23-44-24		2,300.00	2,300.00	2,300.00 ✓	
Aug. Niemi & John Leyon	SW $\frac{1}{4}$ & S $\frac{1}{2}$ of SE $\frac{1}{4}$	28-47-30	240.00	240.00	385.00	625.00	Timber Only
Leonard C. Clapp	Lots 1 & 2	18-46-20	40.88	250.00	750.00	1,000.00 ✓	
Grace B. Wneslock	E $\frac{1}{2}$ of NE $\frac{1}{4}$	20-43- 5	80.00	160.00	190.00	350.00	
Wisconsin Land & Lumber Co.	W $\frac{1}{2}$ of NW $\frac{1}{4}$, NW $\frac{1}{4}$ of SW $\frac{1}{4}$, SW $\frac{1}{4}$ of SE $\frac{1}{4}$, Sec. 15, NE $\frac{1}{4}$ of SE $\frac{1}{4}$	16-45-22	200.00	1,000.00	6,000.00	7,000.00 ✓	
Fred Van Remortel	Lot 2, Sec. 4, Lot 2 & part of Lot 1	9-38-19	64.18	600.00		600.00	
Fred Lewke	S $\frac{1}{2}$ of SW $\frac{1}{4}$	14-47-23	80.00	200.00		200.00	
George Runstrom	E $\frac{1}{2}$ of SE $\frac{1}{4}$	30-47-23			900.00	900.00	Timber Only
John McCarthy	NW $\frac{1}{4}$ of NE $\frac{1}{4}$	9-45-24	40.00	162.50	1,487.50	1,650.00 ✓	
Charles E. Clement	W $\frac{1}{2}$ of NW $\frac{1}{4}$, SE $\frac{1}{4}$ of NW $\frac{1}{4}$, NE $\frac{1}{4}$ of SW $\frac{1}{4}$,	8-45-17	160.00	160.00	2,040.00	2,200.00 ✓	
Munising Twp. Board of Education	Part of	36-47-19	.42	50.00		50.00	
Edward Bryant	SE $\frac{1}{4}$ of SE $\frac{1}{4}$	4-38-19	40.00	280.00		280.00	
Peterson & Lindholm	SE $\frac{1}{4}$ of NW $\frac{1}{4}$	17-45-23	40.00	280.00	2,120.00	2,400.00 ✓	
Arthur E. Anttila	NE $\frac{1}{4}$ of SW $\frac{1}{4}$	24-46-30	40.00	185.00	75.00	260.00	
James H. Roundtree	SW $\frac{1}{4}$ of SW $\frac{1}{4}$	9-49-13	40.00	40.00	210.00	250.00	
L.S.&I. Railroad Co.	Railroad Right of Way - NE $\frac{1}{2}$ of SW $\frac{1}{4}$	19-47-26	.15	25.00		25.00	
TOTAL			1,909.43	7,368.50	26,063.50	33,432.00	

THE CLEVELAND - CLIFFS IRON COMPANY

LAND DEPARTMENT

STATEMENT OF LAND AND TIMBER SALES FOR YEAR 1925

SHEET NO. 2

	UNPLATTED LANDS							PLATTED LANDS			TOTAL	MINERAL RIGHTS RESERVED IN SALES	
	FEE	SURFACE ONLY	MINERALS ONLY	LEASED MINERALS	MINING OPTION	TIMBER ONLY	LEASED SURFACE	WATER RIGHTS	FEE	SURFACE ONLY			MINERALS ONLY
Total Acreage as per Acreage Statement December 31, 1924.	580,663.34	74,453.17	2,252.21	2,499.55	53,308.36	20,999.69	326.60	4,793.45	223.21	81.23	283.72	739,884.53	104,534.45
Purchased in 1925 (1)	2,029.86	48.46	1,126.03	218.65			106.35			10.44		3,539.79	
Cancelled Contract (2)	233.15											233.15	233.15
TOTAL	582,926.35	74,501.63	3,378.24	2,718.20	53,308.36	20,999.69	432.95	4,793.45	223.21	91.67	283.72	743,657.47	104,301.30
Sold in 1925 (3)	1,217.22	714.50							6.22	.39		1,938.33	1,194.51
Surrendered (4)						3,699.77						3,699.77	
TOTAL	1,217.22	714.50				3,699.77			6.22	.39		5,638.10	
Total Acreage as Per Acreage Statement December 31, 1925	581,709.13	73,787.13	3,378.24	2,718.20	53,308.36	17,299.92	432.95	4,793.45	216.99	91.28	283.72	738,019.37	105,495.81

(1) Purchase Nos. 2333, 2334, 2336, 2337, 2338, 2339, 2340, 2341, 2342, 2343, 2345, 2346, 2347, 2348, 2349, 2351, 2353, 2354, 2357, 2358, 2359, 2360, 2388, 2393, 2394, 2396, and 2397.
 (2) Conveyance Nos. 3662, 3694, 3722, and 3870.
 (3) Sales as above and Conveyance Nos. 4197, 4202, 4203, 4207, 4218, 4220, 4221, 4222, 4228, 4246, 4251, 4262, 4294, 4295, 4223, 4257, 4263, 4264, 4286, 4204, 4236, 4249, and 4250.
 (4) Conveyance No. 4204 - Consolidated Lumber Co. 1554.56 Acres; Charcoal Iron Co. -2145.21 Acres.

THE CLEVELAND-CLIFFS IRON COMPANY

LAND DEPARTMENT

STATEMENT OF LANDS PURCHASED AND EXPENSES INCURRED ON ACCOUNT OF LAND TRACTS FOR THE YEAR 1925.

PURCHASE	GRANTOR	PURCHASE NO.	ACREAGE	PURCHASE PRICE	ABSTRACTS & RECORDING	MISCELLANEOUS	TOTAL
Munising Company	Munising Company	1848			\$1.00		\$1.00
Munising Company	Swaby L. Lawton & wife	2392				To clear title \$50.00	50.00
Dalton Lumber Co.	John W. Dalton & wife	1974			1.50	For extension of Timber Rights \$200.00	201.50
TOTAL					\$2.50	\$250.00	\$252.50

OMC:CN:3.
1/28/26.

THE CLEVELAND - CLIFFS IRON COMPANY

LAND DEPARTMENT

LAND ACREAGE - DECEMBER 31, 1925.

TOWN	RANGE	UNPLATTED LANDS								PLATTED LANDS			TOTAL	MINERALS RE-SERVED IN FARM LAND SALES
		FEE	SURFACE	MINERALS	LEASED MINERALS	MINING OPTION	TIMBER ONLY	LEASED SURFACE	WATER RIGHTS	FEE	SURFACE	MINERALS		
45	1 E	40											40	80
45	1 W	280											280	
46	1													80
47	1	40											40	
45	2													123.13
46	2	2873.61											2873.61	3059.00
47	2	41.18											41.18	250.35
45	3	166.56											166.56	
46	3	1341.84											1341.84	1871.47
47	3	600											600	560
46	4													120
47	4													222.50
45	5	200											200	200
46	5	120											120	680
46	5	40											40	842.71
47	5	40											40	120
44	6	368.30											368.30	460.05
45	6	800											800	1,309.99
46	6													280
44	7	120											120	4,153.59
45	7	280											280	391.27
46	7	211.26											211.26	640
47	7	338.81											338.81	
48	7	497.70											497.70	
49	7	44											44	
44	8	76.88											76.88	
46	8	2311.92											2311.92	
47	8	6957.72											6957.72	
48	8	5041.52											5041.52	
49	8	3923.04											3923.04	
50	8	160											160	
44	9	40											40	
46	9	512.23											512.23	200
47	9	17793.74											17793.74	
48	9	4136.58											4136.58	
49	9	800											800	
50	9	23											23	
45	10	840											840	600
46	10	254.54											254.54	46.18
47	10	14579.08											14579.08	40
48	10	14534.01											14534.01	
49	10	3385.47											3385.47	30.52
43	11	200											200	280
44	11	277											277	
46	11	4102.55											4102.55	480
47	11	13773.29											13773.29	
48	11	19592.71											19592.71	
49	11	745.17											745.17	
46	12	15514.00											15514.00	
47	12	16868.33	198.41										17066.79	
48	12	21576.80	160										21736.80	
49	12	8229.41											8229.41	
50	12	359.65											359.65	
45	13													1273.71
46	13	913.25											913.25	400
47	13	5174.53											5174.53	
48	13	19469.63	114.51										19584.14	
49	13	16360.85											16360.85	40
50	13	164.35											164.35	
42	14													35
43	14	236.85											236.85	
45	14	440											440	
46	14	840											840	
47	14	6069.80	437.25										6507.05	
48	14	18922.14	553.68										19475.82	
49	14	9290.07	360										9650.07	
42	15													1766.77
43	15													194.10
45	15	80											80	
46	15	5392.78	40										5432.78	
47	15	8786.64	974.20										9760.84	
48	15	14179.22	520										14699.22	
49	15	4850.91	393.59										5244.50	
41	16													903.65
42	16													14.20
43	16	80											80	485.50
44	16													80
45	16	63.85											63.85	
46	16	1456.03											1456.03	31.06
47	16	4448.78	240										4688.78	
48	16	8740.01	495.37										9235.38	79.25
49	16	1004.60	600										1604.60	
41	17													5797.51
42	17	240											240	1840
44	17													238.69
45	17	676											676	476.37
46	17	3260.81											3260.81	320
47	17	7963.30	200										8163.30	320
48	17	4276.15	201										4477.15	
39	18	2.51											2.51	29.92

THE CLEVELAND-CLIFFS IRON COMPANY

LAND DEPARTMENT

LAND ACRES - DECEMBER 31, 1925.
SHEET #2.

TOWN	RANGE	UNPLATTED LANDS							PLATTED LANDS			TOTAL	MINERALS RE-SERVED IN FARM LAND SALES	
		FEE	SURFACE	MINERALS	LEASED MINERALS	MINING OPTION	TIMBER ONLY	LEASED SURFACE	WATER RIGHTS	FEE	SURFACE			MINERALS
41	18	160											160	800
43	18	40											40	
44	18	55.78											55.78	160
45	18	560											560	
46	18	11733.04											11733.04	1268.10
47	18	11251.40	120										11371.40	1025.32
48	18	520											520	
37	19	135.60											135.60	601.00
38	19	1987.71											1987.71	4171.18
39	19	592.79											592.79	2022.96
41	19												360	
42	19												560	
43	19												520	
44	19	7067.17	1080.97				882.41						9030.55	
45	19	594.22	80.66				2078.79						3755.67	1964.81
46	19	10435.18	176.35							41.05	14.33		10666.91	8999.50
47	19	9480.17	108.18							8.06			9596.41	389.26
48	19	6365.06	638.35										7003.41	
38	20													358
44	20	6991.28	40										7031.28	
45	20	6305.36	1566.61				40						7911.97	.58
46	20	15080.86	80				80						15240.86	120.88
47	20	4742.01											4742.01	640
48	20	113.96											113.96	
43	21	378.60	40										418.60	4686.11
44	21	3118.81	634.48										3753.29	3359.33
45	21	4725.42											4725.42	2005.41
46	21	8662.06	80				200			1.36			8965.42	3699.59
47	21	4274.57											4274.57	861.16
48	21	963.48											963.48	
40	22	65.01								.20			65.21	
41	22													219
42	22													878.09
43	22												80	
44	22	6393.63	800										7193.63	160
45	22	5430.42	1866.06										7296.48	428.19
46	22	4912.03	234.32										5146.35	10916.98
47	22	6541.05	1786.61										8327.66	785.09
48	22	2140.09	279.70										2419.79	
39	23	240											240	
40	23												160	
42	23	160											3229.01	
43	23	680											680	1120
44	23	287.31	4035.25										4322.56	39.22
45	23	1339.49	5255.17										6594.66	80
46	23	1589.75	10504.24				320						12413.99	636.57
47	23	2560	5934.90										8494.90	
39	24	40											40	200
41	24													400
44	24	1880.32	7886.64										9766.96	
45	24	1002.00	4802.00										5804.00	40
46	24	1986.37	240										2226.37	
47	24	240											240	40
44	25	614.35			43.23								657.68	
45	25	1562.57	652.49		778.79								3059.40	1.65
47	25	6201.57	1082.53								58.55		7284.10	
48	25	3119.35	260						830.84	1.97			4232.16	1397.13
49	25	40.14											40.14	831.90
44	26	162.91											162.91	
45	26	927.49	1311.81										2239.30	
46	26	60											60	
47	26	8284.84	269.52	286.06						41.71	15.79	62.77	8980.69	2075.95
48	26	4207.46	1887.07	59.11	157.50				1533.29			3.00	7347.43	813.63
49	26	600	3654.40										4254.40	153.04
50	26													240
51	26	89.65	570.01										659.66	160
46	27	81.68											81.68	40
47	27	11836.10	161.77	721.88	378.65			111.60		122.64	.33	197.95	13532.92	2895.24
48	27	4694.82	3505.93	1120						191.34			9512.09	596.20
49	27	919.28								1194.70			2113.98	
50	27													180
51	27	1449.17	79.03										1528.20	520
52	27	40											40	
47	28	1314.79	73.60	75.00	727.94								2191.33	5
48	28	2945.64											2945.64	4
50	28	1921.62	789.33										2710.95	160
51	28	3320	840										4160	109.05
52	28													240
49	29	280											280	
50	29	1627.44	60										1687.44	
51	29	4511.88											4511.88	531.40
52	29	3808.37											3808.37	704.25
45	30	46.20	160										206.20	
46	30	626.80	320										946.80	305.70
47	30	327.90	915.36										1243.26	80
49	30	640											640	
50	30	5400.98	1204.26										6605.24	
51	30	5795.77	641.95										6437.72	
52	30	1960											1960	
48	31	60	120										180	

THE CLEVELAND-CLIFFS IRON COMPANY

LAND DEPARTMENT

LAND ACREAGE - DECEMBER 31, 1925.

SHEET #3.

TOWN	RANGE	UNPLATTED LANDS							PLATTED LANDS			TOTAL	MINERALS RE-SERVED IN FARM LAND SALES	
		FEE	SURFACE	MINERALS	LEASED MINERALS	MINING OPTION	TIMBER ONLY	LEASED SURFACE	WATER RIGHTS	FEE	SURFACE			MINERALS
49	28		1640										1059.68	
49	31	40											40	
50	31	5530.28	160										5690.28	
51	31	218.80	240										458.80	
52	31													40
49	32	160	1120										1280	
50	32	1395.37											1395.37	
47	33	640											640	
48	33	160											160	
49	33	4435.14	118.62	36.55			6730.26						11320.57	
50	33	1463.17		40			3092.21						4595.38	
43	34				160								160	
47	34			982.34									982.34	
49	34	788.24					1036.25						1824.49	
50	34	2455.92					1840						4295.92	40
43	35		80		120								200	
48	39													711.57
49	39													480
45	29		43.17										43.17	168.49
46	29	1385.11											1385.11	182.35
47	29	40											40	80
48	30													56
43	31	115.22											115.22	
42	33				120								120	
44	33													80
50	22 Minn.	485.88											485.88	888.68
49	23			2.50									2.50	189.96
50	23	704.89		54.80									759.69	343.09
46	25													280.05
47	25													39.75
46	26													440
57	22		119.88		80			319.60			.51		519.99	
57	23		40										40	
58	15				152.09								152.09	
59	15												2.83	
57	20		4.50					1.75			1.08		5.19	
45	1 E. Wis.	133.33									.69		133.33	
41	31 Mich.												42.38	
42	31					42.38							42.38	
42	31					929.79							929.79	
43	31					456.85							456.85	
44	31					835.45							835.45	
45	31					4239.77							4239.77	
46	31					990							990	
41	32					1493.40							1493.40	
42	32					1360							1360	
43	32					400.05							400.05	
44	32					2281.50							2281.50	
45	32					5709.45							5709.45	
46	32					4974.49							4974.49	
42	33					1331.00							1331.00	
43	33					519.59							519.59	
44	33					2075.18							2075.18	
45	33					3878.99							3878.99	
46	33					3227.69							3227.69	
44	34					1452.85							1452.85	
45	34					2815.50							2815.50	
46	34					3182.49							3182.49	
43	35					1066.37							1066.37	
44	35					2978.74							2978.74	
45	35					2000.00							2000.00	
43	36					561.40							561.40	
44	36					1597.92							1597.92	
47	32					160							160	
47	33					1631.69							1631.69	
49	33					80							80	
47	35					475.82							475.82	
47	36					120							120	
48	36					440							440	
TOTAL	--	581709.13	73787.13	3378.24	2718.20	53308.36	17299.92	432.95	4793.45	216.99	91.28	283.72	738019.37	105495.81

THE CLEVELAND-CLIFFS IRON COMPANY AND SUBSIDIARY COMPANIES

ACREAGE STATEMENT - LANDS OWNED AND CONTROLLED - SHOWING OWNERSHIP BY COMPANIES ONLY

DECEMBER 31, 1925.

COMPANIES	UNPLATTED LANDS								PLATTED LANDS				ACRES OF LAND NOT TIMBERED "H"	ACRES OF LAND TIMBERED "I"	LANDS ON MINERAL FORMATION "J"	MINERAL RIGHTS RESERVED IN SALES "K"
	FEE "A"	SURFACE ONLY "B"	MINERALS ONLY "C"	LEASED MINERALS "D"	MINING OPTION "E"	TIMBER ONLY "F"	LEASED SURFACE "G"	WATER RIGHTS	FEE	SURFACE ONLY "G"	MINERALS ONLY	TOTAL ACRES				
CONSTITUANT COMPANIES (Entire stock owned by The C.C.I.Co. The Cleveland-Cliffs Iron Company)	561709.13	73767.13	3376.24	2716.20	53308.36	17299.92	432.95	4793.45	216.99	91.28	283.72	738019.37	221328.85	516690.52	105342.79	105495.81
ALLIED COMPANIES (A portion of the stock only owned by The C.C.I.Co.)																
The Negaunee Mine Co.	2.40	3.49		213.36						3.77		223.02	223.02		196.40	
Arctic Iron Co.	1004.55		37.98								103.53	1146.06	1146.06		288.02	78.99
The Athens Iron Mining Co.	41.76	.22	10.00	22.90						2.59		77.47	77.47		74.65	
Bunker Hill Mining Company	43.10		10.20									53.30	53.30		53.30	
Lucky Star Mining Company	49.74											49.74	49.74		49.74	
Michigan Mineral Land Co.	28175.62	834.43	24298.31									53308.36	53308.36		52473.93	
TOTAL ALLIED COMPANIES	29217.17	838.14	24356.49	236.26						6.36	103.53	54857.95	54857.95		53138.05	76.99
ASSOCIATE COMPANIES (The C.C.I.Co. has no ownership but acts as agent)																
American Iron Mining Co.	2501.70		314.80									2616.50	2616.50		2616.50	
GRAND TOTAL LANDS OWNED AND CONTROLLED - ALL COMPANIES	613528.00	74625.27	28049.53	2954.46	53308.36	17299.92	432.95	4793.45	216.99	97.64	387.25	795693.82	279003.30	516690.52	161297.34	105574.80

"A" - Lands where entire fee is owned.
 "B" - Lands where surface only is owned.
 "C" - Lands where minerals only are owned in known mineral district.
 "D" - Lands where our interest is confined to a mining lease.
 "E" - Lands where our interest is confined to a mining option from Michigan Mineral Land Co.
 "F" - Lands where timber only is owned.
 "G" - Lands where we own the entire fee, surface only, or minerals only in lands which are a part of recorded plats of towns or villages.

"H" - Lands which have been examined and which reports show do not contain sufficient timber to be classed as timber land.
 "I" - All lands not included in "H". This includes both lands that have been examined and other lands which have not but which were purchased for timber purposes and are classed as timber lands until such time as reports will show that they are barren either through fire or through operation of the Lumbering Department.
 "J" - Approximate acreage of lands inside the mineral formation as indicated by maps furnished to the Land Department by the Mining Department, April 1914.
 "K" - Acres of minerals reserved in Farm Land Sales, outside of mineral formation.

	UNPLATTED LANDS								PLATTED LANDS				ACRES OF LAND NOT TIMBERED	ACRES OF LAND TIMBERED	LANDS ON MINERAL FORMATION	MINERAL RIGHTS RESERVED IN SALES
	FEE	SURFACE ONLY	MINERALS ONLY	LEASED MINERALS	MINING OPTION	TIMBER ONLY	LEASED SURFACE	WATER RIGHTS	FEE	SURFACE ONLY	MINERALS ONLY	TOTAL ACRES				
Total Acreage Dec. 31, 1924 Purchased during 1925	612502.85	75291.31	26902.86	2735.81	53308.36	20999.69	326.50	4793.45	223.21	86.84	387.25	797568.23	279,055.24	518502.99	160862.66	104613.44
The C. C. I. Co.	2029.86	48.46	1126.03	218.65			106.35			10.44		3539.79	3539.79		1344.68	
The Athens Iron Mining Co.										.61		.61	.61			
The Negaunee Mine Co.										.14		.14	.14			
Cancelled Contracts (The C.C.I.Co.)	233.15											233.15	233.15			233.15
TOTAL	614765.86	75339.77	28028.89	2954.46	53308.36	20999.69	432.95	4793.45	223.21	96.03	387.25	801331.92	282828.93	518502.99	161297.34	104380.29
Sales - The C. C. I. Co.	1217.22	714.50							6.22	.39		1938.33	1217.45	720.88		
American Iron Mining Co.	20.64		20.64									3699.77	2608.18	3699.77		
Surrendered - The C. C. I. Co.						3699.77										
Operated and Classification Changed																
TOTAL	1237.86	714.50	20.64			3699.77			6.22	.39		5638.10	3825.63	1812.47		
TOTAL ACREAGE DEC. 31, 1925	613528.00	74625.27	28049.53	2954.46	53308.36	17299.92	432.95	4793.45	216.99	97.64	387.25	795693.82	279,003.30	516690.52	161297.34	104380.29

December 31st, 1925.

Mr. John M. Bush, Land Agent,
Building.

Dear Sir:

I hand you herewith a report for the year 1925 on various Department matters:

1. SUPERIOR REALTY COMPANY TAX TITLES

Tax Title Account balance as of January 1st, 1925	\$2,696.20	
Tax Title Account (M.M.L.Co.) as of Jan. 1st, 1925	<u>1,174.34</u>	
Total Tax Titles		\$3,870.54
Tax Titles Purchased 1925	918.64	
Tax Titles Purchased (M.M.L.Co.) 1925	<u>3,684.69</u>	<u>4,603.33</u>
Total		8,473.87
Redemptions 1925 Tax Title Account	582.61	
Redemptions 1925 (M.M.L.Co.) Tax Title Account	<u>553.58</u>	<u>1,136.19</u>
Balance Jan. 1, 1926 - Tax Title Account	3,032.23	7,337.68
Balance Jan. 1, 1926 (M.M.L.Co.) Tax Title Account	<u>4,305.45</u>	
		7,337.68

Considerable time and effort was made during the year to adjust the various tax items owned by this Company and we were successful in cleaning up quite a number of accounts. No purchases were made during the year on lands other than those in which we were interested in the mineral rights and only in such counties where Mr. Mather has ruled purchases be made.

The tax titles covered by the above account of \$7,337.68 are located in the following counties:

Alger County	\$199.38
Baraga County	332.51
Chippewa County	346.92
Delta County	47.26
Houghton County	357.03
Iron County	4,009.14
Marquette County	1,674.05
Schoolcraft County	<u>371.39</u>
	\$7,337.68

Amount of tax purchases for the year 1922 not requiring tax notices	\$4,427.89
Amount of Tax Titles previous to 1922 under process of adjustment	<u>2,909.79</u>
Total	\$7,337.68

We have had up with Messrs. Berg & Clancey during the year the question of the preparation of tax notices to be served on the owners of the surface of the lands represented by the account of \$2,909.79. Notices have been prepared and served covering tax titles in the counties on lots and lands where ownerships have been definitely determined. This covers the Counties of Houghton, Marquette, and Iron. In the Counties of Alger and Baraga, there is a possibility of the owners redeeming on account of the agricultural value. In Chippewa, Delta, and Schoolcraft Counties, no notices have been served. The tax titles in these counties are purchased under a ruling that all reserve mineral rights were to be protected. Since Mr. Mather's ruling of April 15th, 1924, no further tax titles have been purchased in these counties. It would be useless to incur the expense of serving tax notices as we would acquire lands we cannot sell. There is a possibility of these tax titles being cleaned up in the future by parties desiring to clear records. This month, Mr. S. J. Johnson of Sault Ste. Marie, Michigan, has redeemed tax titles in Chippewa County amounting to \$128.18. Continued efforts will be made during 1926 to complete the adjustment of these various titles.

2. TOWNSHIP AND CITY AFFAIRS

We have been successful during the past year in getting a better understanding with the various township and city officials who hold offices in the townships and cities where we have assessable property. Frequent visits have been made with these men, particularly in Alger County in which 56% of this Department's entire taxes are paid. We have concentrated our efforts in this County, particularly due to our large ownerships and increased tax cost. In the City of Munising we cooperated with the city officials to the extent of making an audit of their books and preparing a budget for them for the last four months of 1925. We find that the mere fact that we are giving this matter our close attention is bringing results as you will note from the following figures:

	Budget Prepared by Land Dept. Sept., Oct., Nov., Dec. 1925.	Actual Figures - Sept. Oct., Nov., Dec. 1925.
Disbursements	\$32,528.13	\$35,783.69
Receipts	17,050.00	26,562.95

The seemingly large difference in receipts is due to the fact that we figured the people of Munising would not pay for the coal sold them by the City until 1926. The City Clerk reports a larger percentage was paid in 1925 than was anticipated.

A budget for the year 1926 for the City of Munising was carefully prepared by us and accepted by the City officials, and we will make every effort to see that the members of the City Commission adhere to it.

A careful audit of Burt Township, Alger County, was made during the year by men from this Department and the Township officials were shown ways of reducing taxes. If the present officials can be kept in office, no doubt a showing can be made in this Township.

Closer cooperation with township officials was obtained in Munising Township, Alger County, where visits were made and attendance at some of their monthly meetings was productive of results. The Board abandoned a road project, the cost of which was to be in the neighborhood of \$3,000.00.

A successful effort was made with the Alger County Board of Supervisors to prevent them from entering into an arrangement with Luce, Mackinac, and Chippewa Counties for the establishment of a tuberculosis sanitarium. A meeting was held with the chairman during December and he was shown where the cost of such an institution would be prohibitive to the taxpayers of the County. We recommended that all patients from Alger County be sent to the Morgan Heights Sanitarium at Marquette, Michigan, which would result in a considerable saving to the County. All supervisors were interviewed previous to the meeting at which this matter came up, the result of which was their abandoning the new sanitarium project. This would have been an expensive proposition to The Cleveland-Cliffs Iron Company's interests if it had gone through; estimating Alger County's proportion of the cost at \$50,000.00 with a maintenance cost of \$12,500.00 per year. The Cleveland-Cliffs Iron Company's interests pay 53% of the taxes in this County. Their proportion of the cost, therefore, would have been \$26,600.00 and of the yearly operating cost, \$6,625.00.

The Marquette County Road Commission have ^{under} consideration the building of a new road south, being about sixteen miles in length from Princeton, Michigan. In order to make this road suitable for auto traffic, it would cost in the neighborhood of \$180,000.00. This Company owns two forties which would be crossed by the contemplated road. This office has refused the granting of a right of way. We are doing everything in our power to kill this project and up to this date have been successful in stopping the spending of any money.

We will make a special effort to keep the township officials in line for 1926 and their budgets will be particularly scrutinized.

The following situation is arising in some of the townships. The great bulk of the timber lands with the exception of those owned by The Cleveland-Cliffs Iron Company are being cut over. Our tax burden in these townships, therefore, will increase as we will be the only holder of lands of any value.

3. TAXES

An examination of The Cleveland-Cliffs Iron Company's comparative tax statement for the years 1924-25 shows a reduction in total taxes paid of \$39,110.65 for the year 1925. Included in this statement, however, are taxes chargeable to accounts receivable. Taking this into consideration, the total reduction is, therefore, \$46,583.66, the largest percentage being in Alger County, with some reductions in Baraga, Luce, and Marquette Counties.

We were successful this year in getting a reduction in valuation of \$10,000.00 on our mill site at Munising, from \$75,000.00 to \$65,000.00. This made a saving in taxes to the mill of \$787.50 based on a tax rate of \$5.28 per \$100.00 for 1925 as against a tax rate of \$6.33 per \$100.00 for 1924.

The City of Munising completed the paving of Munising Avenue during 1925. Our proportion of the special assessment as rendered by the City Clerk was \$7,167.25. We were successful in getting this reduced to \$4,053.53. Upon examination, we were able to eliminate

Sales of Lots to Other Parties	\$1,576.46
Amount Chargeable to L.S.&I. Railroad	1,048.98
Play Ground Lots	625.04
Total	<u>\$3,250.48</u>

We cooperated closely with the Alger County Board of Supervisors at their annual meeting in October, 1925, at which time the County budget was prepared, the result of which was a reduction in the County budget of \$33,279.00, the total being \$125,920.00 for 1925 as compared with \$159,199.00 for 1924.

As a result of our close attention to tax matters in Munising City and Alger County, The Munising Paper Company, The Munising Woodenware Company and the First National Bank have made a considerable saving.

We are going into the tax situation thoroughly and are making studies from different angles, and to that end, we are making up a series of statements showing valuations, taxes, etc. We attach hereto a number of these statements. We are also preparing maps for Board of Review purposes, affecting our ownerships.

4. LAND LOOKING

During the year approximately 154,000 acres of Company lands were examined under the supervision of Stephen Lowney, Sr. There still remains to be examined approximately 40,000 acres, being parts of groups 2, 3, 4, 6, 14, and 15. This acreage is now being examined by our regular crew of men.

5. REMARKS

Group 1 Lands. An examination of the reports of the land lookers covering Group 1 discloses the fact that there are 34,235.82 acres of practically worthless lands in this group, being open swamp, burnt over pine plains and valued at less than \$2.00 per acre, figured at the following stumpage rates:

White Pine Common	\$15.00 per M ft.
White Pine Down	6.00 Do.
Norway Pine Dead	6.00 "
Norway Pine	15.00 "
Jack Pine	12.00 "
Jack Pine	.25 per cord
Cedar Posts	.05 per piece
Cedar Ties	.35 Do.
Cedar Poles	.75 "
Cedar Shingles	5.00 per M ft.
Hemlock Ties	.25 per piece
Hemlock Bark	1.00 per cord
Hemlock	8.00 per M ft.
Tamarack Ties	.25 per piece
Tamarack	8.00 per M ft.
Spruce Pulpwood	5.00 per cord
Balsam Pulpwood	.50 Do.

Birch	\$12.00	per M ft.
Maple	12.00	Do.
Elm	12.00	"
Basswood	12.00	"
Beech	6.00	"
Black Ash	12.00	"
Spruce	12.00	"
Red Oak	12.00	"
Balsam	6.00	"
Hardwood Cordwood	.25	per cord

These lands are located mostly in Towns 47-9, 47 and 48-10, 47 and 48-11, and scattering lands through 46, 48, 49-8; 46, 48 and 49-9, 46 and 49-10; 46-11; and 46, 47, 48 and 49-12. These lands are colored green on map submitted to Mr. Mather in a report to him of December 29th, 1924. The taxes on this group of poor lands for 1925 were approximately \$4,500.00.

FOX RIVER BURN. There are 13,960 acres of Company lands located in 46 and 47-13; 46 and 47-14; 47, 48, and 49-15; and 49-16, known as the Fox River Burn. The taxes for 1925 amounted to \$1,583.61.

49-13 BURN. An examination of Stephen Lowney's, Jr., report for June, 1925, shows 5760 acres of old burning. The taxes for the year 1925 amounted to \$938.51.

The question should be considered of deeding these lands to the State of Michigan or else discontinue paying the taxes thereon. A study is being made as to whether the deeding of these lands would affect the taxes of this Company in the Townships in which they are located. Inasmuch as this Company pays a considerable portion of the taxes, it may be found that it would be just as advisable to carry these lands as let them become delinquent, taking into consideration the fact that there would be little chance of the tax burden decreasing.

Respectfully submitted,



HSN:CN

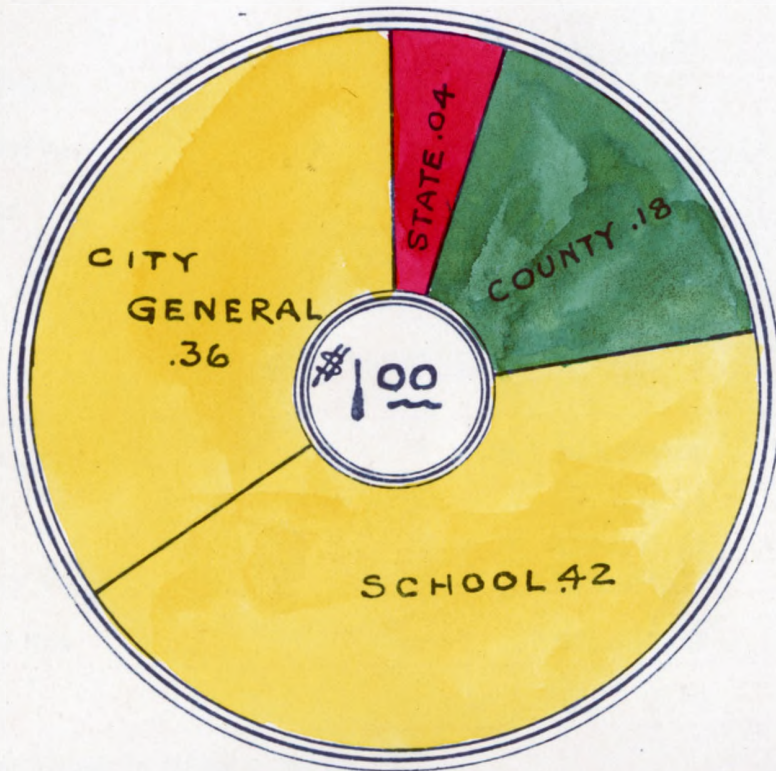

MUNICIPAL TAXES 1925

	Amt Per 100 ⁰⁰ Val	% Pd to Each 1 ⁰⁰
STATE	.21	.04
COUNTY	.95	.18
SCHOOL	2.24	.42
CITY GEN.	1.88	.36
TOTAL	5.28	1.00

CITY OF MUNISING TAXES

	1924	1925
Assessed Valuation	\$3,967,535.00	\$4,027,810.00
State Taxes	6,972.78	8,542.51
County Taxes	46,229.80	38,331.31
City Taxes	196,960.00	165,199.20
Total Taxes	250,162.58	212,073.02
1925 Decrease		38,089.56
Tax Rate	6.32	5.27

ALGER COUNTY TAXES

Assessed Valuation	\$13,142,094.00	\$12,757,363.00
State Taxes	24,011.77	28,062.50
County Taxes	159,199.00	125,920.00
Township & City Taxes	505,596.82	447,132.33
Total Taxes	688,807.59	601,114.83
Rate %	1.21	.99
1925 Decrease in County Taxes		33,279.00
1925 Decrease in all taxes entire County		87,692.76

The Cleveland-Cliffs Iron Company paid approximately 34% of the taxes for 1924 and on this basis our actual taxes to pay should be about \$29,000.00 less this year than last.

HSN:LED

BOARD OF EDUCATION

City of Munising

Comparison of Munising Board of Education Budget

	1922	1923	1924	1925
Retirement Bonds	20,000.00	34,600.00	33,400.00	32,200.00
Interest on Bonds	15,800.00	-	-	-
Primary	35,000.00	37,500.00	40,000.00	41,145.00
Janitors	5,500.00	6,000.00	8,500.00	7,500.00
Water - Light - Fuel	6,500.00	-	-	-
Transportation	5,500.00	5,000.00	5,500.00	5,000.00
General	31,700.00	-	20,000.00	-
Library	-	250.00	500.00	-
Books & Supplies	-	1,000.00	3,500.00	4,000.00
Bldg. & Repairs	-	2,650.00	4,000.00	755.00
Furniture & Fixtures	-	1,500.00	1,100.00	1,200.00
Cleaning Schools	-	400.00	600.00	500.00
Sundries	-	2,100.00	4,000.00	9,000.00 #
Loans at Bank	-	43,000.00	30,000.00	-
Lights	-	-	1,500.00	1,500.00
Fuel	-	8,000.00	7,500.00	4,500.00
Freight - Drayage - Exp	-	-	300.00	500.00
Yards & Grounds	-	-	5,000.00	-
Water	-	-	-	500.00
Washington School	-	-	-	21,700.00
	120,000.00	142,000.00	165,400.00	130,000.00

Includes \$5,000.00 for insurance premiums.

THE CLEVELAND-CLIFFS IRON COMPANY

LAND DEPARTMENT

VALUATIONS ON MANUFACTURING SITES
CITY OF MUNISING

	1913	1914	1915	1916	1917	1918	1919	1920	1921	1922	1923	1924	1925
The Munising Paper Company						Tax Commission							
Site	\$250,000.00	240,000.00	350,000.00	350,000.00	500,000.00	1,000,000.00	1,000,000.00	1,000,000.00	1,000,000.00	1,000,000.00	1,000,000.00	1,000,000.00	1,000,000.00
Personal	40,000.00	50,000.00	75,000.00	75,000.00	100,000.00	500,000.00	550,000.00	350,000.00	400,000.00	304,000.00	320,000.00	345,000.00	350,000.00
The Cleveland-Cliffs Iron Co. Sawmill													
Site	12,000.00	12,000.00	20,000.00	20,000.00	30,000.00	65,000.00	65,000.00	65,000.00	65,000.00	75,000.00	75,000.00	75,000.00	65,000.00
Personal	15,000.00	17,500.00	30,000.00	30,000.00	80,000.00	313,300.00	275,000.00	350,000.00	360,000.00	294,000.00	300,000.00	330,000.00	330,000.00
The Munising Woodenware Co.													
Site	17,000.00	22,000.00	28,000.00	28,000.00	34,000.00	146,500.00	146,500.00	146,500.00	146,500.00	146,500.00	146,500.00	146,500.00	146,500.00
Personal	6,000.00	13,800.00	16,300.00	16,300.00	16,000.00	135,000.00	90,000.00	90,000.00	110,000.00	64,000.00	67,000.00	71,000.00	80,000.00
Jackson & Tindle													
Site	20,000.00	23,000.00	23,000.00	10,000.00	41,000.00	75,000.00	75,000.00	75,000.00	75,000.00	75,000.00	75,000.00	75,000.00	75,000.00
Personal	20,000.00	26,500.00	30,000.00	29,000.00	29,000.00	194,280.00	150,000.00	175,000.00	135,000.00	166,000.00	130,000.00	117,000.00	125,000.00
Michigan Tanning & Extract Co.													
Site	40,000.00	40,000.00	40,000.00	40,000.00	40,000.00	140,000.00	140,000.00	140,000.00	75,000.00	50,000.00	45,000.00	35,000.00	N11
Personal	45,000.00	45,000.00	25,000.00	25,000.00	50,000.00	500,000.00	500,000.00	450,000.00					"
First National Bank													
Site													29,000.00
Personal													165,000.00
Peoples State Bank													
Site													9,500.00
Personal													22,500.00
Electric Light & Power Co.													
Site													40,000.00
Personal													20,000.00
TOTAL SITES	339,000.00	337,000.00	461,000.00	448,000.00	645,000.00	1,426,500.00	1,426,500.00	1,426,500.00	1,361,500.00	1,346,500.00	1,341,500.00	1,410,000.00	1,364,500.00
PERSONAL	126,000.00	152,800.00	176,300.00	156,300.00	275,000.00	1,642,580.00	1,565,000.00	1,415,000.00	1,005,000.00	828,000.00	817,000.00	1,070,500.00	1,122,500.00
Total Valuation City of Munising													
Real	1,487,365.00	1,544,800.00	1,108,800.00	1,107,460.00	1,452,480.00	2,576,440.00	2,584,440.00	2,609,970.00	2,523,600.00	2,556,390.00	2,581,335.00	2,621,235.00	2,643,210.00
Personal	362,470.00	408,390.00	352,770.00	322,695.00	454,650.00	1,977,435.00	1,916,295.00	1,813,455.00	1,483,905.00	1,300,270.00	1,294,000.00	1,346,300.00	1,384,600.00
Total	1,849,836.00	1,953,190.00	1,461,570.00	1,430,155.00	1,907,130.00	4,553,875.00	4,500,735.00	4,423,425.00	4,007,505.00	3,856,650.00	3,875,335.00	3,967,535.00	4,027,810.00
Taxes - State	9,262.77	4,947.15	4,522.00	3,289.20	4,718.65	5,966.98	15,816.95	15,497.22	12,338.28	10,306.05	9,273.18	6,972.78	8,542.51
County	32,778.05	33,183.00	24,427.00	36,731.60	38,001.03	44,417.46	50,647.35	53,109.12	57,709.14	49,086.98	46,229.80	46,229.80	38,331.31
City			29,231.00	28,603.10	27,597.95	57,360.94	59,062.00	69,000.00	60,000.00	51,000.00	88,000.00	83,000.00	75,000.00
School	25,000.00	35,000.00	25,423.00	25,310.15	25,965.00	30,800.12	34,178.25	48,057.56	76,864.80	81,005.08	95,492.16	113,960.60	90,199.20
Twp. Liability	2,500.00	2,900.00											
" Contingent	1,000.00	2,500.00											
Highway Repair	2,000.00	1,500.00											
" Improvement	1,000.00	4,000.00											
Bridge		500.00											
Village	17,298.95	27,645.79											
Total	90,839.77#	112,175.94#	83,603.00	93,934.05	96,282.63	138,545.50	159,704.55	185,663.90	206,912.22	189,528.50	241,852.32	250,163.18	212,073.02
Tax Rate per 100 Valuation	Twp. 3.98 Village 1.50	Twp. 4.34 Village 2.25	City 5.73	6.58	5.10	3.05	3.55	4.21	5.18	4.94	6.25	6.33	5.28
Amount Paid by Above Industries	25,482.00	32,277.82	36,517.29	39,762.94	46,920.00	93,604.50	106,198.25	119,627.15	122,584.70	111,420.30	134,906.25	156,767.60	131,485.27
Do. Others	65,357.77	79,898.12	47,085.71	54,171.11	49,362.63	44,941.00	53,506.30	66,036.75	84,327.52	78,108.20	106,946.07	93,395.58	80,587.75
Percent Paid by Above Industries	25%	25%	44%	42%	48%	68%	66%	64%	58%	57%	56%	63%	62%
Do. Others	75%	75%	56%	58%	52%	32%	34%	36%	42%	43%	44%	37%	38%
# Munising Township (City of Munising was incorporated in 1915). Includes both Village and Township.													
The Munising Paper Co.	.157	.148	.291	.297	.315	.329	.344	.305	.349	.338	.341	.339	.337
The C.C.I.Co. Sawmill	.015	.015	.034	.035	.057	.083	.075	.094	.106	.096	.097	.102	.098
The Munising Woodenware Co.	.012	.018	.030	.031	.026	.062	.052	.054	.064	.054	.055	.055	.056
Jackson & Tindle	.022	.025	.036	.014	.036	.059	.050	.057	.052	.063	.053	.048	.050
Michigan Tanning & Extract Co.	.046	.044	.044	.045	.047	.141	.142	.133	.019	.013	.012	.009	.000
First National Bank												.049	.052
Peoples State Bank												.008	.009
Electric Light & Power Co.												.015	.014
Total	.252	.250	.435	.422	.481	.674	.663	.643	.582	.564	.558	.625	.616

ALGER COUNTY TAXES

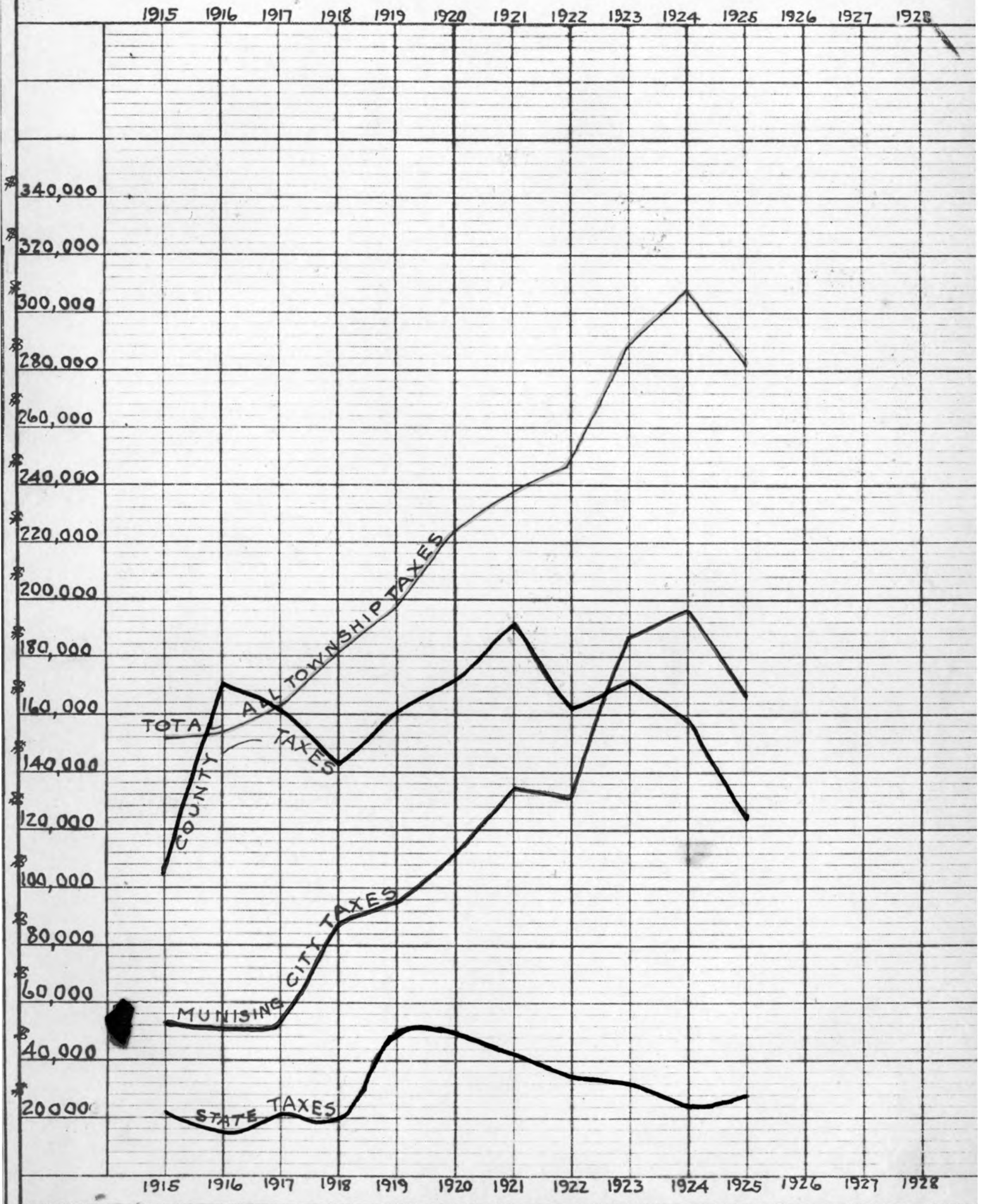

THE CLEVELAND - CLIFFS IRON COMPANY

LAND DEPARTMENT

COMPARATIVE TAX STATEMENT

1924 AND 1925 TAXES

Township	State Tax		County Tax		Township & City Taxes		Total Taxes	
	1924	1925	1924	1925	1924	1925	1924	1925
Au Train	3,005.31	3,182.85	19,925.35	14,281.85	15,500.00	15,500.00	38,430.66	32,964.70
Burt	2,942.64	3,583.86	19,509.84	16,081.24	50,199.00	46,358.90	72,651.48	66,024.00
Grand Island	787.59	949.35	5,221.73	4,259.87	7,900.00	4,970.00	13,909.32	10,179.22
Limestone	1,606.83	2,040.42	11,183.73	9,155.64	51,835.00	40,125.00	64,705.56	51,321.06
Mathias	1,406.13	1,376.75	9,322.69	6,177.64	25,503.12	25,900.00	36,231.94	33,454.39
Munising	3,147.22	3,769.36	20,866.21	16,913.57	69,439.40	59,800.00	93,452.83	80,482.93
Onota	2,305.13	2,728.80	15,283.10	12,244.46	48,000.00	53,840.00	65,588.23	68,813.26
Rock River	1,758.14	1,888.60	11,656.55	8,474.42	40,260.30	35,439.23	53,674.99	45,802.25
Munising City	6,972.78	8,542.51	46,229.80	38,331.31	196,960.00	165,199.20	250,162.58	212,073.02
Total County of Alger	24,011.77	28,062.50	159,199.00	125,920.00	505,596.82	447,132.33	688,807.59	601,114.83

CAJ:MB

ALGER COUNTY TAXES

City of Township	1917			1920			1921			1922		
	Valuation	Tax	Rate %	Valuation	Tax	Rate %	Valuation	Tax	Rate %	Valuation	Tax	Rate %
AuTrain	1,293,160	36,907.86	2.86	1,611,308	39,949.30	2.48	1,525,836	41,560.58	2.73	1,493,885	38,281.98	2.58
Burt	936,415	56,079.42	5.99	1,498,315	73,926.67	4.61	1,494,135	52,232.45	5.02	1,467,385	68,760.72	4.69
Grand Island	151,720	5,216.39	3.43	317,270	8,870.79	2.80	312,770	7,978.64	2.56	302,770	6,266.05	2.40
Mathias	691,645	34,827.26	5.06	738,140	42,248.13	5.73	734,675	37,192.57	5.31	753,320	36,936.80	4.91
Limestone	975,900	40,954.76	4.22	1,092,323	42,603.35	3.91	1,030,325	50,095.97	4.85	1,022,093	42,421.77	4.62
Munising	1,030,830	51,574.24	5.01	2,111,676	73,694.11	3.52	1,884,031	86,984.15	4.62	1,823,145	87,487.06	4.85
Onota	419,275	21,734.13	5.42	1,411,725	42,501.70	3.49	1,207,385	46,963.81	3.90	1,241,780	47,420.37	3.83
Rock River	1,407,050	65,891.17	4.06	1,192,905	53,753.57	3.81	1,351,840	57,697.85	4.37	1,283,790	57,084.20	4.46
Munising City	1,907,130	96,282.63	5.11	4,423,425	185,663.90	4.21	4,007,505	206,912.22	5.18	3,856,650	189,528.50	4.93
TOTAL	8,813,125	409,467.86	4.65	14,397,087	563,211.52	3.91	13,548,502	587,618.24	4.34	13,244,818	574,187.45	4.34
Marquette	58,983,798	1269,064.80	2.15	64,099,012	1960,037.11	3.06	66,177,466	2033,885.95	3.07	67,081,717	2024,503.95	3.02
Baraga	5,412,068	181,038.62	3.35	7,078,091	299,400.68	4.23	7,062,773	315,695.56	4.47	7,132,968	350,701.05	4.91
Luce	6,177,086	178,645.68	2.89	10,173,525	261,800.12	2.57	9,588,560	266,683.59	2.78	9,229,765	239,836.34	2.60
	1923			1924			1925					
City or Township	Valuation	Tax	Rate %	Valuation	Tax	Rate %	Valuation	Tax	Rate %			
AuTrain	1,480,495	42,131.06	2.85	1,482,875	38,430.66	2.59	1,290,850	32,964.70	2.56			
Burt	1,495,095	71,916.82	4.81	1,549,900	72,651.48	4.69	1,565,890	66,024.00	4.22			
Grand Island	268,270	9,536.05	3.56	264,870	13,909.32	5.26	264,870	10,179.22	3.85			
Mathias	765,650	38,118.00	4.98	740,625	36,231.94	4.93	601,650	33,454.39	5.56			
Limestone	1,062,748	49,733.92	4.68	1,038,450	64,705.56	6.26	1,041,530	51,321.06	4.93			
Munising	1,726,246	95,931.47	5.56	1,657,699	93,452.83	5.64	1,647,133	80,482.93	4.89			
Onota	1,212,910	65,929.64	5.44	1,214,110	65,588.23	5.43	1,192,400	68,813.26	5.78			
Rock River	1,347,240	60,583.79	4.53	1,226,030	53,674.99	4.39	1,125,230	45,802.25	4.07			
Munising City	3,875,335	241,852.32	6.25	3,967,535	250,162.58	6.32	4,027,810	212,073.02	5.27			
TOTAL	13,233,989	675,733.07	4.81	13,142,094	688,807.59	5.24	12,757,363	601,114.83	4.71			
Marquette	67,194,824	2111,346.35	3.14	67,471,807	2124,830.28	3.15	66,022,699	2132,159.16	3.23			
Baraga	7,108,272	388,572.91	5.47	7,752,615	393,358.45	5.07	8,845,310	395,445.80	4.47			
Luce	9,150,930	233,010.82	2.55	9,101,982	249,203.85	2.74	8,659,075	238,712.15	2.76			

THE CLEVELAND-CLIFFS IRON COMPANY
LAND DEPARTMENT

ALGER COUNTY
COMPARATIVE ASSESSED VALUATIONS

	Acres	1917		1918		1919		1920		1921		1922		1923		1924		1925	
			%		%		%		%		%		%		%		%		%
AuTrain Twp.	91,793.40	1,293,160	.147	1,629,095	.111	1,569,498	.109	1,611,308	.112	1,525,836	.113	1,493,885	.113	1,480,495	.112	1,482,875	.113	1,290,850	.101
Burt "	137,016.63	936,415	.106	1,501,270	.102	1,498,810	.105	1,498,315	.104	1,494,135	.110	1,467,385	.110	1,495,095	.113	1,549,900	.118	1,565,890	.123
Grand Island Twp.	13,821.05	151,720	.017	386,020	.027	336,520	.024	317,270	.022	312,770	.023	302,770	.023	269,270	.020	264,870	.020	264,870	.020
Mathias Twp.	45,472.45	691,645	.079	742,685	.051	719,975	.050	738,140	.051	734,675	.055	753,320	.057	765,650	.058	740,625	.056	601,650	.047
Limestone "	47,799.82	975,900	.111	1,123,415	.077	1,062,945	.074	1,092,323	.076	1,030,325	.076	1,022,093	.077	1,062,748	.080	1,038,450	.080	1,041,530	.082
Munising "	125,214.91	1,030,830	.117	2,115,625	.145	2,083,475	.146	2,111,676	.147	1,884,031	.139	1,823,145	.138	1,726,246	.130	1,657,699	.126	1,647,133	.129
Onota "	56,293.79	419,275	.047	1,223,495	.083	1,220,600	.085	1,411,725	.098	1,207,385	.089	1,241,780	.094	1,212,910	.092	1,214,110	.092	1,192,400	.093
Rock River"	50,527.33	1,407,050	.160	1,371,735	.093	1,336,215	.093	1,192,905	.083	1,351,840	.100	1,283,790	.097	1,347,240	.102	1,226,030	.093	1,125,230	.089
Munising City	1,907,130	216	4,553,875	.311	4,500,735	.314	4,423,425	.307	4,007,505	.295	3,856,650	.291	3,875,335	.293	3,967,535	.302	4,027,810	.316	
		8,813,125	1.00	14,647,215	1.00	14,328,773	1.00	14,397,087	1.00	13,548,502	1.00	13,244,818	1.00	13,233,989	1.00	13,142,094	1.00	12,757,363	1.00

COMPARATIVE EQUALIZED VALUATION

AuTrain Twp.	91,793.40	731,277	.127	1,629,095	.111	1,569,498	.109	1,611,308	.112	1,534,406	.113	1,493,885	.118	1,551,890	.123	1,582,875	.125	1,390,850	.113
Burt "	137,016.63	807,261	.140	1,501,270	.102	1,498,810	.105	1,498,315	.104	1,502,756	.112	1,467,385	.116	1,436,713	.114	1,549,900	.123	1,565,890	.128
Grand Island Twp.	13,821.05	118,446	.021	386,020	.027	336,520	.024	317,270	.022	314,221	.023	302,770	.024	409,796	.033	414,870	.033	414,870	.034
Mathias Twp.	45,472.45	432,905	.075	742,685	.051	719,975	.050	738,140	.051	738,570	.055	753,320	.059	735,952	.058	740,625	.059	601,650	.049
Limestone "	47,799.82	453,672	.079	1,123,415	.077	1,062,945	.074	1,092,323	.076	1,036,027	.076	877,093	.069	846,731	.068	888,450	.070	891,530	.073
Munising "	125,214.91	866,059	.150	2,115,625	.145	2,083,475	.146	2,111,676	.147	1,894,191	.140	1,823,145	.143	1,755,212	.139	1,657,699	.131	1,647,133	.134
Onota "	56,293.79	364,300	.063	1,223,495	.083	1,220,600	.085	1,411,725	.098	1,214,281	.089	1,241,780	.098	1,199,892	.096	1,214,110	.096	1,192,400	.097
Rock River"	50,527.33	647,555	.112	1,371,735	.093	1,336,215	.093	1,192,905	.083	1,291,840	.095	1,068,790	.084	1,034,190	.082	926,030	.073	825,230	.067
Munising City	1,343,455	233	4,553,875	.311	4,500,735	.314	4,423,425	.307	4,022,210	.297	3,681,650	.289	3,603,939	.287	3,672,535	.290	3,732,810	.305	
		5,764,930	1.00	14,647,215	1.00	14,328,773	1.00	14,397,087	1.00	13,548,502	1.00	12,709,818	1.00	12,574,315	1.00	12,647,094	1.00	12,262,363	1.00

THE CLEVELAND-CLIFFS IRON COMPANY
LAND DEPARTMENT

ALGER COUNTY TAXES
Au Train Township

AUTRAIN TOWNSHIP	1915	1916	1917	1918	1919	1920	1921	1922	1923	1924	1925
State	2,457.00	\$1,868.50	2,568.48	2,134.62	5,515.65	5,409.81	4,678.43	3,992.10	3,993.22	3,005.31	3,182.85
County	13,209.00	20,863.59	20,664.92	15,689.83	17,661.80	18,539.49	21,882.15	18,298.36	21,137.84	19,925.35	14,281.85
Township	2,400.00	2,000.00	2,000.00	4,000.00	4,000.00	3,000.00	2,500.00	2,500.00	2,500.00	3,000.00	3,000.00
Road Repair	2,243.38	2,827.33	2,827.23	3,000.00	2,000.00	1,000.00	1,500.00	2,000.00	2,000.00	2,000.00	2,000.00
Highway Improvement	2,243.38	2,827.33	2,827.23	3,500.00	2,500.00	5,000.00	2,500.00	2,500.00	2,500.00	2,500.00	2,500.00
Bridge	1,000.00	1,000.00	500.00	100.00							
School	4,500.00	4,500.00	5,500.00	6,000.00	5,000.00	7,000.00	8,500.00	9,000.00	10,000.00	8,000.00	8,000.00
Total	28,052.76	35,886.55	36,907.86	34,624.45	36,677.45	39,949.30	41,560.58	38,290.98	42,161.06	38,430.66	32,964.70
Total Township Taxes Only	12,386.76	13,154.66	13,654.46	16,600.00	13,500.00	16,000.00	15,000.00	16,000.00	17,000.00	15,500.00	15,500.00

BURT TOWNSHIP	Burt Township										
State	2,935.00	2,327.70	2,835.35	1,967.12	5,267.60	5,249.26	4,550.55	3,921.31	3,696.85	2,942.64	3,583.86
County	18,855.00	25,993.60	22,834.21	14,643.06	16,867.50	17,989.31	21,424.34	17,965.57	19,569.03	19,509.84	16,081.24
Township	2,000.00	2,000.00	2,000.00	2,000.00	2,000.00	3,000.00	3,000.00	3,000.00	3,000.00	3,000.00	3,000.00
Road Repair	3,921.80	4,001.75	4,354.93	4,682.07	7,506.35	7,494.05	7,513.78	7,336.92	7,475.47	7,749.50	7,829.45
Highway Improvement	3,921.80	4,001.75	4,354.93	4,682.07	7,506.35	7,494.05	7,513.78	7,336.92	7,475.47	7,749.50	7,829.45
Indebtedness	2,000.00	3,000.00	3,000.00	3,000.00	5,000.00	5,000.00					
Bridge	1,000.00	1,000.00	1,000.00	1,000.00	1,000.00	1,000.00	1,000.00	500.00	1,000.00	2,000.00	2,000.00
School	10,000.00	12,000.00	14,000.00	15,000.00	17,000.00	25,000.00	25,000.00	25,000.00	25,000.00	25,000.00	20,000.00
Bond	1,500.00	1,500.00	1,500.00	1,500.00	1,500.00	1,500.00	1,500.00	1,500.00	1,500.00	1,500.00	1,500.00
Forest Fire	200.00		200.00	200.00	200.00	200.00	200.00	200.00	200.00	200.00	1,200.00
Emergency							3,000.00	2,000.00	3,000.00	3,000.00	4,500.00
Total	43,333.60	55,824.80	56,079.42	48,674.32	63,847.80	73,926.67	74,782.45	68,780.72	71,916.82	72,651.48	66,024.00
Total Township Taxes Only	24,543.60	27,503.50	30,409.86	32,064.14	41,712.70	50,688.10	46,727.56	46,873.84	48,650.94	50,199.00	46,358.90

GRAND ISLAND TOWNSHIP	Grand Island Township										
State	435.00	320.70	416.02	505.77	1,182.55	1,111.54	920.98	809.11	1,054.44	787.59	949.35
County	2,354.00	3,693.58	3,350.37	3,765.16	3,786.90	3,809.25	4,307.66	3,706.95	5,581.61	5,221.73	4,259.87
Township	500.00	250.00	250.00	250.00	250.00	250.00	250.00	250.00	400.00	400.00	450.00
Highway	500.00	250.00	500.00	2,000.00	2,000.00	2,000.00	1,000.00	1,000.00	1,000.00	6,000.00	3,020.00
School	400.00	800.00	700.00	1,000.00	1,500.00	1,700.00	1,500.00	1,500.00	1,500.00	1,450.00	1,450.00
Library										50.00	50.00
Total	4,189.00	5,314.28	5,216.39	7,520.93	8,719.45	8,870.79	7,978.64	7,266.06	9,536.05	13,909.32	10,179.22
Total Township Taxes Only	1,400.00	1,300.00	1,450.00	3,250.00	3,750.00	3,950.00	2,750.00	2,750.00	2,900.00	7,900.00	4,970.00

LIMESTONE TOWNSHIP	Limestone Township										
State	1,600.34	1,205.82	1,593.44	1,472.02	3,735.45	3,826.90	3,143.73	2,731.36	2,178.77	1,686.83	2,040.42
County	8,646.00	13,465.46	12,832.58	10,957.53	11,961.45	13,114.83	14,704.00	12,513.75	12,533.15	11,183.73	9,155.64
Township	2,000.00	2,000.00	2,000.00	2,000.00	2,000.00	2,000.00	2,000.00	2,000.00	2,000.00	3,000.00	3,000.00
Highway Improvement	2,804.00	3,260.40	3,414.37	4,879.50	5,617.08	5,461.62	5,461.62	5,461.62	5,111.00	5,300.00	5,000.00
Highway Repair	2,804.00	3,260.40	3,414.37	4,879.50	5,617.08	5,461.62	5,461.62	5,461.62	5,111.00	5,300.00	5,000.00
Bridge	1,500.00	1,000.00	1,000.00	1,000.00	500.00	500.00	500.00	1,000.00	1,500.00	1,000.00	1,000.00
Additional Highway		5,000.00	2,000.00								
Indebtedness	1,500.00	3,300.00		4,200.00	4,200.00	4,200.00	4,000.00	3,000.00	3,000.00	3,000.00	24,625.00
Bond & Interest	4,000.00	4,000.00	4,400.00	9,906.89	11,190.00	12,700.00	13,825.00	14,025.00	17,800.00	27,985.00	1,500.00
School	6,988.00	7,890.00	8,500.00	500.00	300.00	300.00	500.00	500.00	750.00	1,500.00	1,500.00
Buildings & Repairs	1,400.00	2,050.00	500.00	500.00	500.00	500.00	500.00	500.00	750.00	750.00	
Fire Protection	500.00	1,000.00	800.00	1,250.00	500.00	500.00	500.00	500.00			
Road Grader			800.00	500.00							
Gravel										4,000.00	
School Bond											
County Fair	750.00										
Total	34,472.34	47,432.08	40,954.76	42,045.44	45,621.06	42,603.35	50,095.97	42,421.77	49,738.92	54,705.56	51,321.06
Total Township Taxes Only	24,226.00	32,760.80	26,528.74	29,615.69	29,924.16	25,661.62	32,248.24	27,176.62	35,022.00	51,835.00	40,125.00

MATHIAS TOWNSHIP	1915	1916	1917	1918	1919	1920	1921	1922	1923	1924	1925
State	\$1,380.00	1,094.50	1,520.50	973.14	2,530.15	2,586.03	2,227.70	2,013.21	1,893.72	1,406.13	1,376.75
County	7,460.00	12,223.01	12,245.16	7,243.98	8,102.00	8,862.36	10,419.52	9,223.59	10,024.28	9,322.69	6,177.64
Contingent	1,000.00	2,000.00	2,000.00	2,000.00	2,000.00	2,000.00	2,000.00	2,000.00	2,000.00	1,800.00	2,000.00
Highway Improvement	1,484.75	1,812.22	2,030.80	3,458.22	2,599.24	3,599.87	1,845.35	2,000.00	3,000.00	1,000.00	1,000.00
Highway Repair	1,484.75	1,812.22	2,030.80	3,458.22	2,599.24	3,599.87	1,845.35	2,000.00	3,000.00	3,703.12	3,000.00
School	5,000.00	8,500.00	14,000.00	12,000.00	15,000.00	20,000.00	20,000.00	19,500.00	16,000.00	19,000.00	19,000.00
Indebtedness	1,000.00		1,000.00								
Bridge	500.00				100.00	500.00	700.00	200.00	200.00		500.00
Drain						800.00					300.00
Forest Fire						300.00					
Total	19,309.50	27,441.95	34,827.26	29,133.55	32,930.63	42,248.13	37,192.57	36,936.80	38,118.00	36,231.94	33,454.39
Total Township Taxes Only	10,469.50	14,124.44	21,061.60	20,216.44	22,298.48	30,799.74	24,545.35	25,700.00	26,200.00	25,503.12	25,900.00
CITY OF MUNISING											
City of Munising											
State	4,522.00	3,629.20	4,718.55	5,966.98	15,816.95	15,497.22	12,338.28	10,306.06	9,273.18	6,972.79	6,542.51
County	24,427.00	35,731.60	38,001.03	44,417.46	50,647.35	53,109.12	57,709.14	47,217.37	49,086.98	46,229.80	33,331.31
City	29,277.35	28,635.35	27,597.95	57,350.94	59,062.00	69,000.00	60,000.00	51,000.00	68,000.00	63,000.00	75,000.00
School	25,452.53	25,343.79	25,965.00	30,800.12	34,178.25	48,057.56	75,864.80	81,005.08	95,492.16	113,960.60	90,199.20
Total	83,678.88	94,539.94	96,282.53	138,545.50	159,704.55	185,653.90	206,912.22	189,528.50	241,852.32	250,163.18	212,073.02
Total City Taxes Only	54,729.88	53,979.14	52,562.95	68,161.06	93,240.25	117,057.56	135,864.80	132,005.08	183,492.16	196,960.60	165,199.20
MUNISING TOWNSHIP											
Munising Township											
State	3,244.00	2,566.80	3,041.87	2,772.12	7,321.92	7,398.13	5,786.08	4,971.99	4,516.40	3,147.22	3,759.36
County	17,525.00	26,429.77	24,497.37	20,535.34	23,445.60	25,353.54	27,062.93	22,321.15	23,907.23	20,866.21	16,913.57
Township	2,000.00	2,000.00	2,000.00	3,000.00	3,000.00	3,000.00	3,000.00	3,000.00	3,000.00	3,000.00	4,000.00
Highway Improvement	3,000.00	4,182.17	4,000.00	3,600.00	9,000.00	9,000.00	9,000.00	9,400.00	8,000.00	7,000.00	8,000.00
Road Repair	3,000.00	4,182.17	4,000.00	1,400.00	6,000.00	6,000.00	6,000.00	9,400.00	8,000.00	7,000.00	8,000.00
School	14,605.90	14,690.13	14,055.00	14,199.88	15,821.75	22,942.44	36,135.14	38,293.92	46,507.84	51,439.40	39,800.00
Forest Fire								1,000.00	2,000.00	1,000.00	
Total	43,374.90	53,851.04	51,574.24	45,607.34	64,589.47	73,694.11	86,984.15	88,287.06	95,931.47	93,452.83	80,492.93
Total Township Taxes Only	22,605.90	25,054.47	24,035.00	22,199.88	33,821.75	40,942.44	54,135.14	61,093.92	67,507.84	69,439.40	59,800.00
ONOTA TOWNSHIP											
Onota Township											
State	1,355.00	1,027.70	1,279.53	1,603.16	4,269.85	4,179.27	3,692.60	3,316.19	3,087.29	2,305.16	2,728.60
County	7,321.03	11,476.88	10,304.60	11,933.68	13,735.60	14,322.43	17,271.21	15,202.38	16,342.35	15,283.10	12,244.46
Township	2,000.00	1,000.00	4,000.00	3,500.00	1,000.00	5,500.00	3,000.00	3,000.00	3,500.00	4,500.00	4,000.00
Highway Improvement	4,000.00	1,000.00			6,500.00	6,500.00	6,500.00	6,500.00	6,500.00	6,500.00	6,500.00
Highway Repair	2,117.25	2,059.97		1,000.00	6,500.00	6,000.00	6,500.00	6,500.00	6,500.00	6,500.00	6,500.00
School	3,000.00	4,500.00	3,500.00	7,000.00	6,000.00	5,500.00	5,000.00	5,500.00	15,000.00	13,500.00	20,840.00
Bridge	1,000.00	1,000.00	500.00	500.00	1,000.00	500.00		1,000.00	4,000.00	6,000.00	6,000.00
Agricultural Society		500.00									
Bond			2,000.00	2,000.00	2,000.00	2,000.00	2,000.00				
Bond & Interest			150.00	1,000.00	1,000.00	500.00	1,000.00	5,900.00	10,500.00	10,500.00	10,000.00
Building				3,000.00			1,000.00				
Fire Fund							500.00	500.00	500.00	500.00	
School Building							500.00				
Total	20,793.25	22,564.55	21,734.13	31,536.84	42,025.45	42,501.70	45,953.81	47,420.57	65,929.64	65,588.23	68,813.26
Total Township Taxes Only	12,117.25	10,059.97	10,150.00	18,000.00	24,000.00	24,000.00	26,000.00	28,900.00	46,500.00	48,000.00	53,840.00
ROCK RIVER TOWNSHIP											
Rock River Township											
State	2,444.00	1,704.60	2,274.41	1,797.39	4,695.80	4,945.90	3,931.32	3,430.75	2,660.85	1,758.14	1,888.60
County	18,203.00	19,035.04	18,316.75	13,379.59	15,036.50	16,949.67	18,387.73	15,718.05	14,085.04	11,656.55	8,474.42
Township	2,000.00	2,000.00	1,500.00	2,000.00	1,000.00	1,000.00	2,000.00	1,500.00	2,000.00	2,000.00	1,500.00
Highway Improvement	5,374.50	5,000.00	4,650.00	7,000.00	3,429.00	3,429.00	5,549.20	6,417.70	6,418.95	6,130.15	2,813.08
Highway Repair	5,374.50	5,000.00	4,650.00	7,000.00	3,429.00	3,429.00	3,229.50	6,417.70	6,418.95	6,130.15	5,262.15
Road Repair	5,000.00	5,000.00	6,000.00				2,600.00	2,600.00	5,000.00		
School Bond & Interest	5,000.00	3,500.00	3,500.00	3,500.00			20,000.00	20,000.00	22,500.00	25,000.00	25,000.00
Highway Bond & Interest	20,050.00	12,000.00	15,000.00	19,000.00	20,000.00	20,000.00	20,000.00	20,000.00			
School	1,000.00		500.00	500.00			1,000.00	1,000.00	1,500.00	1,000.00	500.00
Cemetery	1,000.00		500.00	500.00		1,000.00	2,000.00				
Bridge				500.00			3,000.00				
Exigency											
Indebtedness											
Total	60,446.00	54,239.64	56,891.17	55,176.98	48,590.40	53,753.57	57,697.85	57,084.20	60,583.79	53,674.99	45,802.25
Total Township Taxes Only	44,799.00	33,500.00	36,300.00	40,000.00	28,868.00	31,858.00	35,378.80	37,935.40	43,837.90	40,260.30	35,439.23
Grand Total Alger County	337,650.23	397,094.83	400,467.86	432,865.36	502,706.26	563,211.52	610,118.24	575,996.66	675,733.07	688,808.19	601,114.83

HSM:CAJ:CM:4.
11/20/25.

THE CLEVELAND-CLIFFS IRON COMPANY

LAND DEPARTMENT

	1913	1914	1915	1916	1917	1918	1919	1920	1921	1922	1923	1924	1925
C.C.I.Co. Grand Island													
Acres	12,726.89	12,726.89	12,726.89	12,726.89	12,726.89	12,726.89	12,726.89	12,726.89	12,726.89	12,726.89	12,726.89	12,836.94	12,836.94
Valuation	73,790.00	72,015.00	72,015.00	72,015.00	134,270.00	248,720.00	242,720.00	236,020.00	233,820.00	235,920.00	236,020.00	233,920.00	233,920.00
Total Taxes Paid	3,718.51	2,869.52	3,634.17	4,614.83	4,666.21	5,227.72	6,364.97	6,673.11	6,023.60	5,714.64	8,344.14	12,405.98	9,096.79
C.C.I.Co. Wood Island													
Acres	188.09	188.09	188.09	188.09	188.09	188.09	188.09	188.09	188.09	188.09	188.09	188.09	188.09
Valuation	950.00	950.00	950.00	950.00	1,825.00	1,850.00	1,850.00	1,900.00	1,900.00	1,900.00	1,900.00	1,900.00	1,900.00
Total Taxes Paid	49.04	37.83	47.94	60.95	63.40	38.97	48.76	53.88	48.96	46.01	68.28	100.90	73.88
C.C.I.Co. Williams Island													
Acres	32.80	32.80	32.80	32.80	32.80	32.80	32.80	32.80	32.80	32.80	32.80	32.80	32.80
Valuation	200.00	200.00	200.00	200.00	400.00	400.00	400.00	400.00	400.00	400.00	400.00	400.00	400.00
Total Taxes Paid	10.32	7.96	10.11	12.82	13.87	8.45	10.53	11.34	10.30	9.70	14.36	21.24	15.55
C.C.I.Co. Main Land													
Acres	114.35	114.35	114.35	114.35	114.35	114.35	114.35	114.35	114.35	119.97	119.97	119.97	119.97
Valuation	625.00	625.00	625.00	625.00	1,050.00	950.00	950.00	1,000.00	1,000.00	1,075.00	1,075.00	1,075.00	1,075.00
Total Taxes Paid	32.26	24.81	31.59	40.03	36.44	20.01	25.02	28.36	25.77	26.06	38.64	57.05	41.81
C.C.I.Co. Grand Island Personal													
Valuation	2,050.00	2,050.00	2,650.00	2,650.00	3,300.00	104,500.00	63,500.00	57,000.00	52,500.00	42,500.00	11,500.00	7,000.00	7,000.00
Total Taxes Paid	105.84	81.60	133.83	169.82	114.57	2,184.28	1,658.40	1,609.69	1,352.74	1,029.78	412.76	371.95	271.24
Grand Total Taxes Grand Isl. Twp. Paid By C.C.I. Company	3,915.97	3,021.72	3,857.64	4,898.45	4,894.49	7,479.43	8,107.68	8,376.38	7,461.37	6,826.19	8,878.18	12,956.52	9,499.27
Others Grand Island													
Acres	309.49	309.49	309.49	309.49	309.49	309.49	309.49	309.49	309.49	309.49	309.49	199.44	199.44
Valuation	300.00	300.00	525.00	525.00	975.00	1,700.00	2,100.00	2,100.00	2,100.00	2,100.00	2,100.00	2,100.00	2,100.00
Taxes	15.48	11.95	26.51	33.68	32.85	44.13	55.09	59.38	54.13	50.90	75.43	111.43	81.66
Others Grand Island Twp. Personal Property													
Valuation	2,850.00	4,450.00	4,450.00	4,500.00	5,450.00	7,150.00	16,200.00	11,150.00	11,150.00	11,150.00	11,150.00	11,150.00	11,150.00
Taxes	147.12	177.19	224.50	288.37	189.22	150.26	424.62	315.00	287.32	270.28	400.26	591.72	428.64
Others Main Land													
Acres	628.54									622.97		622.97	622.97
Valuation	1,750.00	2,500.00	2,500.00	2,500.00	4,350.00	8,250.00	8,250.00	8,250.00	8,250.00	8,175.00	8,175.00	7,325.00	7,000.00
Taxes	90.35	99.49	126.33	160.28	150.97	173.45	216.63	233.37	212.61	198.16	248.32	388.74	271.24
Total Val. Grand Isl. - Real Estate	74,090.00	72,315.00	72,540.00	72,540.00	135,245.00	250,420.00	244,820.00	238,120.00	235,920.00	238,020.00	238,120.00	236,020.00	236,020.00
Personal	4,780.00	6,350.00	6,950.00	7,000.00	8,600.00	111,500.00	79,550.00	68,000.00	63,500.00	53,500.00	22,500.00	18,000.00	18,000.00
Total	78,990.00	78,665.00	89,490.00	79,540.00	143,845.00	361,920.00	324,370.00	306,120.00	299,420.00	291,520.00	260,620.00	254,020.00	254,020.00
Total Taxes " " Real Estate	3,733.99	2,881.47	3,660.68	4,648.51	4,699.06	5,271.85	6,420.06	6,732.49	6,077.73	5,765.54	8,419.57	12,517.41	9,187.63
" " " " Personal	245.50	252.88	350.82	445.50	298.63	2,331.47	2,079.08	1,920.47	1,636.23	1,296.46	807.68	955.17	694.03
Total	3,979.29	3,134.35	4,011.50	5,094.01	4,997.69	7,603.32	8,499.14	8,652.96	7,713.96	7,062.00	9,227.25	13,472.58	9,881.66
Total Valuation Wood Island	950.00	950.00	950.00	950.00	1,825.00	1,850.00	1,850.00	1,900.00	1,900.00	1,900.00	1,900.00	1,900.00	1,900.00
Total Taxes " "	49.04	37.83	47.94	60.95	63.40	38.97	48.76	53.88	48.96	46.01	68.28	100.90	73.88
Total Valuation Williams Island	200.00	200.00	200.00	200.00	400.00	400.00	400.00	400.00	400.00	400.00	400.00	400.00	400.00
Total Taxes " "	10.32	7.96	10.11	12.82	13.87	8.45	10.53	11.34	10.30	9.70	14.36	21.24	15.55
Total Val. Main Land - Real Estate	2,375.00	3,125.00	3,125.00	3,125.00	5,400.00	9,200.00	9,200.00	9,200.00	9,250.00	9,250.00	9,250.00	8,400.00	8,000.00
" " " " - Personal	150.00	150.00	150.00	150.00	150.00	150.00	150.00	150.00	150.00	150.00	150.00	150.00	150.00
Total	2,525.00	3,275.00	3,275.00	3,275.00	5,550.00	9,350.00	9,350.00	9,350.00	9,400.00	9,400.00	9,400.00	8,550.00	8,150.00
Total Taxes Main Land - Real Estate	122.61	124.30	157.92	200.31	187.41	193.46	241.65	251.73	238.38	224.22	286.96	445.79	307.63
Personal	7.66	5.91	7.51	12.69	5.16	3.07	3.94	4.22	3.83	3.60	5.34	7.90	5.85
Total	130.27	130.21	165.43	213.00	192.57	196.53	245.59	255.95	242.21	227.82	292.30	453.69	313.48
Total Acres Grand Island Twp. 14,000.16													
Total Val. " " " " R. Est.	77,615.00	76,590.00	76,815.00	76,815.00	142,870.00	261,870.00	256,270.00	249,670.00	247,470.00	249,570.00	249,670.00	246,720.00	246,720.00
" " " " " Personal	4,900.00	6,500.00	7,100.00	7,150.00	8,750.00	111,650.00	79,700.00	68,150.00	63,650.00	53,650.00	22,650.00	18,150.00	18,150.00
Total	82,515.00	83,090.00	83,915.00	83,965.00	151,620.00	373,520.00	335,970.00	317,820.00	311,120.00	303,220.00	272,320.00	264,870.00	264,870.00
Total Taxes " " " " R. Est.	3,915.96	3,051.56	3,876.65	4,922.59	4,963.74	5,512.73	6,721.00	7,069.44	6,375.37	5,045.47	8,789.17	13,085.34	9,581.13
" " " " " Personal	252.96	258.79	358.33	458.19	303.79	2,334.54	2,083.02	1,924.69	1,640.06	1,300.06	813.02	963.07	699.88
Total	4,168.92	3,310.35	4,234.98	5,380.78	5,267.53	7,847.27	8,804.02	8,994.13	8,015.43	7,345.53	9,602.19	14,048.41	10,281.01

Note: These Tax Items include a collection fee of 1%.

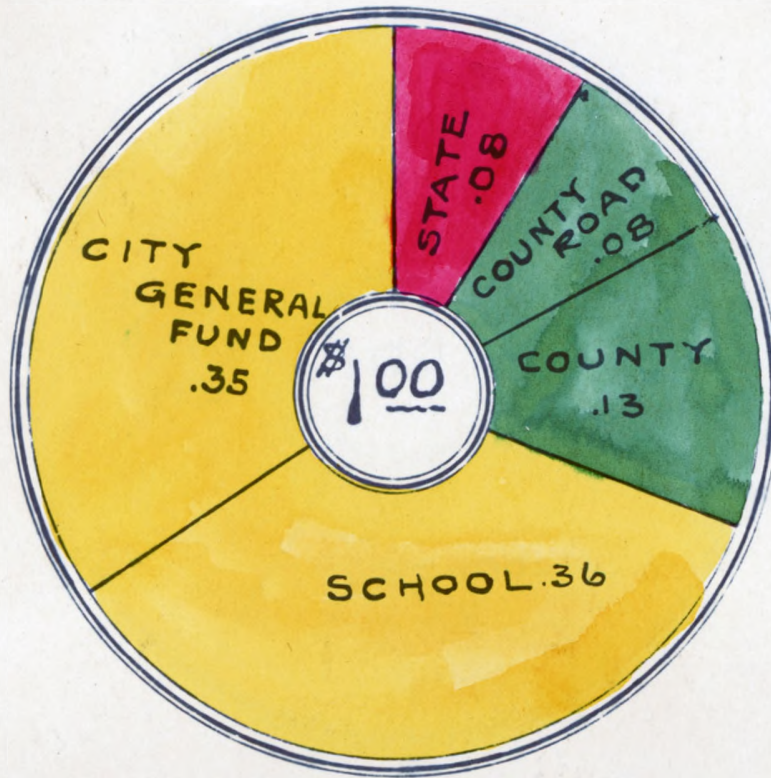

ISHPEMING TAXES 1925

	Amt Per 100 ⁰⁰ Val	% Pd. to each 100
STATE	.27	.08
COUNTY ROAD	.25	.08
COUNTY	.42	.13
SCHOOL	1.13	.36
CITY GEN. FUND	1.08	.35
TOTAL	\$ 3.15	\$ 1.00

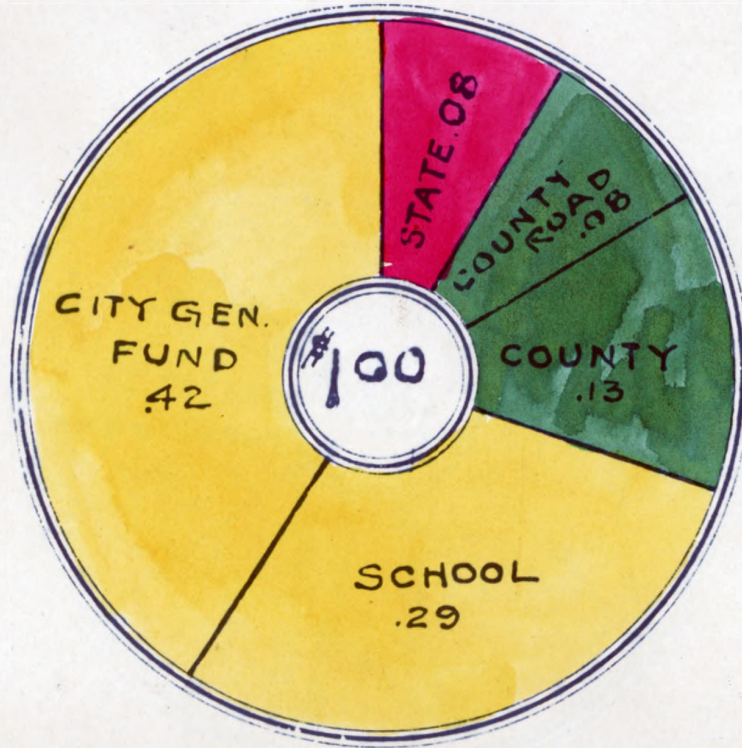

MARQUETTE TAXES 1925

	Amt Per 100 th Val	% Pd to each 1 st
STATE	.27	.08
COUNTY ROAD	.25	.08
COUNTY	.42	.13
SCHOOL	.95	.29
CITY GEN TAX	1.37	.42
	3.26	1.00

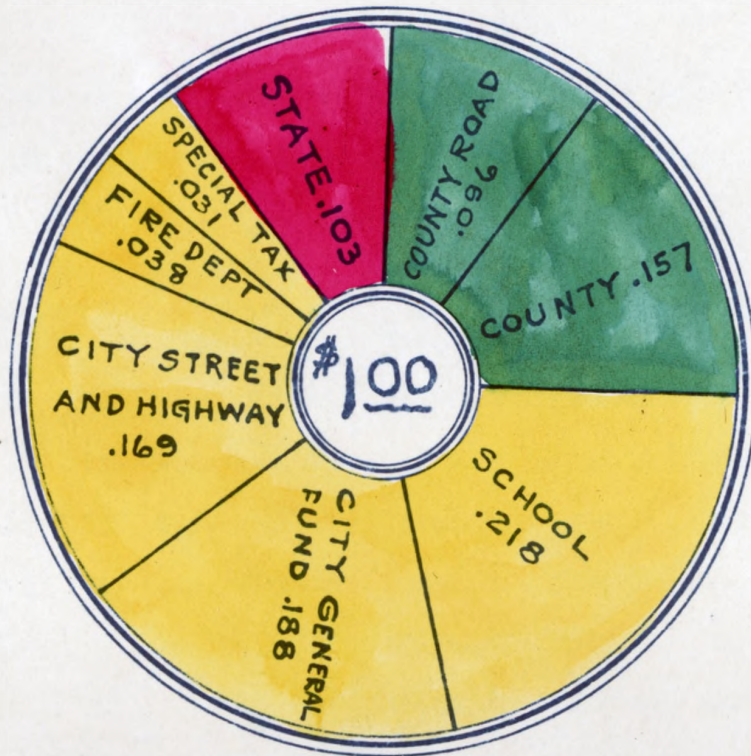

NEGAUNEE TAXES 1925

	Amt Per 100% Val.	% Pd. to each 1 ⁰⁰
STATE	.27	.103
COUNTY ROAD	.25	.096
COUNTY	.41	.157
SCHOOL	.57	.218
CITY GEN. FUND	.49	.188
CITY STRET & HIGHWAY	.44	.169
FIRE DEPT	.10	.038
SPECIAL TAX	.08	.031
TOTAL	\$ 2.61	\$ 1.000

Marquette, Mich.,
January 27th, 1926.

Mr. John M. Bush, Land Agent,
The Cleveland-Cliffs Iron Company,
Negaunee, Michigan.

Dear Sir:

Following is a report of the land looking during the year 1925.

The following crews were employed and the results of their work is shown in the following statement:

Name of the Cruiser	Date Started	Date Stopped	No. of	Cost of Labor	Cost of Supplies	Total Cost	Cost per Acre
			Acres Examined				
M.J. McQuigan	Feb. 11, 1925	Sept. 9, 1925	26861.14	\$1988.83	\$366.88	\$2357.71	.088
C.F. Hancock	June 17, 1925	Aug. 29, 1925	11368.68	1060.00	264.43	1324.43	.117
T.C. Howie	May 16, 1925	Sept. 13, 1925	16753.96	1780.00	242.75	2022.75	.121
S. Higgins	July 1, 1925	Aug. 24, 1925	10264.79	1275.00	314.38	1589.38	.155
S. Lowney, Jr.	Yearly		50256.76	2853.52	803.70	3657.22	.073
S. Lowney	Yearly		38425.11	3910.00	494.80	4404.80	.115
making a total of			153930.34	12867.35	2468.94	15356.29	Ave. 10¢ per acre.

The first named four cruisers were kept steadily engaged examining lands, while S. Lowney, Jr., and our own party had to spend considerable time patrolling lands and suppressing forest fires, locating and examining trespasses, also running over and reporting on the location and character of the Company's lumbering operations. I also spent considerable time with all these additional land lookers helping them to adapt and use good methods in obtaining approximate correct timber quantities, and also in making more detailed and correct topographical maps of the lands.

The bulk of the lands examined were in the Grand Marais District in Townships 47, 48, and 49 of Ranges 13 and 14, and roughly calculating, would equal about one hundred thousand acres.

Much of the lands in 49-13 is ancient burnings and plains and is not worth paying taxes on.

There is also considerable burning and waste land in Township 47 of Ranges 13 and 14, and the bulk of the timber in these two townships is light, scrubby, and small, much soft maple and also much 2 to 5" hardwood second growth and pine stumps. Surface all through is generally level and soil is light, sandy, and poor.

The timber on the $W\frac{1}{2}$ of Township 48 of Range 14 is mostly light, coarse hardwood mixed with 2 to 5" hardwood second growth and lots of pine stumps.

The timber on the $E\frac{1}{2}$ of this township is mostly hardwood also but is heavier and of better grade.

Townships 49-14 and 48-13 is heavily timbered with mostly tall, sound, good and first class hardwood, being mostly hard maple mixed with good and excellent birch, beech, and along the edge of the swamps and lakes with green and also considerable fire-killed hemlock. Much of this hemlock was killed by the fire which ran through here in 1908 and also by various subsequent fires, known as leaf fires. This burnt hemlock is now of very little value. The surface is generally gently rolling and level. Soil is generally light, sandy, and dry so that roads of any kind can be made almost anywhere. In its entirety, this is a group of mostly solid, compact hardwood timber lands of fair, good, and first quality. Surface generally level, gently rolling and dry, which makes the advantages for logging when development comes here very favorable. There is no new or old bad slashings to encourage forest fires and believe the bulk of this timber is fairly safe from them, all of which features make the tract attractive and valuable. The estimates made by the various cruisers of this timber in general is conservative and usually low.

Forest Fires

The main forest fires in 1925 adjacent to and on The Cleveland-Cliffs Iron Company's lands were located as follows:

Fire No. 1 - Started in May in the Company's own logging operations on the Vail Branch and ran over Sections 3, 4, 5, 9, and 10 in 44-19. It destroyed and injured considerable timber, especially on Section 9 and it also burnt and destroyed a considerable quantity of woods products which their jobber, Mr. Thayer, cut in the winter and had banked at the railroad.

Fire No. 2 - Started about May 20 along the D.S.S.&A. Railroad in 50-33 near L'Anse. It burned parts and in places continuous clean across 50-33 and also 50-32 and along the Henry Ford Railroad and into his logging operations in 50-32 and 51-31. This fire lasted two weeks or more. It burned over a large area, mostly old and new slashings and am pleased to say it did very little damage to The Cleveland-Cliffs Iron Company's timber holdings, of which they have in that vicinity and region an immense acreage. The weather at that time was very dry and no rain, and had S. Lowney, Jr., and his man into that region before this fire started to patrol everywhere, and to caution everybody in a gentlemanly, friendly, and unofficious way to be careful about fires. As soon as this fire was started, they got Mr. Crabisaw, the State Conservation Officer, to get unto these properties with a large force of men. They stayed there and helped put them out and kept them from getting into The Cleveland-Cliffs Iron Company's timber. After the heft of these fires had spent their force and most of them were out, they then with a few men gotten from the State, went around the edge of the fire adjacent to the Company's timber lands and put out all smouldering logs or roots, so as to block this fire from starting again in case the weather continued dry and the wind should change.

Fire No. 3 - Started on Sunday, May 31st, in the Company's own logging operations on the NE $\frac{1}{4}$ of Section 28 in 47-23 in the Fredeen District. From this point it burned in a northeasterly direction, burning over part of Sections 28, 27, 22, 23, 14, 13, and 12. Much of the timbered area on these Sections was slashed over, but the timber standing in the area over which this fire ran and also on the areas immediately adjoining was not then, and is not now, by any means cut anything like clean. The Company's loss here was very heavy, for in addition to destroying standing and down timber on the sections mentioned, it also destroyed the Company's Camp 6 and also burned all of the various kinds of woods products which were cut the winter before and banked at the railroad near this camp, which consisted of saw logs, railroad ties, pulpwood, etc. Almost immediately after this fire the Company practically abandoned logging operations here and moved them to the Rock River District in Township 46 North of Ranges 20 and 21 West.

Fire No. 4 - Started about August 24th in the Company's own logging operations near Dixon on Sections 6 and 1 in Township 45 of Ranges 20 and 21, where they had a lot of cordwood cut and piled. This fire destroyed considerable of this cordwood.

Fire No. 5 - Started on August 29th near Shingleton and Melstrand in Townships 46 and 47 of Range 17 West. This fire didn't do much damage until it got into 47-17 where the Charcoal Iron Company, the Jackson & Tindle Company, and various jobbers are operating and where The Cleveland-Cliffs Iron Company owns many sections of the heaviest stand and best grades of standing hardwood timber lands to be found anywhere. Got into this fire at its inception and with the aid and authority of the State Conservation Officers, got all the camp crews out and onto this fire and stamped it out without delay. The only material loss I know of sustained by the Company is about 80 M feet of mostly standing hemlock timber along the south line of Section 16 in 47-17. This damage or loss is insignificant when compared with the good this fire has done, by eliminating and burning these bad slashings which were near or up against such a vast acreage of excellent timber lands owned by the Company, and by good and systematic work done by those men who worked day and night until the fire was out and kept it from getting into or injuring very little of the standing green timber.

Fire No. 6 - Started in choppings made by the Wisconsin Land & Lumber Company on Section 1 in 44-22. With State Conservation Officers help and authority, got a lot of men from farms and Trenary and prevented it from doing much damage to the standing timber on the $E\frac{1}{2}$ of $SE\frac{1}{4}$ of Section 1 and the $N\frac{1}{2}$ of $NE\frac{1}{4}$ of Section 12, both in 44-22 and owned by The Cleveland-Cliffs Iron Company. On account of this timber standing alone and menaced by slashings and fire hazards on all sides, recommended its sale which you consummated shortly after and at an awfully good price.

Fire No. 7 - Started about September 1st on the road leading from Grand Marais to Seney near the northeast corner of Section 13 in 49-14 and burned south in spots along this road to the south line of Section 36-49-14. This fire was caused by Hill Brothers who had a lot of men here repairing about 5 miles of this road for the State. With State Officials authority, got a lot of men from Hill Brothers and also farms, and stamped this fire out without delay and with very little loss to The Cleveland-Cliffs Iron Company's timber of which they have on all sides in this vicinity immense acreages and heavy stands of excellent standing timber.

No expense of any kind was charged to The Cleveland-Cliffs Iron Company to fight or put out any of these fires which were not located in their own lumbering and operating places, as it was always arranged to have the State Conservation Officers commandeer all help required, and also arrange for tools and board, time, and pay, etc., for all men and equipment.

Trespasses

During the year, our own party located and reported on 49 cases of trespass scattered in various places all over the Company's holdings.

S. Lowney, Jr., located and reported five trespasses.

The additional land lookers located and reported on practically no trespasses for the reason that in the Grand Marais District where they were examining lands, not much of any kind of work was being carried on.

Special Reports on Lands

Shortage in saw log timber estimate, as compared with quantities cut by the Company's Lumbering Department and The Munising Paper Company. On December 18th, 1925, I ran through Section 7-45-19, now being operated by the Company's Lumbering Department on the "B" Branch, and noticed that they have made as already reported, principally a cordwood operation of the timber on this section. The superintendent didn't happen to be there and I was told by the wood choppers that the reason for cutting this timber into cordwood instead of saw logs was that they started cutting in December, 1924, and that the "B" Branch Spur extending from

near Coalwood to near this section was not relaid until about November, 1925, and for that reason they cut the timber into cordwood instead of saw logs as hardwood saw logs cut and left in rollways ten months or more would sap stain and depreciate. Seeing nothing but cordwood piles and no log rollways on the $W\frac{1}{2}$ of the section, ran through hundreds and thousands of piles of cordwood piled here and found birch and maple and particularly birch with diameters ranging from 1 to $2\frac{1}{2}$ feet in the round that were too large to split that would have made lumber of excellent quality if cut into logs instead of cordwood.

Yours respectfully,
Stephen Lowney.

Trespasses Committed On Company Lands During 1925.

January	- E. Jacobson	S $\frac{1}{2}$ of SW $\frac{1}{4}$, Sec.	12-46-23.
"	- E. Jacobson	NW $\frac{1}{4}$ of NE $\frac{1}{4}$, "	13-46-23.
"	- Nester Niemi	NW $\frac{1}{4}$ of NE $\frac{1}{4}$, "	2-45-22.
"	- Albert Gleisner	"	20-44-22.
February	- Maki & Pelto	SE $\frac{1}{4}$ of NW $\frac{1}{4}$, "	17-45-23.
"	- Melvin Larson	NE $\frac{1}{4}$ of NE $\frac{1}{4}$, "	13-45-24.
	P. Mallette	NW $\frac{1}{4}$ of NE $\frac{1}{4}$, "	8-46-24.
	Mary Lectanen - Fence on West Side of	W $\frac{1}{2}$ of SW $\frac{1}{4}$, "	5-46-23.
	Alex Saari	SE $\frac{1}{4}$ of	" 35-47-27.
March	- John Akkala - Fence and timber on	S $\frac{1}{2}$ of SE $\frac{1}{4}$, "	20-46-21.
	Alex Matsila	NE $\frac{1}{4}$ of NE $\frac{1}{4}$, "	2-45-22.
		SE $\frac{1}{4}$ of SW $\frac{1}{4}$, "	31-45-19.
		NW $\frac{1}{4}$ of SE $\frac{1}{4}$, "	24-45-26.
		SW $\frac{1}{4}$ of SE $\frac{1}{4}$, "	2-46-23.
April	- By The C.C.I.Co. or C.&N.W. R.R. Co.	E $\frac{1}{2}$ of SE $\frac{1}{4}$, "	17-47-23.
	Ed. Johnson	NE $\frac{1}{4}$ of NE $\frac{1}{4}$, "	34-47-10.
		NW $\frac{1}{4}$ of NW $\frac{1}{4}$, "	34-47-10.
May	- John Vesel	W $\frac{1}{2}$ of NE $\frac{1}{4}$, "	6-44-21.
	Frank Coaster	NE $\frac{1}{4}$ of SE $\frac{1}{4}$, "	36-45-20.
Mat	Matt Kivinan	E $\frac{1}{2}$ of SW $\frac{1}{4}$, "	22-46-21.
	Made by The C.C.I.Co. Lbr. Dept. on		
	East Jordon Co.	NE $\frac{1}{4}$ of NE $\frac{1}{4}$, "	8-46-21.
June	- Jake Mullenback	SW $\frac{1}{4}$ of SW $\frac{1}{4}$, "	8-45-22.
	Archie LaRoux	SW $\frac{1}{4}$ of NW $\frac{1}{4}$, "	22-46-14.
July	- Boomer	NW $\frac{1}{4}$ of SE $\frac{1}{4}$, "	29-49-14.
	Charles Propst	Sections 17 & 18	49-13.
	Alger County Road Commission	SE $\frac{1}{4}$ of SW $\frac{1}{4}$, Sec.	18-48-14.
	Newton Club	N $\frac{1}{2}$ of SW $\frac{1}{4}$, "	30-48-13.
August	- David Thomas	SW $\frac{1}{4}$ of NE $\frac{1}{4}$, "	18-49-13.
	John Harju	SW $\frac{1}{4}$ of SE $\frac{1}{4}$, "	18-49-13.
	Alger County Road Commission	NE $\frac{1}{4}$ of NE $\frac{1}{4}$, "	27-48-14.
September	- Northwestern Cooperage Co.	NE $\frac{1}{4}$ of SE $\frac{1}{4}$, "	16-45-22.
October	- Hill Brothers, McDonald & State	W $\frac{1}{2}$ of SE $\frac{1}{4}$, "	33-46-12.
	State of Michigan	SE $\frac{1}{4}$ of NE $\frac{1}{4}$, "	25-49-14.
	State of Michigan	"	36-49-14.
	Shepherd Parrish Co.	"	9-46-7.
	Wm. Hill	E $\frac{1}{2}$ of SE $\frac{1}{4}$, "	27-46-23.
	Big Bay Lumber Co.	S $\frac{1}{2}$ of N $\frac{1}{2}$, "	25-51-28.
November	- Wm. Walkonen	SE $\frac{1}{4}$ of NE $\frac{1}{4}$, "	29-46-22.
	Helena Land & Lumber Co.	SW $\frac{1}{4}$ of SW $\frac{1}{4}$, "	13-45-23.
	Helena Land & Lumber Co.	NE $\frac{1}{4}$ of SE $\frac{1}{4}$, "	14-45-23.
	Wisconsin Land & Lumber Co.	NE $\frac{1}{4}$ of SW $\frac{1}{4}$, "	13-45-22.
	Wisconsin Land & Lumber Co.	SW $\frac{1}{4}$ of SE $\frac{1}{4}$, "	16-45-22.
	Northwestern Cooperage Co.	SW $\frac{1}{4}$ of SW $\frac{1}{4}$, "	16-45-22.
December	- Jackson & Tindle	E $\frac{1}{2}$ of NE $\frac{1}{4}$, "	23-47-23.
	AuTrain Township	SW $\frac{1}{4}$ of SE $\frac{1}{4}$, "	22-47-20.
	Wisconsin Land & Lumber Co.	NW $\frac{1}{4}$ of SE $\frac{1}{4}$, "	1-45-22.
	Wisconsin Land & Lumber Co.	NE $\frac{1}{4}$ of NE $\frac{1}{4}$, "	2-45-22.
	Onen Pantti	SE $\frac{1}{4}$ of SW $\frac{1}{4}$, "	3-45-22.
	Ed. Heyrman	NW $\frac{1}{4}$ of NE $\frac{1}{4}$, "	4-45-22.

Mr. John M. Bush, Land Agent,

Building.

ENGINEERING REPORT

Dear Sir:-

I herewith hand you my report for the fiscal year ending December 31st, 1925.

SURVEYS:

Surveys were made of numerous lots and parcels of land in Negaunee, Ishpeming, Marquette and Munising, - lots were staked and descriptions made for various leases and deeds, - also the necessary surveying and descriptions were made for the sale of parcels of land at the old Gladstone Furnace. Lines were run, or checked, around the boundaries of the Underhill, Rock River, Vail #2, and Fredeen Log Jobs. On the Rock River Log Job twenty-eight iron corners were set, marking points where the original government marks were cut out. In the office it was necessary for the carrying on of our land work to make numerous maps and it required during the past year in this work, 850 yards of blue print paper, 100 yards of black print paper, 30 yards of blue print cloth, 24 yards of tracing cloth.

CONSTRUCTION:

It became necessary, owing to the ice taking out a portion of the Beach Inn Dock, to construct an extension on the side of the City Dock, low enough to enable our launch "Ottawa" to land and take on passengers. This dock, 10 feet wide by 100 feet long, was constructed during May and June at a cost of \$642.00, and a map of the City of Munising is attached showing the location of same.

LOG PURCHASES:

Our sawmill log requirements being short this year by some 2,000,000 feet of logs, it became necessary for us to endeavor to fill our requirements by purchase. The purchasing of logs was very difficult this year, owing to the few operators working and the keen competition between companies. Most of the operators preferred to sort their logs and sell as Veneer or Pin logs, getting a price f.o.b. cars of \$35.00 for Veneer and \$38.00 for Pin Logs. Our price of \$24.00 for Maple and \$28.00 for Birch woods-run, looked rather small to them and in most cases, where they were able to dispose of the smaller logs as Mining timber, they sold their product as Veneer or Pin logs. We were able to purchase to date 1,900,000 feet

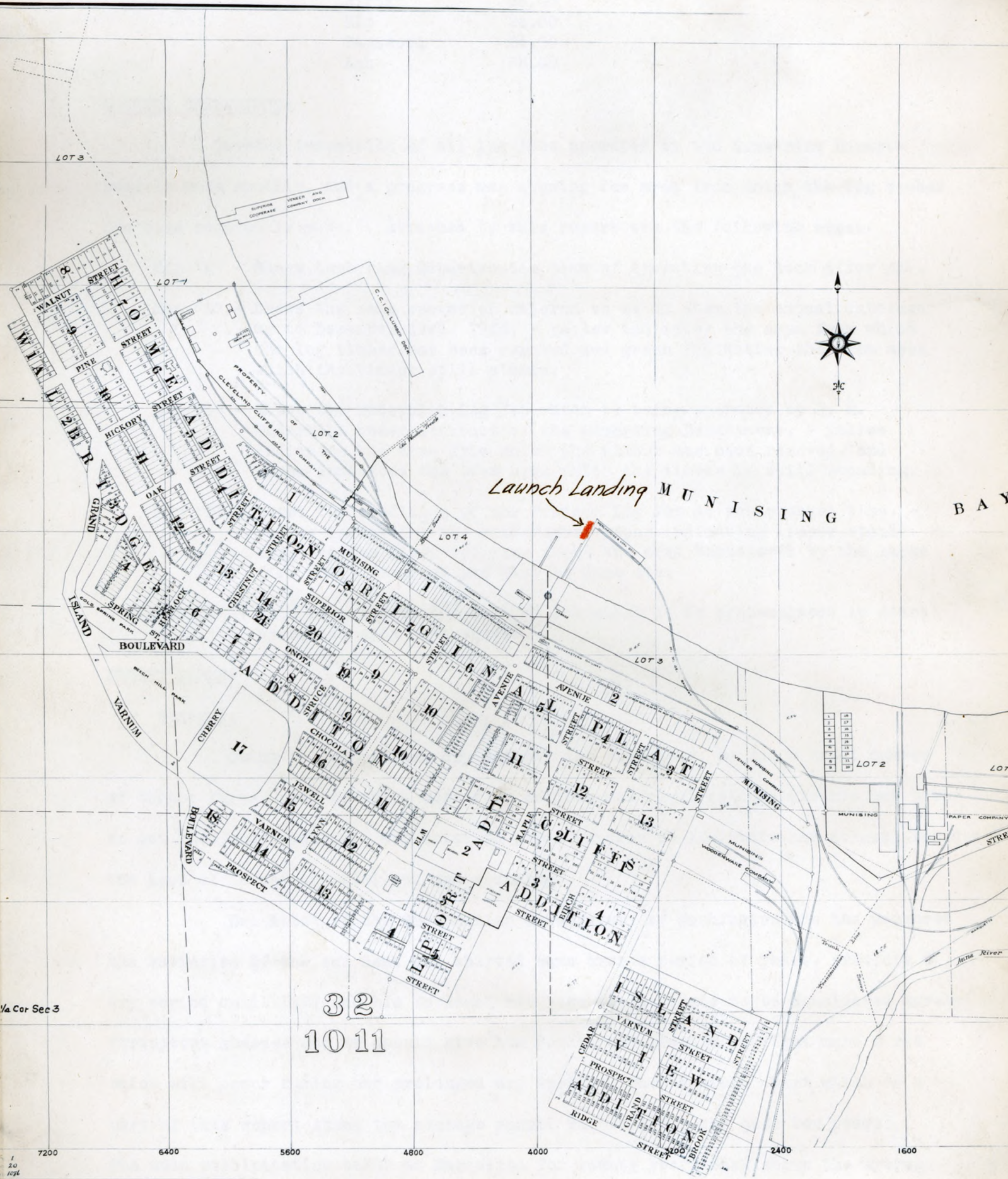

Launch Landing MUNISING BAY

1/4 Cor Sec 3

32
10 11

7200 6400 5600 4800 4000 2400 1600

CITY OF MUNISING
 Red indicates new Launch Landing
 Constructed for Str. Ottawa

at the following prices, f.o.b. cars L. S. & I. Railway:

Maple	\$24.00
Birch	28.00
Elm	24.00
Basswood	24.00
Ash	22.00

LOGGING OPERATIONS:

Careful inspection of all log jobs operated by the Lumbering Department is made monthly, and a progress map showing the area from which the log timber has been removed is made. Attached to this report are the following maps:

Map "A" - Shows Lumbering Department's plan of operating the Rock River Job.

Map "B" - Shows the same operation colored so as to show the actual cuttings up to December 31st, 1925, - yellow indicates the area from which the log timber has been removed and green indicating the area upon which the timber still stands.

Map "C" - Shows the Underhill Log Job which is being operated by H. M. Underhill under contract to the Lumbering Department, - yellow indicates the area from which the timber has been removed, and green indicates the area upon which the timber is still standing.

Map "D" - Shows the condition of the Fredeen Log Job at the present time, - yellow indicating the timber cut, green indicating timber standing, and the heavy red line shows the area burnt over by the large fire which occurred May 31st to June 4th.

Map "E" - This is a map of the Vail #2 Job which it is contemplated to start operation upon next summer.

FOREST FIRES:

General:

Owing to the extreme dry weather the past year, we had a great number of forest fires, many of which were very serious and required considerable man power to get them under control, and entailed great expense to the state and others, besides the loss of forest material cut and standing.

Dr. Abbot of the Smithsonian Observatory of Washington who has measured the variation of the sun heat and charted same over a period of years, predicts a dry period until 1927 and his forecast has been too accurate to be considered merely fortuitous guesses and we should give him credit and prepare to fight more fires which will occur during our prolonged dry spell. The rainfall chart which is a part of this report shows the average annual rainfall for the past ten years. The mean precipitation taken at Marquette for twenty years back shows the average annual amount to be 32.37 inches, 12.85 inches of this falls from November to May

ROCK RIVER OPERATION

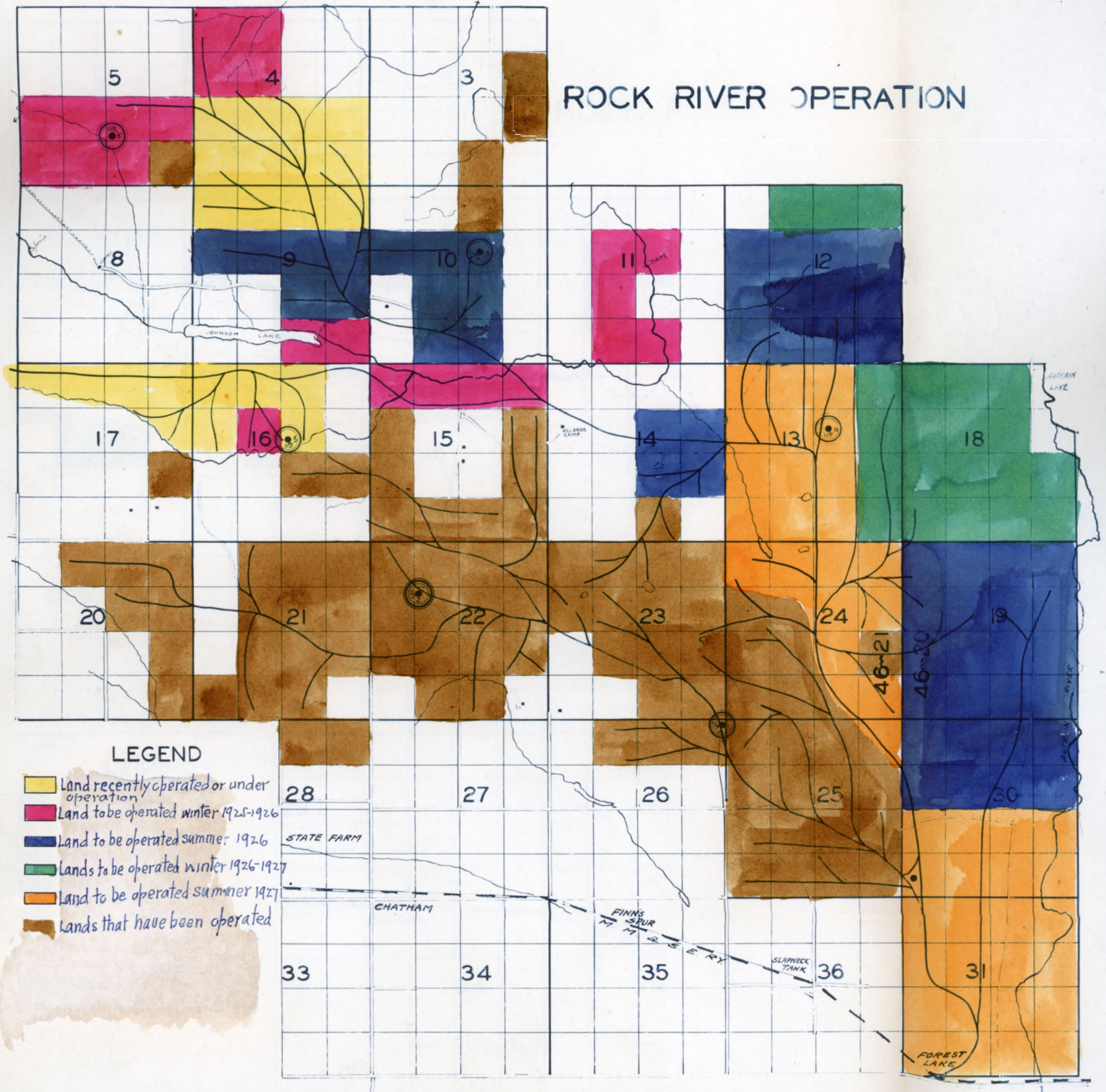

LEGEND

- Land recently operated or under operation
- Land to be operated winter 1925-1926
- Land to be operated summer 1926
- Lands to be operated winter 1926-1927
- Land to be operated summer 1927
- Lands that have been operated

ROCK RIVER OPERATION

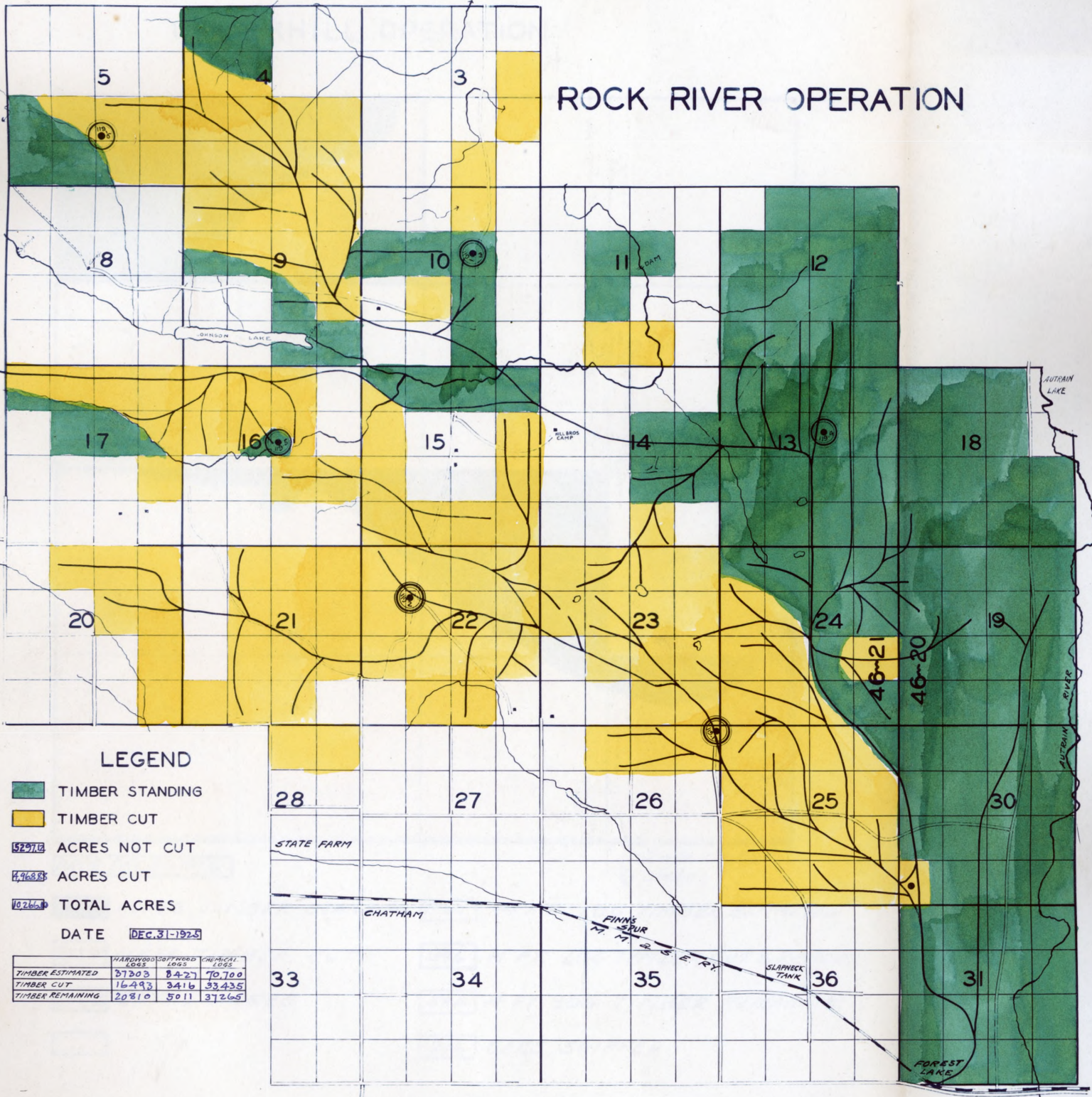

LEGEND

- TIMBER STANDING
- TIMBER CUT
- 52970 ACRES NOT CUT
- 47683 ACRES CUT
- 102664 TOTAL ACRES
- DATE DEC. 31-1925

	HARDWOOD LOGS	SOFTWOOD LOGS	NET PICAL LOGS
TIMBER ESTIMATED	27503	8427	70700
TIMBER CUT	16493	3416	33435
TIMBER REMAINING	20810	5011	37265

"B"

SECTION 4-47-17

UNDERHILL OPERATION

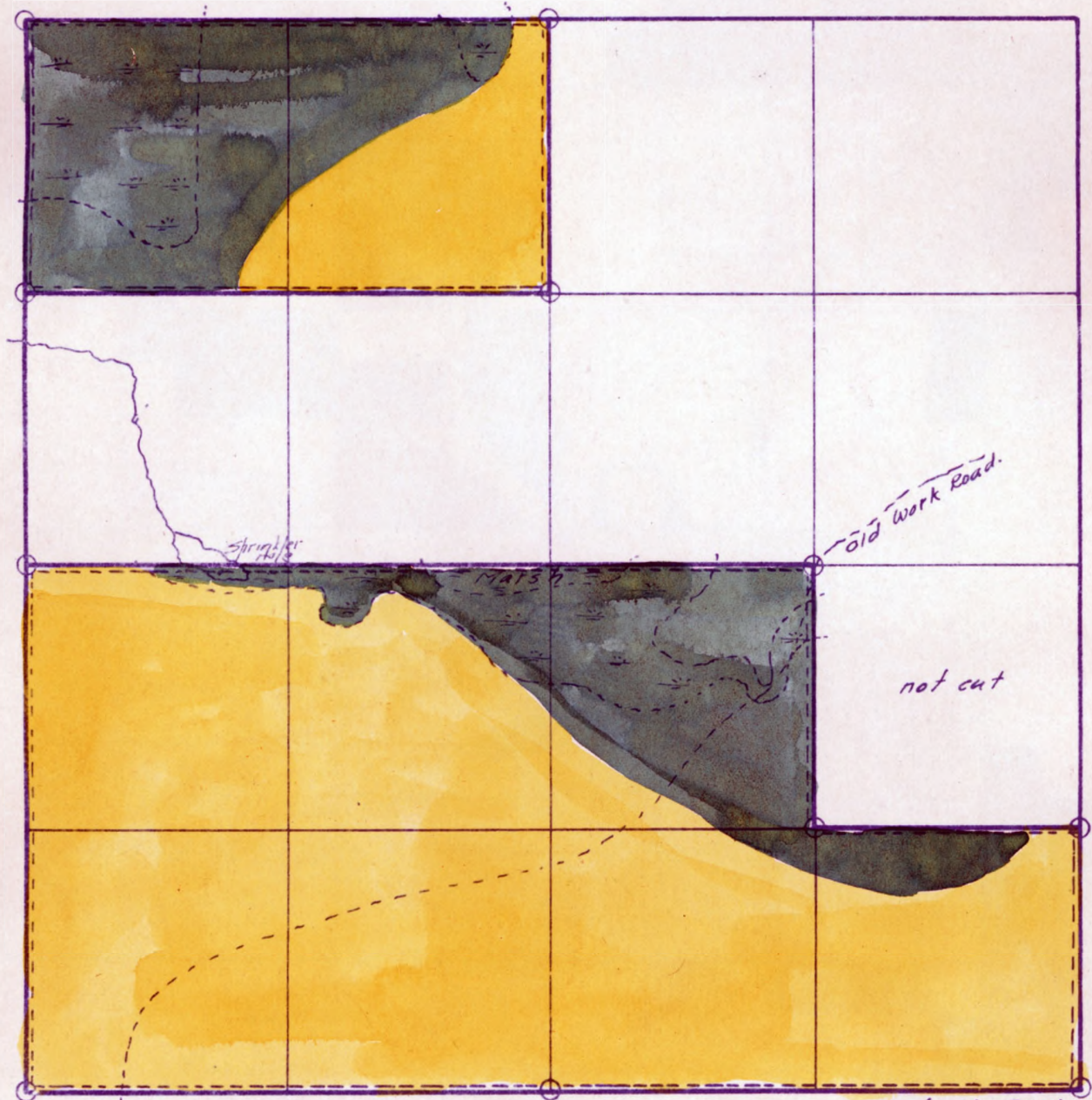

DATE DEC 31-1925

Scale 1" = 800'
 O Stake

105.85	ACRES TIMBER STANDING	1980	M FT. LOG TIMBER ESTIMATED
253.00	ACRES TIMBER CUT	1396	M FT. LOG TIMBER CUT & REMOVED
358.85	TOTAL ACRES	584	M FT LOG TIMBER REMAINING
		206	CARS SHIPPED

"C"

LOGGING OPERATIONS.

Green indicates timber standing
 Yellow indicates timber cut
 Red line indicates the boundaries of the
 large fire which occurred May 31 to June
 4.

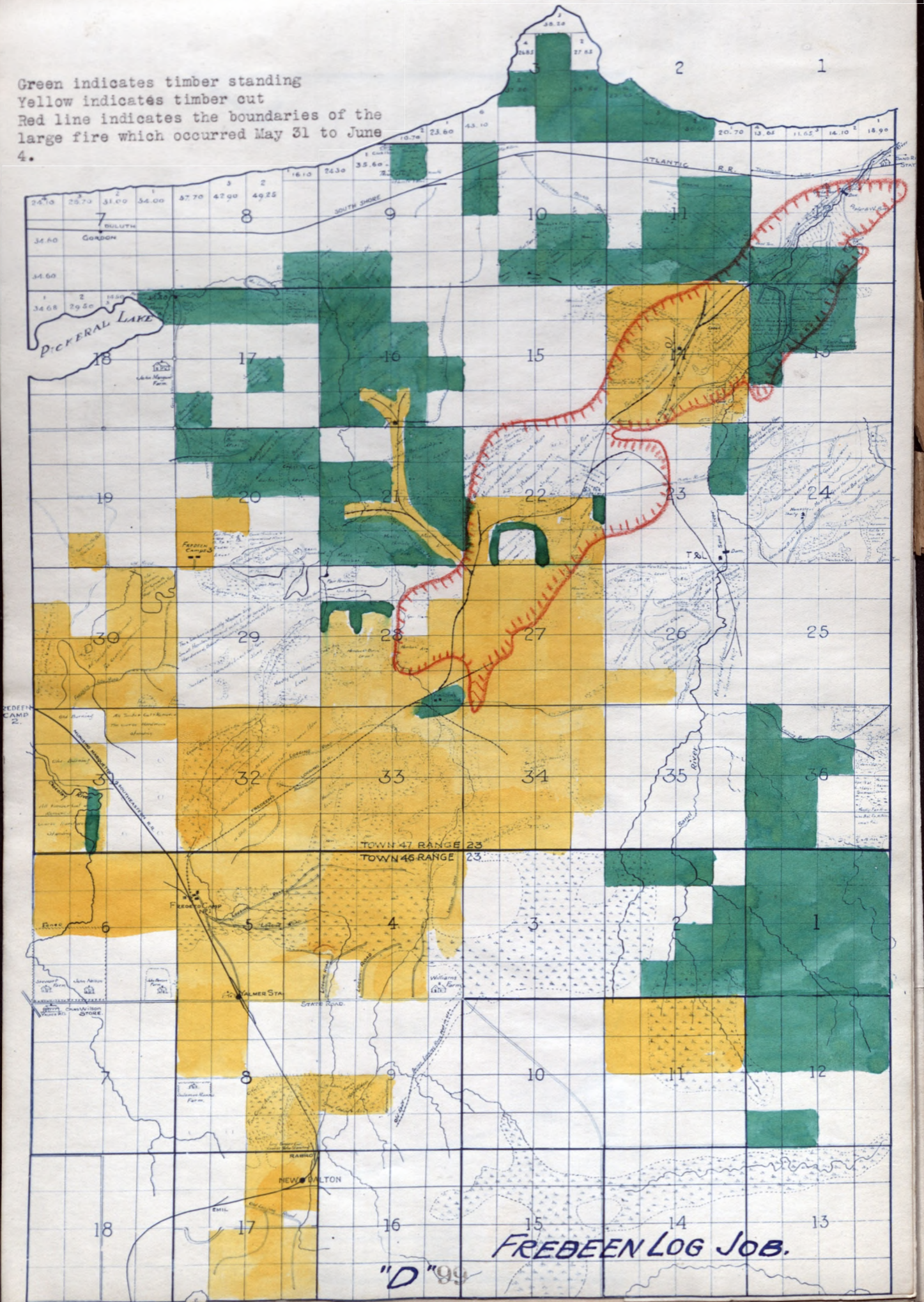

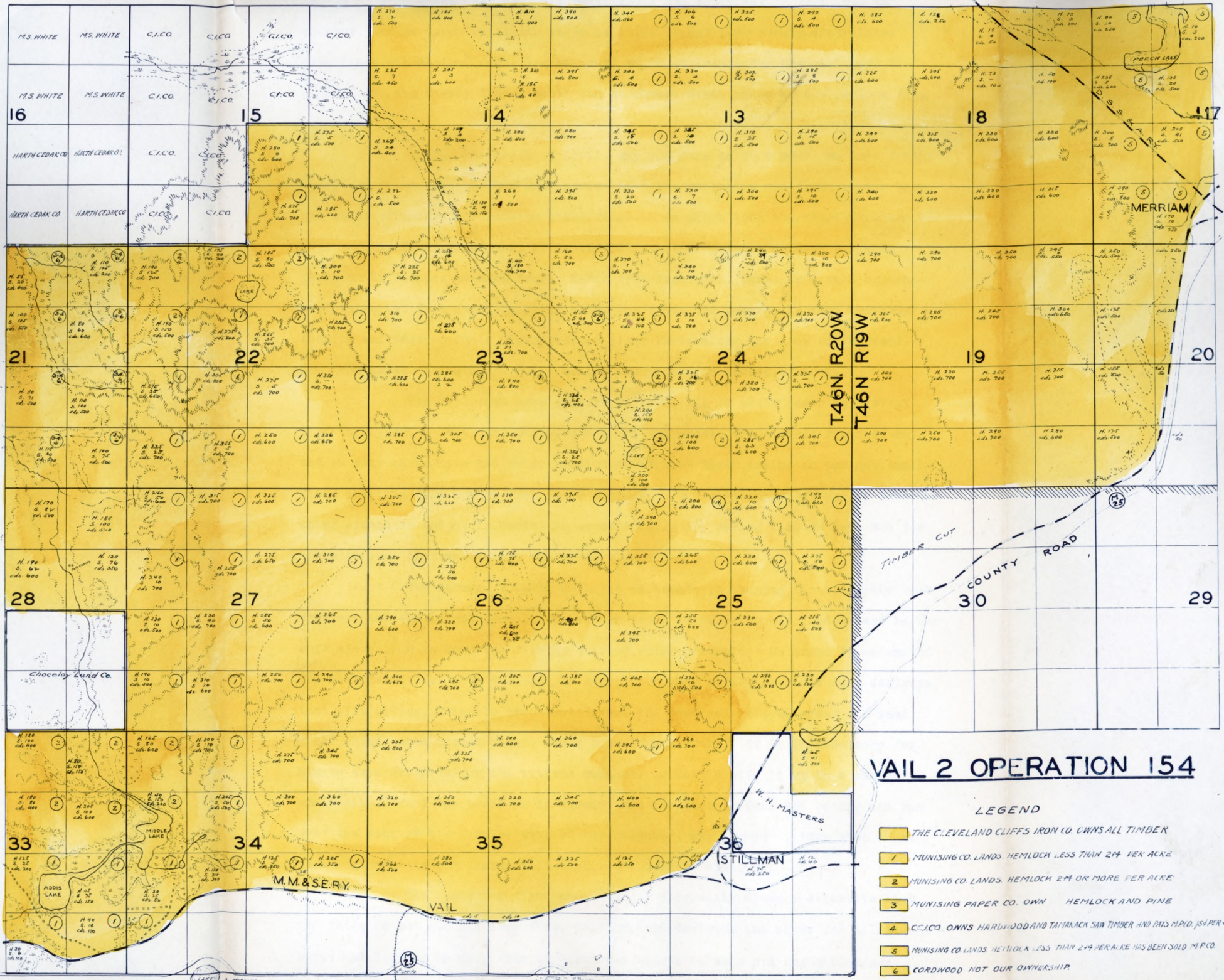

VAIL 2 OPERATION 154

LEGEND

- THE CLEVELAND CLIFFS IRON CO. OWNS ALL TIMBER
- MUNISING CO. LANDS. HEMLOCK LESS THAN 24" PER ACRE
- MUNISING CO. LANDS. HEMLOCK 24" OR MORE PER ACRE
- MUNISING PAPER CO. OWN HEMLOCK AND PINE
- C.C. CO. OWNS HARDWOOD AND TAMARACK SAW TIMBER AND PMS P.P.O. 154 PER A
- MUNISING CO. LANDS. HEMLOCK LESS THAN 24" PER ACRE HAS BEEN SOLD M.P.C.O.
- CORDWOOD NOT OUR OWNERSHIP

mostly as snow which does not melt until April and early May. From June to October, the average for twenty years is 19.52 inches very evenly distributed over these six months. The low rainfall of 19.48 inches for the past year together with the steady drying south and southwest winds makes a very serious fire hazard.

During the month of April, May and June of this year, we have fought forty-two fires, and we found last spring that the railroads and farmers have been the chief offenders for causing these fires. As shown upon the chart attached to this report, fourteen of them were started from sparks from railroad engines, fourteen by farmers burning brush, three from fishermen, three from road contractors, three set from cars traveling along the roads and persons in them probably smoking and tossing their cigarettes or cigar butts along the side of the road, one from ashes of a diamond drill boiler and four from causes unknown.

The railroads have endeavored to do all in their power to prevent fire this year. They have burned the grass and growth along their right-of-way, and in many cases have had their section men follow their trains to put out small fires starting from sparks from their engines. But still they are one of the chief offenders and it is during an exceptionally dry period like we have had for the past year that makes them the worst offenders.

The farmer, equally with the railroads in causing fires, is the most careless and should not be allowed to burn brush in clearing his land unless he has sufficient help to keep the fire he started under control. He ought to be one of our most relentless fire wardens, as every fire that passes over his land destroys that life giving, valuable crop fertilizer, the dead and decayed grass and leaf mould which, when turned under, makes his crops larger. If it is necessary for him to burn brush during the extreme weather, he should pile it up in a number of small piles, feed the brush to it slowly, and see that it does not escape and run over the rest of his farm or that of his neighbor, and never burn when there is a high wind as the sparks will carry considerable distance.

The hunter or fisherman, when he carelessly drops a cigarette stub or fails to put out his camp fire, deliberately destroys the cover for all game birds and leaving an ugly scar of blackened stumps to show his thoughtlessness,



CHART SHOWING HOW 42 FOREST FIRES STARTED DURING MAY & JUNE 1925

OUR GASOLINE PUMPS WERE USED WITH EXCELLENT RESULTS ON ALL OF THESE FIRES EXCEPT TWO.

14 CAUSED BY SPARKS FROM RAILWAY ENGINES

14 CAUSED FROM FARMERS BURNING BRUSH

4 CAUSE UNKNOWN

3 FROM FISHERMEN SMOKING

3 FROM AUTOS ON HIGHWAY PERSONS SMOKING & THROWING BUTTS AWAY

3 FROM ROAD CONTRACTORS CLEARING LAND FOR RIGHTWAY

1 FROM ASHES DRILL BOUL

R.A.B.

AVERAGE RAINFALL

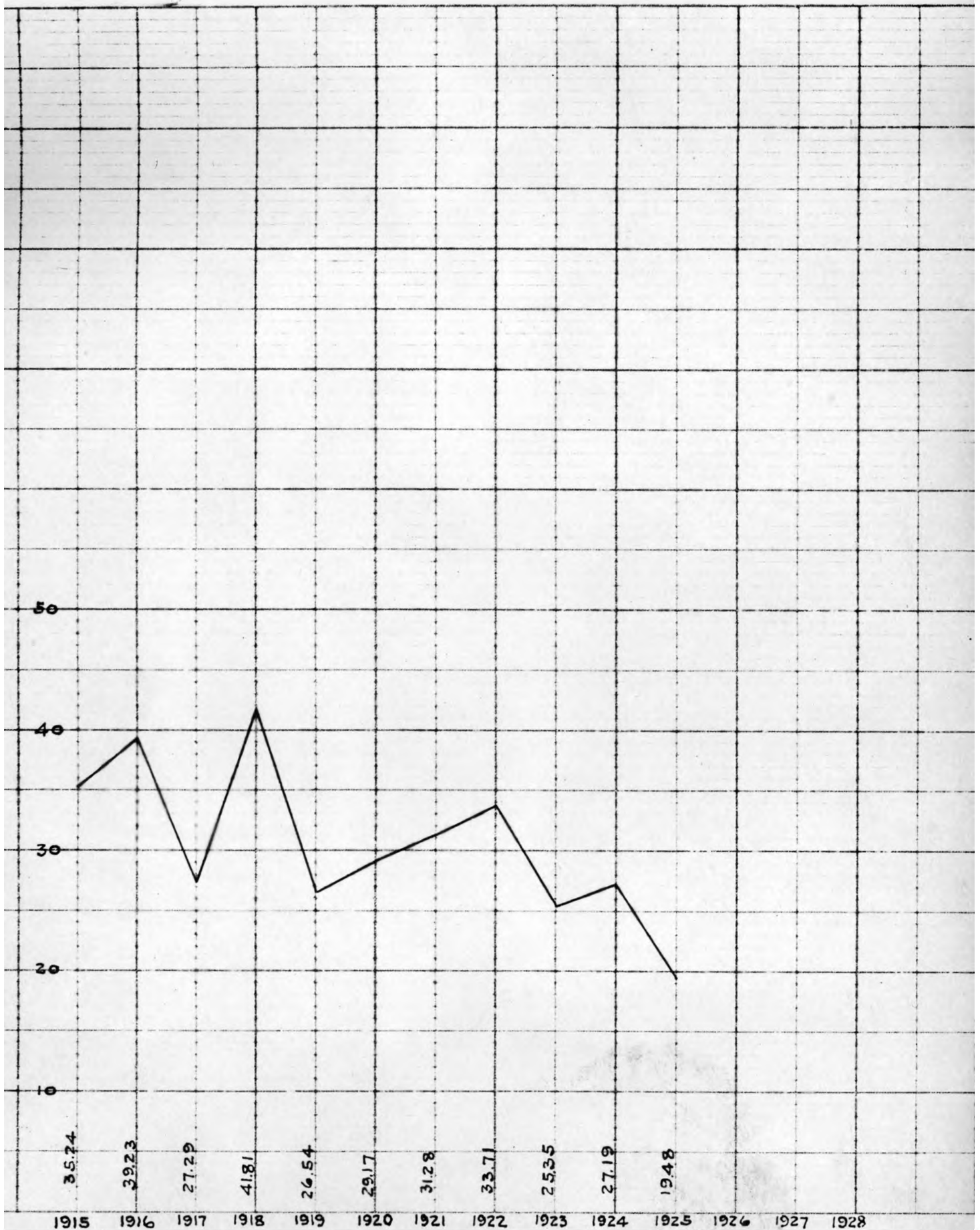

but thanks, however, to the splendid publicity that is being carried on in regard to carelessness in setting forest fires, we are able to state that the fires started from fishermen are few in number. The past year has been very disastrous in regard to forest fires, not only in Michigan, but Wisconsin is having serious trouble also. The prolonged drought of last Fall and the exceptionally dry March, April and May, which, together with the high south winds, has made fire hazards very difficult to control.

Fire Fighting Equipment:

We have now the following equipment for fighting forest fires and which is ready to go to a fire at a moment's notice;

3 Evinrude Pumps, complete with hose & gas masks	\$986.00
1 Ford Truck	400.00
500 feet hose	170.00
2 Tank Cars	<u>650.00</u>
TOTAL COST	\$2,206.00

The first pump was purchased in August 1923, - in 1924 we added 500 feet of hose, and this year we purchased two more pumps and hose, also a Ford Truck to convey the equipment to and from fires. We also equipped this year two old ore cars with old boilers from the Negaunee Mine. It was the intention when we purchased two pumps this year to leave one on Grand Island, but owing to the numerous fires this spring, it was necessary to use this pump on the main land. For next year we recommend the purchase of 1,000 ft. of 1½ inch hose at a cost of \$340.00, and 50 ft. of 2 inch suction hose in 10 ft. lengths at a cost of \$64.00. Below we show photographs of the outfit packed in the truck ready to go to the fire and also the pump in operation:





Fredeen District Fire:

This was the most disastrous crown fire which occurred this year. It started on May 31st and we were unable to extinguish it until June 4th. It started on Section 28, 47-23, running northeasterly through Sections 11, 12, 13, 14, 15, 22, 23, 26, 27, and burning over approximately 3,000 acres, causing a loss of manufactured woods products as follows:

Softwood Logs	1,089,639 ft.	\$14,718.06
Hardwood Logs	9,345 "	143.23
Ties	9,589 pcs.	3,896.58
T. & S. Cuts	878 "	260.47
Posts	2,256 "	377.07
Pulpwood	19,524 "	2,628.94
5' Lagging	21,569 "	115.26
Cedar Poles	392 "	823.98
Mine Stulls	583 "	320.65
Railroad, Steel, etc.		<u>2,816.44</u>
		\$26,100.68

Our method of combating this fire was having large forces of men stationed at various points along swamp areas and green timber with shovels, while along the spurs we used locomotives pulling three tank cars upon which we mounted our fire pumps. These tank cars contained 10,000 gallons of water and took about four hours steady pumping to empty each. We patrolled up and down our various spurs in this area, putting out all burning within reach. We found these tank cars very valuable equipment for fire fighting along spurs where we have considerable forest products with little water available. Two of the tank cars that we used on this fire we borrowed from the Furnace Department. One, however, we rented at a monthly cost of \$35.00, making a total of \$85.71 expended during the time we kept this tank car in service. We also placed one pump on the tender of the locomotive pumping

directly from the tank which gave us about 4,000 gallons of water before it was necessary for the engine to go to the main line to refill. Pumping directly from the tank of the engine makes a very efficient way of putting out small fires along the railroad right-of-way.

Vail District Fire:

This fire started on May 15th and was extinguished on May 18th, burning over Sections 1, 2, 3, 10, 11, 12, 14, 15-44-19, and Sections 22, 23, 26, 27, 34 & 35, -45-19, covering an area of about 15 square miles, causing a loss of manufactured woods products as follows:

Chemical Logs	8,200 ft.	\$ 96.80
Softwood Logs	113,733 "	1,268.46
Mine Stulls	118,000 "	1,316.05
Cedar Poles	356 pcs.	485.94
T. & S. Cuts	1,081 "	242.14
Pulpwood	926 "	125.00
Cedar Posts	4,167 "	456.29
Hemlock Bark	10 cds.	87.27
Ties	288 pcs.	110.59
Logging Sleighs	3	31.29
		<u>\$4,219.83</u>

Our method of combating this fire was to have a large force of men stationed at various points endeavoring to check the ground fire with shovels, while at creeks and lakes we placed our pumps, endeavoring to check the fire with water. There is no doubt in my mind that if we did not have these pumps, the camps at "A", Doe Lake Club buildings, and Whitimire buildings at Twin Lakes would have burned. The manufactured woods products at Camp "H" were already burnt before we arrived at the fire and we made our first stand at the Doe Lake Club, as we were unable to go further south through the fire at this time.

Other Large Fires:

The only other large crown fire that we fought occurred on June 8th, and burnt over Sections 14, 23, 46-21, causing a loss of chemical logs, 9,524 ft. - \$33.78, cordwood 100 cds., \$263.80, - total \$297.58.

Minor Fires:

During the months of April, May and June, we kept a continuous patrol of the districts where our large holdings were, putting out numerous small fires of one acre and larger in extent. These fires, most of which occurring in old slashings

or on the Pine Plains, resulted in practically no loss of merchantable timber; the only loss being that to the small growing trees and natural re-forestation.

Fighting Fires:

It is impossible to suggest any set rules for fighting forest fires as no two fires are alike. Timber conditions are different, topography of the land is different, and the velocity of the wind is different. The one thing that must be emphasized is to have a sufficient number of men patrolling on our lands during the dangerous dry period to enable them to catch the fires before they become too large and out of control. This, to my notion, is the only time to catch a fire and be sure that you can put it out. The best way to prevent fires is first to see that none are started and this can only be done by having men patrolling in the near vicinity where we consider our most dangerous risks are. Our small pumps have proved themselves to be one of our most valuable piece of fire fighting equipment and I think the State has begun to recognize them also, as they borrowed one of our complete units to place on a car which is being put out from Lansing, travelling through lower and upper Michigan to show methods of fire prevention and educate the people that the careless setting of fires must stop.

Hurricane:

A very strong wind, which was practically a hurricane, occurred on July 15th, and did considerable damage to the standing timber on the north end of Grand Island; also caused considerable windfall in the vicinity of Pickerel Lake, northwest of Marquette. On Grand Island the Beech suffered the most, owing to its being light rooted with bushy tops. Most of the Birch, Maple, Hemlock and Balsam that were blown down, were defective trees. The tops of many of these trees were blown off, leaving the trunks standing. Also there were a number of trees partially blown over and will come down later. The low land and swamp area were not touched. The area where the trees were blown down is rough and hilly in places and owing to the scattered and small number of windfall trees per acre, it will be too expensive to recover this timber as it means a haul of 8 to 10 miles to get the wood to Williams Landing. The

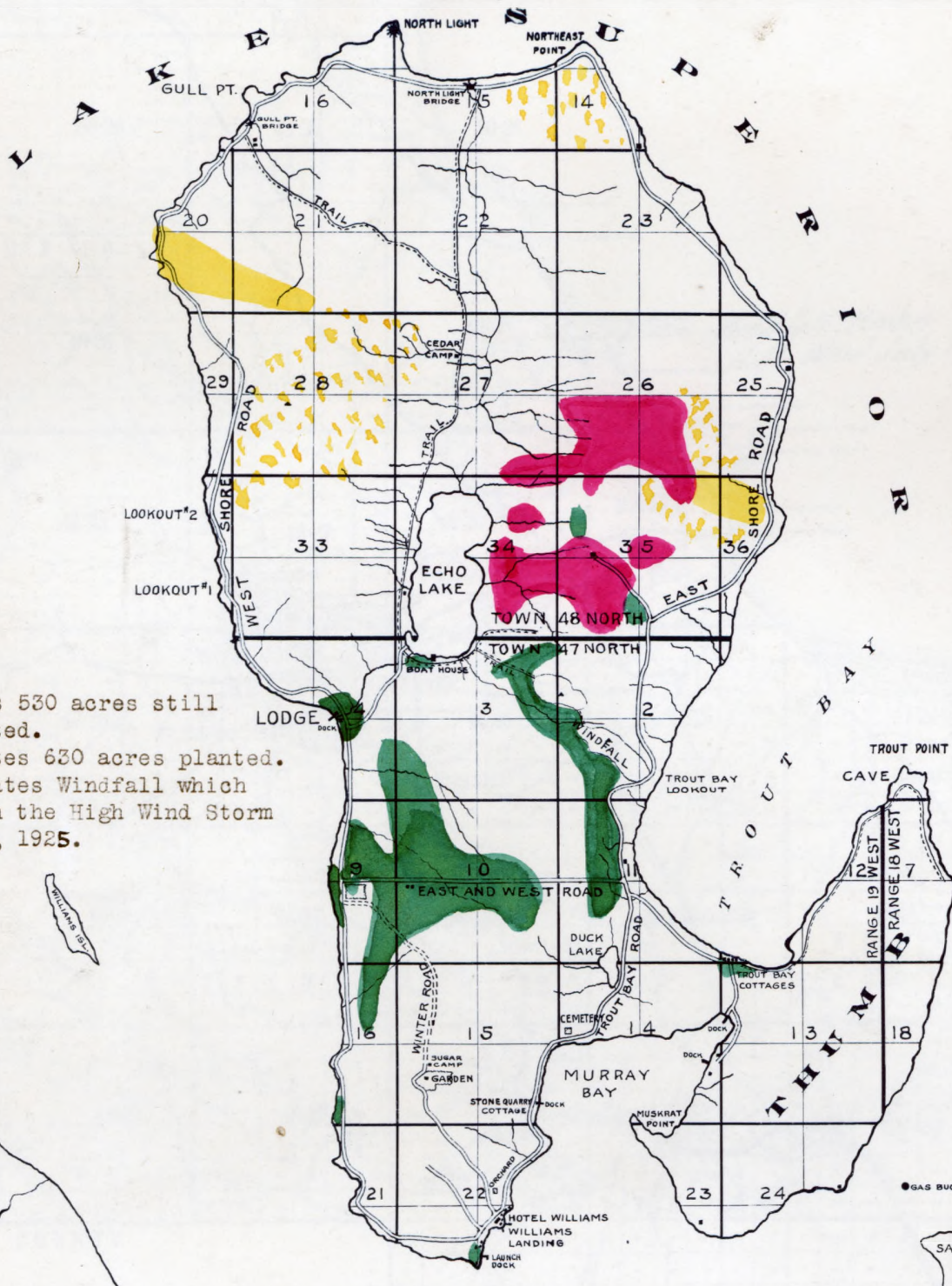

Red indicates 530 acres still to be planted.
 Green indicates 630 acres planted.
 Yellow indicates Windfall which occurred in the High Wind Storm of July 15, 1925.

MAP OF GRAND ISLAND MUNISING MICH.

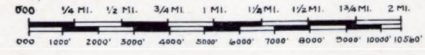

MUNISING
109

50 MI. TO MARQUETTE TO WETMORE 4 MI.

12 MI. TO AUTRAIN

TO GRAND MARAIS 51 MI.





Windfall Timber
High Wind July 15-1925

49-26

O W E L L
51-29 51-28 51-27 51-26
50-29 50-28 50-27 50-26
C H A M P I O N
49-29 49-28 49-27 49-26 49-25
M E I S H E P M I N G M A R Q U E T T E
48-29 48-28 48-27 48-26 48-25
S H E P M I N G M A R Q U E T T E
47-29 47-28 47-27 47-26 47-25 47-24 47-23
H U M B O L D T N E G A M S E E
46-29 46-28 46-27 46-26 46-25 46-24 46-23
E L Y R I C H M O N D S A N D S C H O C O M A
45-29 45-28 45-27 45-26 45-25 45-24 45-23
T I L D E N D R A N C H W E S T S K A N D I A
44-29 44-28 44-27 44-26 44-25 44-24 44-23
D I C K I N S O N C O U N T Y F O R S Y T H
43-29 43-28 43-27 43-26 43-25 43-24 43-23
T E L F E R
42-29 42-28 42-27 42-26 42-25 42-24 42-23
D I C K I N S O N C O U N T Y W H E E L I N G
41-29 41-28 41-27 41-26 41-25 41-24 41-23
W E L L S
40-29 40-28 40-27 40-26 40-25 40-24 40-23
M E N O M I N E E C O U N T Y D E L T A C O U N T Y
39-29 39-28 39-27 39-26 39-25 39-24 39-23

estimate of the down timber is as follows:

Beech	250 M
Hemlock	20 "
Maple	30 "
Balsam	10 "
Birch	10 "
Elm & Basswood	3 "
Total	<u>323 M</u>

On the area northwest of Marquette, most of the trees blown down were defective and matured Hemlock, and it did not pay to attempt to recover these trees as they were very scattered and would not run over 50 or 60 M feet. We attach two maps showing the different areas the wind affected and colored in Red where trees were blown down.

REFORESTRY

Following is a complete summary of all of the reforestation done by the Company with the results to date:

BALDWIN KILN PINE FARM:

This planting is located on the NW $\frac{1}{4}$ of NW $\frac{1}{4}$ of Section 28-48-26 and three and one-half miles northeast from Negaunee. Practically thirty-five acres of this description was planted in the spring of 1903. The species planted being as follows: Scotch Pine, 5,000 - three years old, about 90% now living, Scotch Pine, 1,000 - six years old, 91% living, White Pine, 12,000 - three years old, 65% living, Norway Spruce, 20,000 - three years old, 90% living, Norway Pine, 1,000 - three years old, 80% living. The soil upon which these trees were planted is a sandy loam and slightly rolling and formerly a thick matted crop of grass covered the land. No preparation was given except to plough furrows, in which the young seedlings were planted, 1200 to the acre. The average growth in height is about as follows: Norway Pine - one foot, Scotch Pine - eight inches, White Pine - six inches and Norway Spruce - four inches. Scotch and Norway Spruce have the highest percentage of trees living although 80% of the Norway and 65% of the White Pine still form an excellent plant of trees. In the matter of growth, Norway Pine is distinctly the leader. The average height of which was almost 22 feet and the average diameter being five inches, with an annual height growth of one foot. The volume per acre in

cubic feet including the whole stem of the tree from ground to tip irrespective of their present merchantability was 2,190 cubic feet. In all these respects, the Norway Pine clearly surpasses the other species. Scotch Pine is second in the matter of growth followed by White Pine and Norway Spruce. The total volume in cubic feet per acre is about 3,973. Each year, we have kept careful supervision over this planted area and it has been our practice to plough several furrows around same just outside of the fence to protect the trees from ground fires. On the south side there is a small creek and in the SW $\frac{1}{4}$ of Section 21, we have dug a hole in the low ground that has filled with water which makes it possible to reach all parts of this planting with our fire hose. On the west and north sides are township roads making it possible to reach the Pine Farm in ten minutes from Negaunee. The total original cost of planting these trees was \$1,164.47. It also requires an annual upkeep of about \$25.00 for supervision and repairing fences, etc. Total taxes to date is \$161.42 which makes a total cost per acre with interest on the investment of 6%, amounting to \$108.80.

COALWOOD PLANTATION:

This planting is located on the N $\frac{1}{2}$ of the NE $\frac{1}{4}$, Section 31-46-19, about nine miles from Munising by road. The Cherry Farm is located on the NW $\frac{1}{4}$ of NE $\frac{1}{4}$, Section 29, and the old Nursery in the SE $\frac{1}{4}$ of SE $\frac{1}{4}$ of Section 29. The area of the Pine Farm is fifty acres, Cherry Farm, ten acres and Nursery, five acres. In the late spring of 1906, 2000 White Pine, two and four years old, were planted. Practically no supervision has been given these plants since the planting to the present day but all seem to be doing well except where the cover was too thick which made a very slow growth; also in the spring of 1906, 500 Cottonwood cuttings, 12 to 18 inches long, taken from healthy native trees were planted. A dry spell occurred immediately after the planting and although a few sprouted the following spring, practically the entire planting was lost. In the spring of 1907 an acre of White Pine was planted using 1,200, - two to four years old. This planting was done in old cordwood cuttings and about the only preparation done was the burning of the brush to decrease the fire risk and

lay bare the mineral soil. All these trees are doing well and practically 80% are still living. In the spring of 1908, 1,000 Carolina Poplar, 500 Black Locust, 500 Norway Spruce, 500 Scotch Pine, 500 Norway Pine, were planted. The Carolina Poplar were practically a total failure, owing to the poor quality of the purchased stock. The Black Locust did very well as far as the growth was considered but was set back each spring by frost. The Norway Spruce resulted in good growth and endurance but the Scotch Pine did very poorly, nearly all dying, due doubtless to the dry spell and hasty planting of large plants. The Norway Pine did very well and is considered the best specie to plant in this district. In the year 1909, fifty acres were planted in the NE $\frac{1}{4}$ of Section 31-46-19; 20,000 White Pine, three years old and 20,000 Norway Pine, three years old. About 75% of these trees are alive at the present time and have attained an excellent growth. The cost of this planting was \$827.49. In the spring of 1911 on this same site were planted 8,000 Scotch Pine, three years old, 8,000 White Pine, three years old and 2,000 White Pine, seven years old. These trees have all attained an excellent growth and should say that about 40% of the Scotch Pine are still alive, while the other species show about 80% living. On making our annual inspection trip this year, it was found that about 10% of the Scotch Pine were destroyed by porcupines. These animals completely barked the trees and seemed to find the bark of the Scotch Pine very palatable as they did not touch the White or Norway Pine. In September 1911, there was planted on the SW $\frac{1}{4}$ of the NE $\frac{1}{4}$ of SE $\frac{1}{4}$ of Section 29, 3,500 Yellow Pine - four years old, 4,000 White Pine - three years old, 4,000 White Pine, - five years old and 1,200 White Pine - seven years old. All these were planted 2,500 trees to the acre and practically 80% are living today and the result is very satisfactory except that they were planted too close together and as they have attained considerable growth at the present time, the weaker trees are bound to be killed off.

The Cherry Farm was planted in the spring of 1905 on an area of ten acres, the cost being at that time \$518.67. Fire has run over this land several times and damaged the trees and little value is left at the present time.

PLANTING AT FISH HATCHERY:

At the old Fish Hatchery located on the SW $\frac{1}{4}$ of NW $\frac{1}{4}$ of Section 14-46-19, about twenty acres of burned-over area was planted in the spring of 1905. 18,000 Norway Spruce - three years old transplants were planted with practically no preparation being given to the site. The Cherry, Balsam and Ferns were under-planted. A fire lane, however, eight feet wide was ploughed around this entire site of twenty acres. All of these trees are doing well at the present time with the exception of some being damaged in the winter by the deer eating off many of the terminal shorts. The cost at the time this planting was done was \$454.30. In the spring of 1918 about 10,000 Norway Spruce - two year old transplants were planted on the Munising Hill Site. The soil where this planting was done was mostly cut-over burnt Hemlock land, full of ravines on a steep hillside with mostly good, rich, loamy soil. Practically nothing was done in preparing this site and we should say that about 60% of the original planting are living at the present time. 50% though, of these trees, have been attacked by insects and has doubtless affected the growth of the trees but it is not likely to result in killing them.

PLANTING ON GRAND ISLAND:

The old plantings on Grand Island were started in the spring of 1907 when the Pine Plains back from the shore of Trout Bay were planted. The area of the planting was about three acres and the trees were put in 1,000 to the acre. Species being: Norway Pine, 1,000 - four years old, Spruce Pine, 1,000 - four years old, White Pine, 1,000 - four years old and White Pine, 150 - seven years old. This soil is very sandy covered with a heavy layer of caribou moss and practically no preparation was given to it. The results at the present time, - about 40% are alive. On the west road in the spring of 1905 and 1906, about 1,000 - four years old, Scotch Pine were planted to afford a protection to the road during the heavy snows in the winter. Nothing has been done since to aid these plants but the result has been very satisfactory. Practically 95% are now alive. Also along the west road in the spring of 1907, 200 White Pine, - four years old and 250 White Pine, - seven years old, were planted with about the same result - 95% are now living. At William's Landing in the spring of

1905, 4,000 Scotch Pine were planted near the boathouse and although this soil is very poor, these trees have attained excellent growth and shows the ability of Scotch Pine to thrive on extremely sandy soil. The Scotch Pine, however, has a strong tendency to become crooked and hold its limbs so it is not at all promising as a tree for lumber production. At the south end of Echo Lake in 1907, were planted 2,000 White Pine - four years old, 2,000 Scotch Pine - four years old, and the result being that all the plants that were set on the knolls around old cedar stumps are doing well but those that were planted in the low wet ground practically all died. At the fishing ground this same year, practically an acre was planted with 500 White Spruce - four years old, 500 Norway Spruce - four years old and 450 White Pine - seven years old, and although this is a light sandy soil, these trees at the present time have attained an excellent growth, although 20% of them have been slightly damaged by rabbits.

After cutting the hemlock on the Log Job on Grand Island, it was decided that this cutover area should be reforested. In the spring of 1917, 50,000 White Pine - three years old, 35,000 Norway Pine - three years old, 15,000 Scotch Pine - three years old, were planted. In the spring of 1918, 20,000 White Pine - three years old were planted. In the spring of 1919, 40,000 White Pine - three years old, 50,000 Norway Pine - three years old, 50,000 Spruce - three years old, 50,000 Douglas Fir - three years old, were planted. In the spring of 1920, 200,000 White Pine - three years old were planted. In the spring of 1921, 300,000 White Pine - three years old were planted. It was the intention this spring to plant about two or three hundred thousand trees but owing to the extreme dry spell and judging by our previous planting during the prolonged dry period, we decided that it is not feasible to expend any money at this time. In doing this planting no preparation was given to the soil. The method used was as follows: Each man was provided with a double-bitted axe with a thirty-inch handle. After striking the blade as deeply into the earth the axe was turned right and left leaving a triangular hole. The seedling was placed into the hole and tamped by foot pressure. Trees were planted thickly about three feet apart and species alternated as far as possible. One man planted, carrying two bunches or 200 trees in a moist sack thrown over his shoulder, and each man averaged about 1,000 trees

per day. The results of these plantings are as follows:

- 1917 - These trees did fairly well about 85% being now alive.
- 1918 - The trees planted this spring nearly all died owing to the extreme dry and hot weather. In fact about 60% died without even taking root. The dry spring did not affect the previous year's planting.
- 1919 - All trees planted this year did very well except the Douglas Fir which died.
- 1920 - A very hot and dry spring and about 35% of this year's planting died.
- 1921 - These trees did very well and about 90% are now alive.

The total number of trees planted in this area is 720,000 at a total cost of \$5,949.15 making the average cost per 1,000 trees planted, \$8.26. The comparatively poor showing of the Norway Pine on this area is probably due to the fact that the trees are still young and have not begun to make rapid growth. I think, however, when these trees attain a growth of ten years or more you will find that they will give the best return upon the investment made. The soil conditions on Grand Island are distinctly favorable to White Pine, however, but I do not think that the White Pine will continue to surpass the Norway Pine. It has been my experience in examining various tracts of White Pine regeneration that when the trees attain an age of 35 or 40 years and even older, they hold their limbs to a much greater extent than the Norway and make what we commonly call "ladder Pine" which does not cut out into very good lumber. We had a recent experience in cutting some of this class of timber when we cut the Snell Job near Little Lake. We found that it was only possible to get one clear log from each of the Pine trees upon this tract although they had attained matured growth.

Respectfully Submitted,

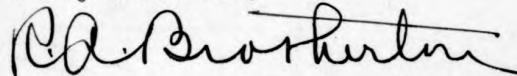

Engineer in Charge.

RAB:LED

THE CLEVELAND-CLIFFS IRON COMPANY

LAND DEPARTMENT

STATEMENT OF FOREST FIRES OCCURRING DURING THE YEAR 1925 AS REPORTED BY THE VARIOUS DEPARTMENTS OF THE CLEVELAND-CLIFFS IRON CO.

REPORT NO.	DATE 1925	LOCATION	OWNER OF LAND CO. LAND SOLD OTHER PARTIES	SPARKS FROM ENGINE	CAUSE FARMERS BURNING BRUSH	MISCL.	PREVENTABLE OR NOT	ATTRIBUTABLE TO PRACTICES OF COMPANY OUTSIDE PARTIES	QUANTITIES & KINDS	LOSS LAND LERG. RY. DEPT. DEPT. DEPT.	COST TO PUT OUT FIRES	LOSS VALUE TO OUTSIDE PARTIES
1	April 15	Just east of Water Works Curve		1			Yes		Dry grass, brush, etc.		2 hrs. labor	
2	April 16	100 ft. SW of Bridge 68-69		1			"		Do.		1 " "	
3	April 19	3/4 mile east of Van Meer			1		"	1	Culvert and 40 ft. of snow fence	1	8 " "	
4	April 24	1 mi. south of Princeton and north of Gwinn				unknown	"		Dry grass, brush, etc.		1 " "	
5	April 24	500 ft. east of Birch Siding			1		"	1	Do.		8 " "	
6	April 28	East end of yard limit of Marriam					"		"		5 " "	
7	April 30	East end of Forestville Siding		1			"		"		22 " "	
8	May 2	At M.P. 6 out of Munising		1			"		"		5 " "	
9	" 2	At the yard limit board out of Munising		1			"		"		22 " "	
10	" 2	At the east end siding at Vail		1			"		"		4 " "	
11	" 1	1500 ft. west of Forestville Siding	1			unknown	"		"		9 " "	
12	" 3	1/4 mile west of Myron				west wind	"		"			
13	" 9	Barnum Swamp near Barnum Mine		1		unknown	"		"			
14	" 9	Long Siding - Big Bay		1			"		"		20 " "	
15	" 9	1320 ft. west of Doty		1			"		125 Usable Cull Ties @ \$.40 \$50.00	1	1 " "	
16	" 9	3/4 west of Chatham Station		1 or			"		Dry grass, brush, etc.		20 " "	
17	" 9	1 mile west of Chatham		1 or		cigarette	"		Do.		1 " "	
18	" 12	1/4 mile east of Dead River Siding		1			"		Wooden farm gate		5 " "	
19	" 12	North side of Barnum Siding	1	1			"		Dry grass, brush, etc.		1 " "	
20	" 12	50 ft. west of Whitesian Spur		1			"		15 fence posts		1 " "	
21	" 13	East side of Barnum Siding	1	1			"		Dry grass, brush, etc.		28 " "	
22	" 13	1/2 mile west of Antlers		1			"		Peat		60 " "	
23	" 13	Just west of M.P. 55		1			"		Dry grass, brush, etc.		2 1/2 " "	
24	" 14	1/2 mile west of Vail		1			"		Do.		5 1/2 " "	
25	" 15	1 1/2 miles east of Orr Siding		1 or		cigarette	"		"		12 " "	
26	" 15	At No. 2 switch on east end		1			"		"		12 " "	
27	" 15	At Orr Spur		1		unknown	"		Dry Jack Pine		12 " "	
28	" 15	At Addis - 1 1/2 miles west of Vail		1			"		Dry grass, brush, etc.		55 " "	
29	" 15	3/4 mile south of Orr		1			"		Do.		18 " "	
30	" 15	3/4 mile east of Orr	1	1			"		150 acres of green timber		30 " "	
31	" 15	One mile west of Tower		1			"		Rotten wood		18 " "	
32	" 18	South of west switch at Dead River		1		unknown	"		End of log		10 min.	
33	" 19	500 ft. east of Pinnas Crossing		1			"		Dry grass, brush, etc.		18 hrs.	
34	" 19	1 mile east of Coalwood Switch		1			"		Do.		12 " "	
35	" 19	At culvert No. 50-58		1 or			"		About 90 cross ties - \$72.00	1	25 " "	
36	" 19	Between ore dock track and main line		1		cigarette	"		Old tie pile & telegraph pole	1	15 " "	
37	" 27	At crusher		1			"		Dry grass, brush, etc.		16 1/2 " "	
38	" 26	3/4 miles west of Van Meer		1			"		Do.		12 " "	
39 1/2	" 30	3/4 miles east of Lakeswood		1			"		Do.		6 " "	
39	" 30	1/2 mile west of Munising Junction Siding		1		unknown	"		Jack Pine scorched		4 1/2 " "	
40	June 2	About 400 ft. west of Basel Switch		1			"		Dry grass, brush, etc.		2 1/2 " "	
41	" 2	1/2 mile east of Rumely		1			"		Dry grass		14 " "	
42	" 2	500 ft. east of Basel Switch		1			"		Dry grass, brush, etc.		1 " "	
43	" 2	2 miles south of Granot		1			"		Do.		17 1/2 " "	
44	May 30	South of Barnum Siding and main line		1		cigarette	"	1	"		15 " "	
45	June 2	1/4 mile east of Granot		1			"	1	Peat		15 " "	
46	" 25	3/4 mile west of Homier		1		prev. fire	"		Dry grass, brush, etc.		45 " "	
47	July 14	End of "Y", Big Bay		1			"		Do.		4 " "	
48	" 16	3 miles west of Birch		1		Camp fire	"	1	Rotten wood		6 " "	
49	" 29	1/2 mile west of Homier		1			"		Railroad Bridge		4 " "	
50	Aug. 6	3/4 mile west of Homier Crossing		1			"		Dry grass		4 " "	
51	" 6	3/4 miles west of Homier		1		prev. fire	"		Dry grass, brush, etc.		35 " "	
52	" 11			1		Do.	"		Dry brush		129 " "	
53	" 16	At Ames Curve 2 miles from Juniper Spur		1			"		Wood piles		24 " "	
54	" 24	1/2 mile west of Birch		1		unknown	"		Dry grass, brush, etc.		14 " "	
55	" 25	West of Chatham side track		1			"		Dry grass		2 1/2 " "	
56	" 24	1 mile east of No. 2 Siding - Little Lake		1			"		Do.		10 " "	
57	" 23	Metaer Spur		1		prev. fire	"		"		48 " "	
58	" 27	1/2 mile west of Dorsey Spur		1		unknown	"		Dry grass, brush, etc.		6 " "	
59	" 25	1/2 mile west of Freedom No. 1		1		cigarette	"	1	Do.		76 " "	
60	" 29	North side track at Barnum Switch		1			"		"		48 " "	
61	" 22	Edmonds Switch		1			"		Fence posts		192 " "	
62	Sept. 16	Coalwood Siding		1			"		Dry grass, brush, etc.		1 " "	
63	" 16	1/4 mile west of Vail		1		unknown	"		Do.		1/2 " "	
	May 31	- June 4 - Sections 11, 12, 13, 14, 15, 22, 23, 26, 27, and 28-47-23.					"		Dry grass and rotten logs		4 " "	
									Softwood logs - 1,089,639 ft. \$14,718.06	1	\$266.98 * "	
									Hardwood logs - 9,345 " 143.23		45 hrs. labor	
									Ties - 9,589 pcs. 3,896.58			
									T. & S. cuts - 878 " 260.47			
									Posts - 2,256 " 377.07			
									Pulpwood - 19,524 " 2,628.94			
									5' Lagging - 21,565 ods. 115.26			
									Cedar Poles - 392 pcs. 822.98			
									Mine Stulls - 583 pcs. 320.56			
									Railroads, steel, etc. 2,812.44			
									\$26,100.68			

THE CLEVELAND-CLIFFS IRON COMPANY

LAND DEPARTMENT

STATEMENT OF FOREST FIRES OCCURRING DURING THE YEAR 1925 AS REPORTED BY THE VARIOUS DEPARTMENTS OF THE CLEVELAND-CLIFFS IRON CO. (CONTINUED)

REPORT NO.	DATE 1925	LOCATION	OWNER OF LAND		SPARKS FROM ENGINE	CAUSE FARMER'S BURNING BRUSH	MISCL.	PREVENTABLE OR NOT	ATTRIBUTABLE		QUANTITIES & KINDS	LOSS			LOSS VALUE TO OUTSIDE PARTIES	
			CO. LAND SOLD	OTHER PARTIES					TO PRACTICES OF COMPANY	TO PRACTICES OF OUTSIDE PARTIES		LAND DEPT.	LBRG. DEPT.	RY. DEPT.		COST TO PUT OUT FIRES
May 28 - May 31 -	SE $\frac{1}{4}$ of NW $\frac{1}{4}$, NE $\frac{1}{4}$ of NW $\frac{1}{4}$, NW $\frac{1}{4}$ of NW $\frac{1}{4}$, SW $\frac{1}{4}$ of NW $\frac{1}{4}$, NW $\frac{1}{4}$ of NE $\frac{1}{4}$, SW $\frac{1}{4}$ of NE $\frac{1}{4}$, Sec. 30-45-19. Practically entire Sec. 19-45-19, & S $\frac{1}{2}$ of S $\frac{1}{2}$, Sec. 18-45-19.	1									Timber, grass, and brush				\$21.40 (1) 20 hrs. labor	
May 14 - May 16 -	NE $\frac{1}{4}$ of SW $\frac{1}{4}$ & SE $\frac{1}{4}$ of NW $\frac{1}{4}$, Section 14-46-21.	1			1		yes				Dry brush				44 hrs. labor \$180.54 (2)	
May 15 - May 18 -	Sections 1, 2, 3, 10, 11, 12, 14 & 15-44-19, and Sections 22, 23, 26, 27, 34 & 35-45-19.	1					unknown				Chemical Logs 8,200 ft. \$ 95.80 Softwood Logs 113,733 " 1,268.46 Mine Stalls 118,000 " 1,316.05 Cedar Poles 256 pcs. 485.94 T & S Cuts 1,081 " 242.14 Spruce Pulpwood 731 " 98.68 Balsam Pulpwood 195 " 26.32 Cedar Posts 4,167 " 455.29 Hemlock Bark 10 cds. 87.27 Ham. & Tam. Ties 288 pcs. 110.59 Logging Sleighs 3 31.22 \$4,219.88					\$334.57 (3)
May 12 - May 16 -	NW $\frac{1}{4}$ of SE $\frac{1}{4}$ & SW $\frac{1}{4}$ of SE $\frac{1}{4}$, Section 24-46-21.	1					unknown				Leaves & underbrush mostly				195 hrs. labor \$55.91 (4)	
May 1 - May 2 -	SW $\frac{1}{4}$ of SE $\frac{1}{4}$ & SE $\frac{1}{4}$ of SW $\frac{1}{4}$, Section 13-46-21, and NW $\frac{1}{4}$ of NE $\frac{1}{4}$ & NE $\frac{1}{4}$ of NW $\frac{1}{4}$, Section 24-46-21.	1					unknown				Dry leaves				\$12.00 (5) 40 hrs. labor	
June 8 - June 10 -	N $\frac{1}{2}$ of E $\frac{1}{2}$, Sec. 23-46-21, & S $\frac{1}{2}$ of S $\frac{1}{2}$, Sec. 14-46-21.	1					cigarette		1		Chemical logs 9,524 ft. \$ 33.78 Cordwood 100 cds. 253.60 \$297.58				\$102.43 (6) 335 hrs. labor	
			* \$237.13 paid by the State.													
			(1) \$ 11.20 " " " "													
			(2) \$172.40 " " " "													
			(3) \$295.53 " " " "													
			(4) \$ 55.33 " " " "													
			(5) \$ 12.00 " " " "													
			(6) \$100.67 " " " "													

ARCTIC IRON COMPANY

LAND DEPARTMENT

LAND ACREAGE

DECEMBER 31, 1925

TOWN	RANGE	UNPLATTED LANDS		PLATTED LANDS	TOTAL	MINERALS RESERVED IN FARM LAND SALES
		FEE	MINERALS	MINERALS		
47	25	32.12			32.12	
47	26	824.43	4.43	88.03	916.89	78.99
48	26	148.00	33.55	15.50	197.05	
TOTAL		1004.55	37.98	103.53	1146.06	78.99

CAJ:CN:2.
2/1/26.

A M E R I C A N I R O N M I N I N G C O M P A N Y

LAND DEPARTMENT

LAND ACREAGE

DECEMBER 31, 1925

TOWN	RANGE	UNPLATTED LANDS		
		FEE	MINERALS	TOTAL
47	31	515.98	38.42	554.40
48	31	1985.72	276.38	2262.10
TOTAL		2501.70	314.80	2816.50

CAJ:CN:2.
2/1/26.

BUNKER HILL MINING COMPANY

LAND DEPARTMENT

LAND ACREAGE

DECEMBER 31, 1925

TOWN	RANGE	UNPLATTED LANDS		
		FEE	MINERALS	TOTAL
47	26	43.10	10.20	53.30

CAJ:CN:2.
2/1/26.

